

DIMENSIONS

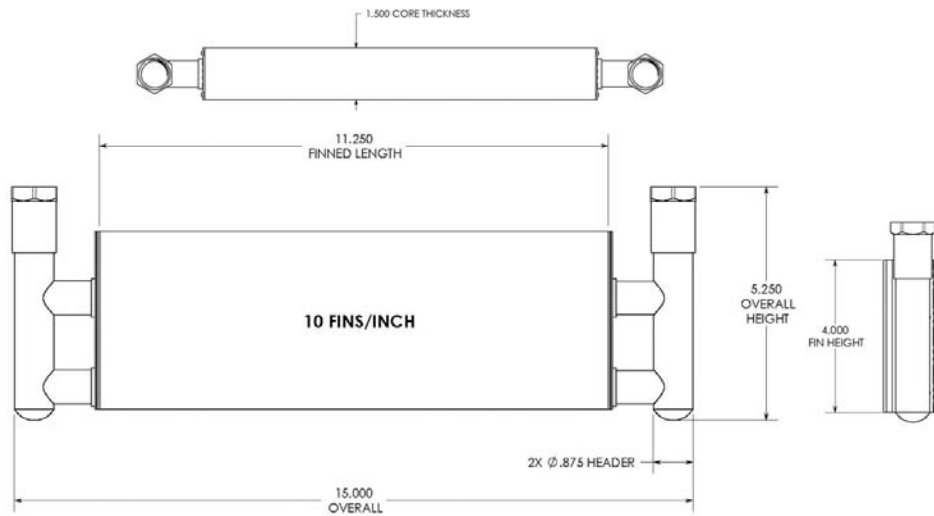

APPEARANCE

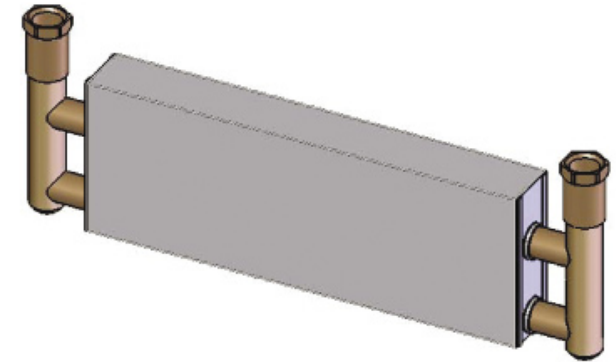

SPECIFICATIONS

Flow Range (GPM):1 - 8
 Heat Rejection Range (BTU/Hr):
 4,500 - 6,100
 Fitting Size:.....1/2" FPT
Material
 Copper Tube:.....CDA122
 Inner Tube:Al-3003
 Inner Fin:Al - 1100
 Outer Fin:Al - 1100
 Fitting:.....Copper
Cooler Weight (lbs.)
 Total Weight :.....2 lbs.

PERFORMANCE

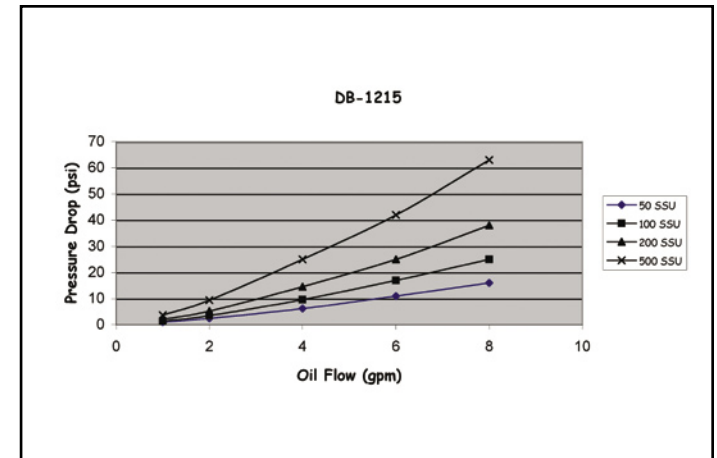
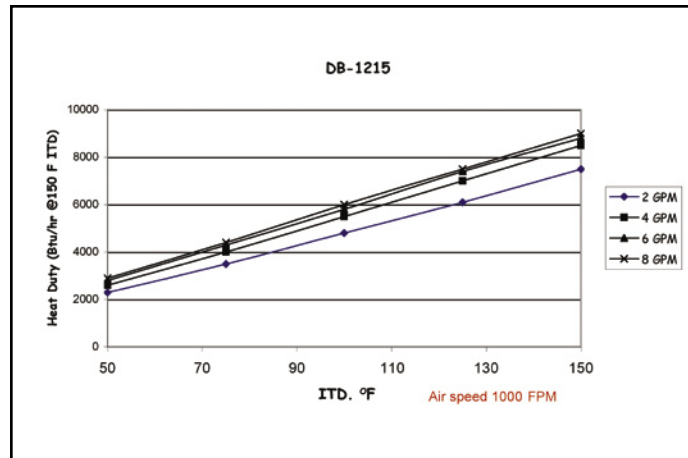

DIMENSIONS

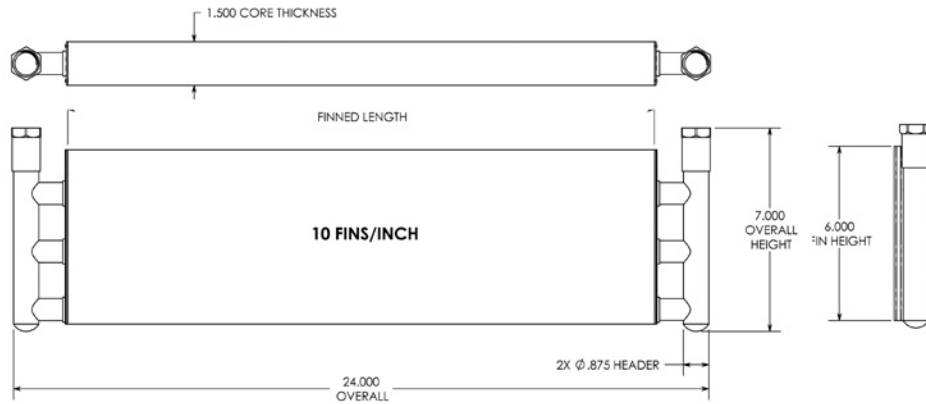

APPEARANCE

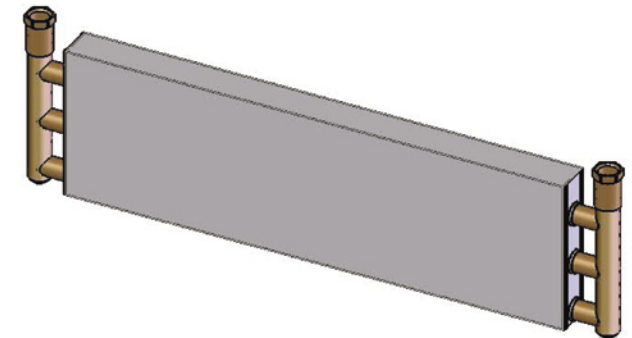

SPECIFICATIONS

Flow Range (GPM):2 - 12
 Heat Rejection Range (BTU/Hr):
 11,200 - 16,400
 Fitting Size:.....1/2" FPT
Material
 Copper Tube:.....CDA122
 Inner Tube:Al-3003
 Inner Fin:Al - 1100
 Outer Fin:Al - 1100
 Fitting:.....Copper
Cooler Weight (lbs.)
 Total Weight :.....3.75 lbs.

PERFORMANCE

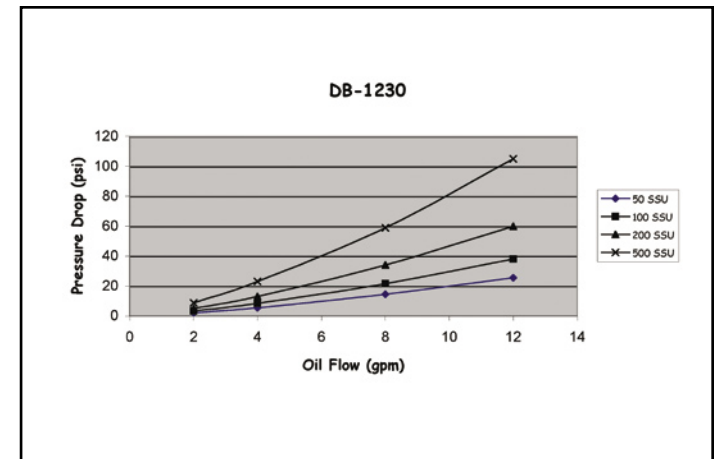
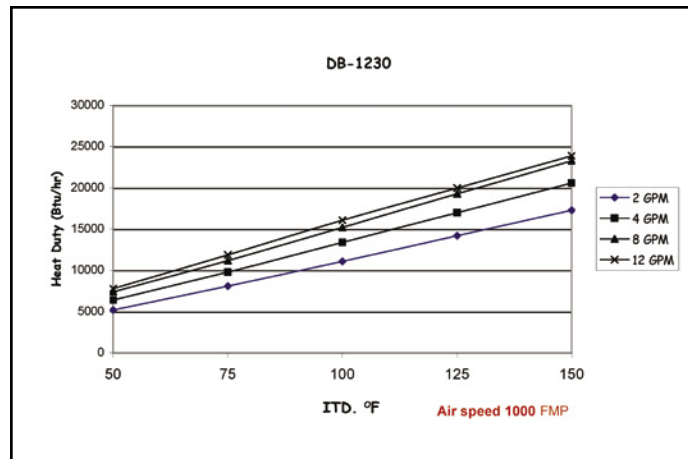

DIMENSIONS

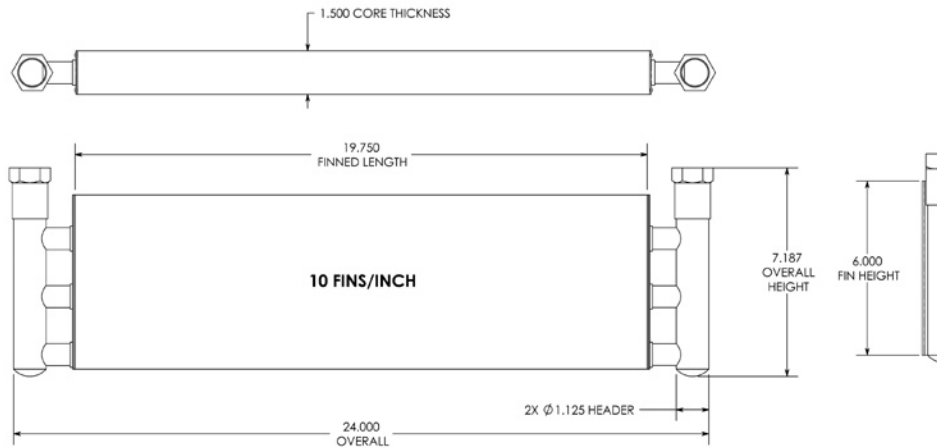

APPEARANCE

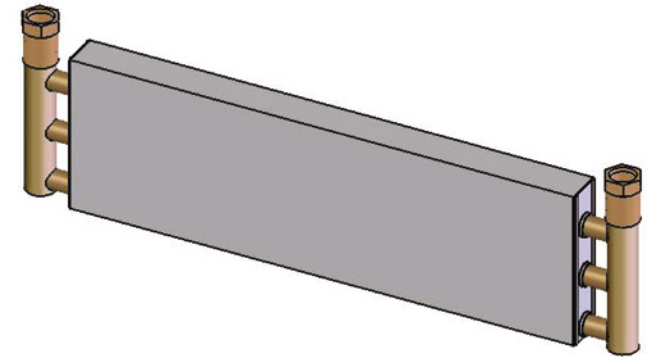

SPECIFICATIONS

Flow Range (GPM):2 - 12
 Heat Rejection Range (BTU/Hr):
 11,200 - 16,400
 Fitting Size:.....3/4" FPT
Material
 Copper Tube:.....CDA122
 Inner Tube:Al-3003
 Inner Fin:Al - 1100
 Outer Fin:Al - 1100
 Fitting:.....Copper
Cooler Weight (lbs.)
 Total Weight :.....4 lbs.

PERFORMANCE

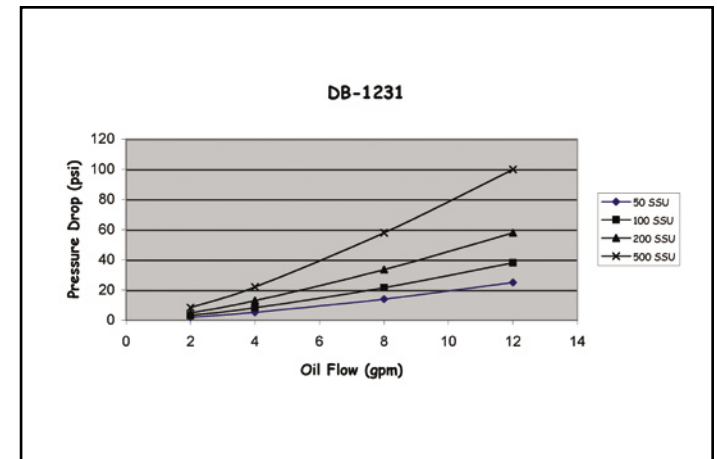
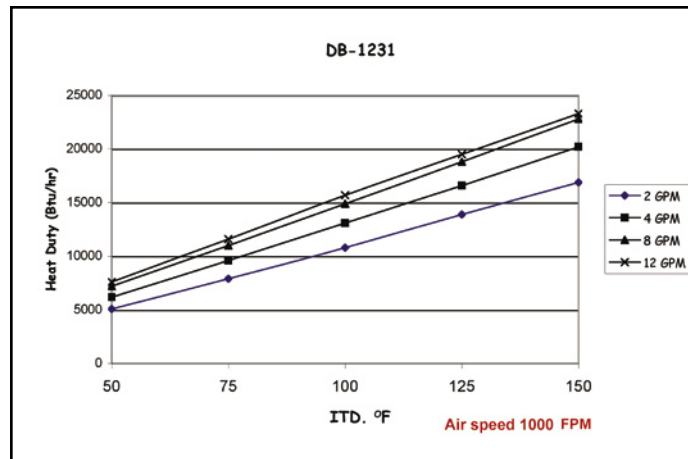

DIMENSIONS

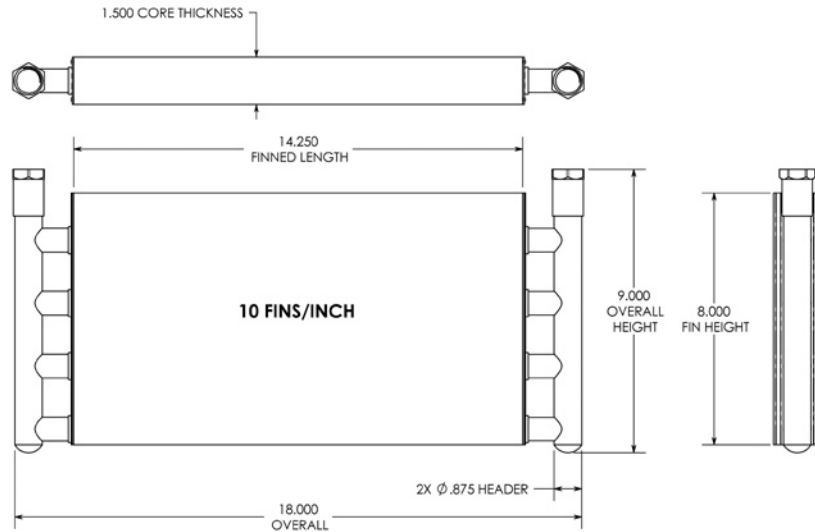

APPEARANCE

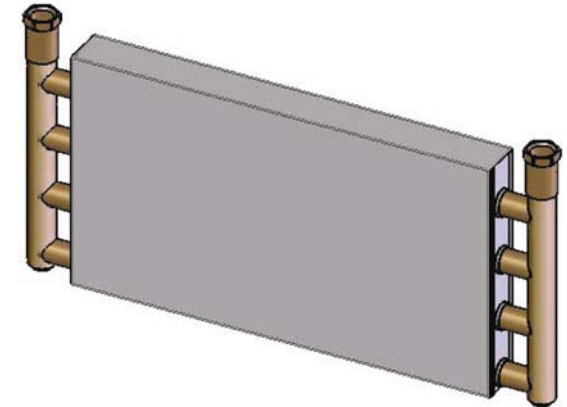

SPECIFICATIONS

Flow Range (GPM):2 - 12
 Heat Rejection Range (BTU/Hr):
 10,300 - 14,000
 Fitting Size:.....1/2" FPT

Material

Copper Tube:.....CDA122
 Inner Tube:Al-3003
 Inner Fin:Al - 1100
 Outer Fin:Al - 1100
 Fitting:.....Copper

Cooler Weight (lbs.)

Total Weight :.....4 lbs.

PERFORMANCE

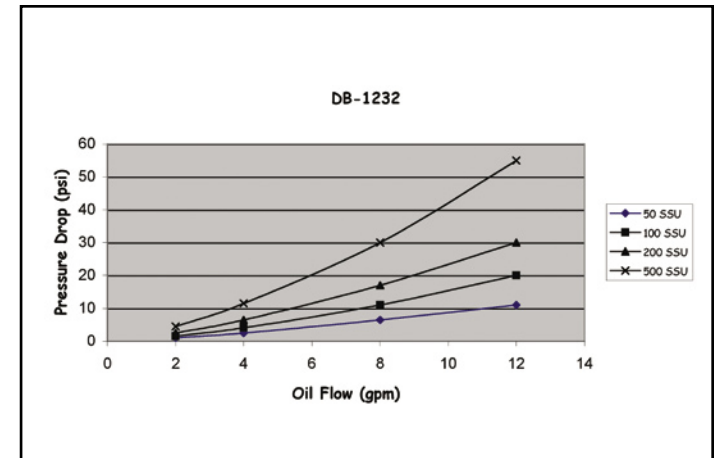
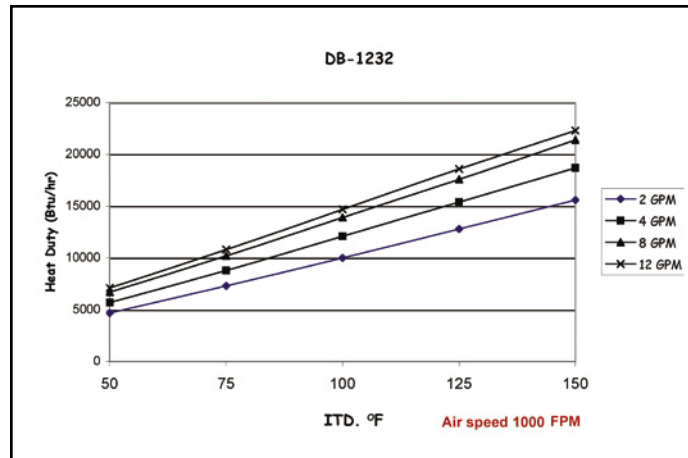

DIMENSIONS

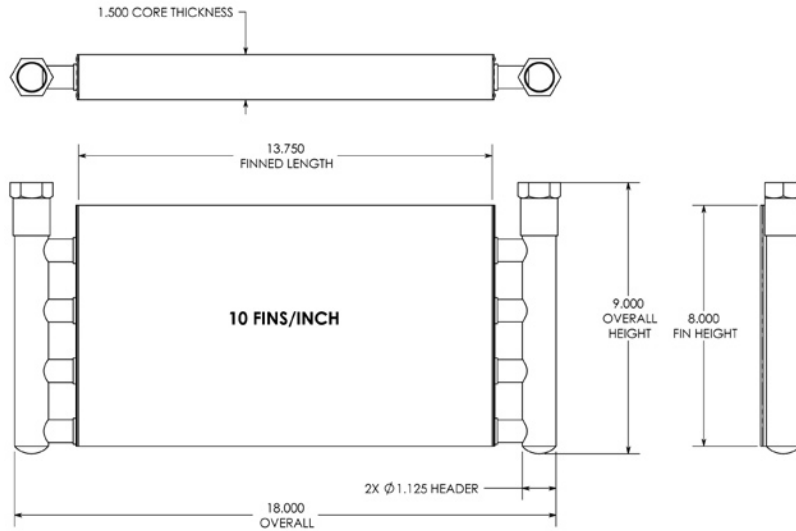

APPEARANCE

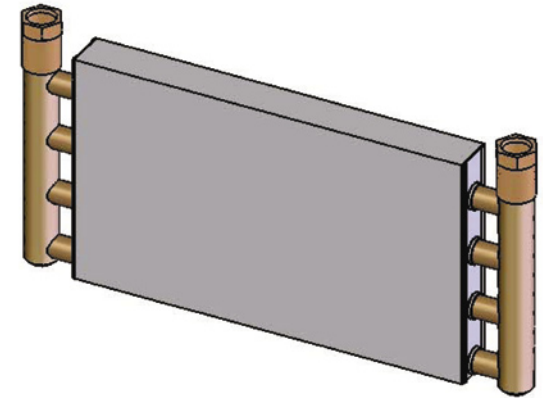

SPECIFICATIONS

Flow Range (GPM):2 - 16
 Heat Rejection Range (BTU/Hr):
 10,000 - 14,200
 Fitting Size:.....3/4" FPT

Material
 Copper Tube:.....CDA122
 Inner Tube:Al-3003
 Inner Fin:Al - 1100
 Outer Fin:Al - 1100
 Fitting:.....Copper

Cooler Weight (lbs.)
 Total Weight :.....4 lbs.

PERFORMANCE

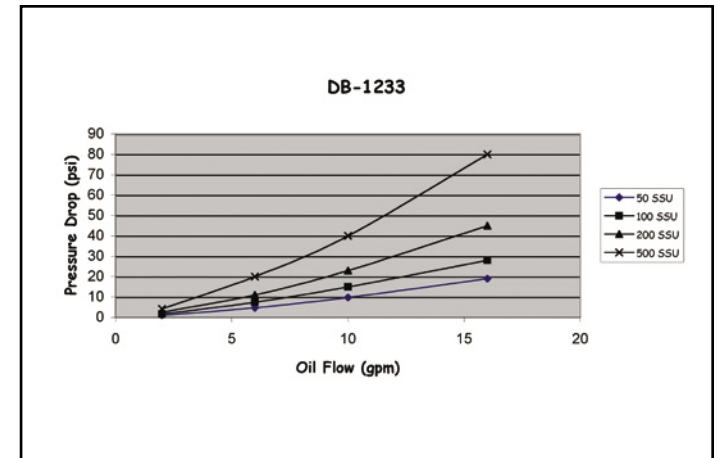
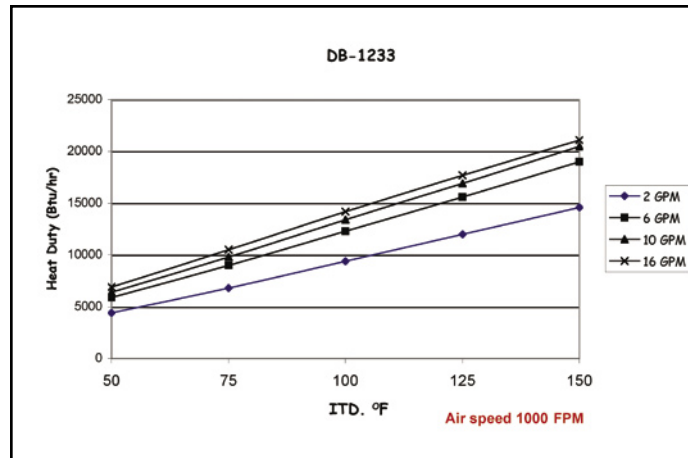

DIMENSIONS

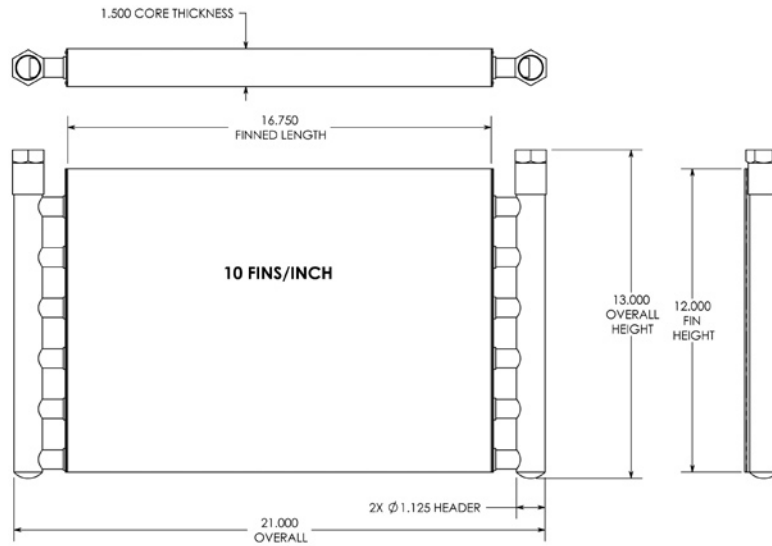

APPEARANCE

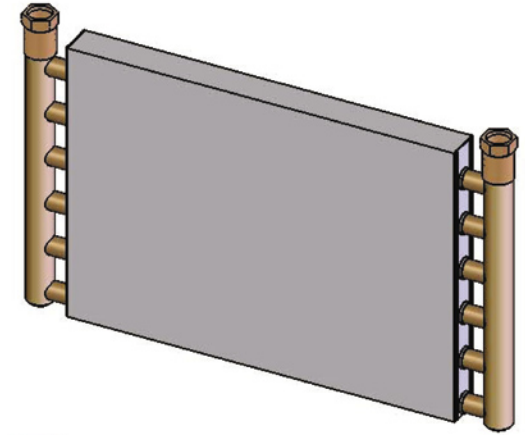

SPECIFICATIONS

Flow Range (GPM):4 - 20
 Heat Rejection Range (BTU/Hr):
 18,250 - 25,000
 Fitting Size:.....3/4" FPT
Material
 Copper Tube:.....CDA122
 Inner Tube:Al-3003
 Inner Fin:Al - 1100
 Outer Fin:Al - 1100
 Fitting:.....Copper
Cooler Weight (lbs.)
 Total Weight :.....6.75 lbs.

PERFORMANCE

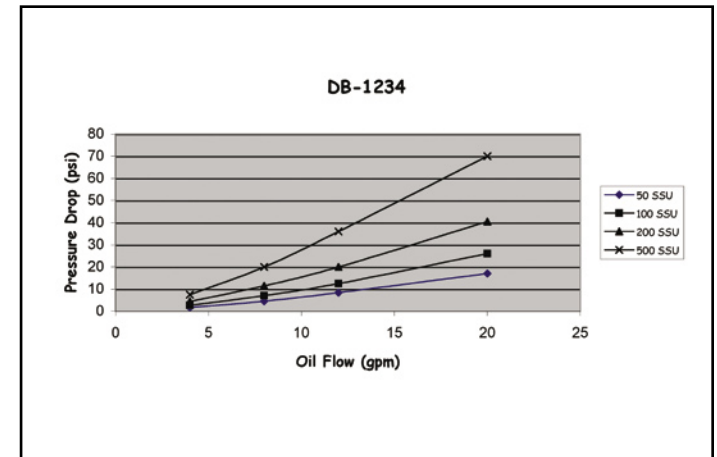
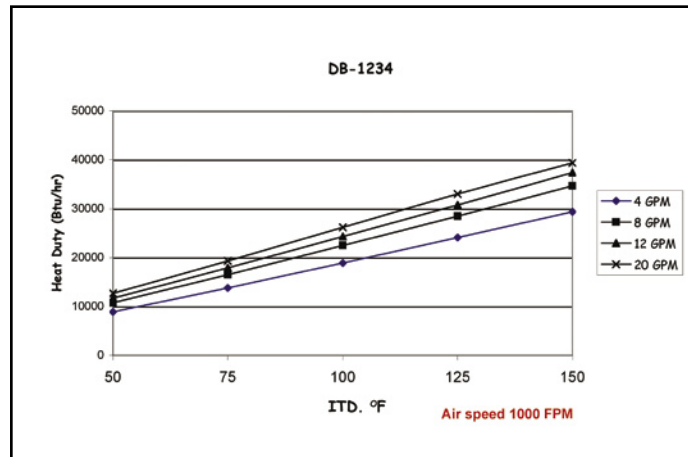

DIMENSIONS

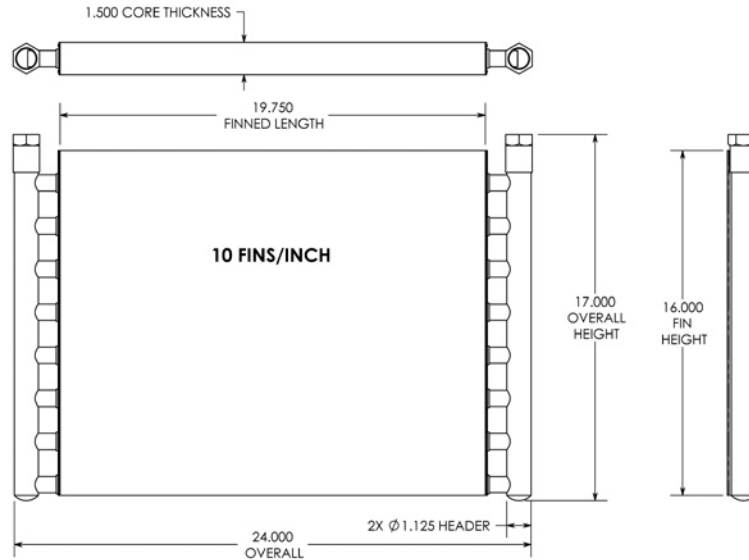

APPEARANCE

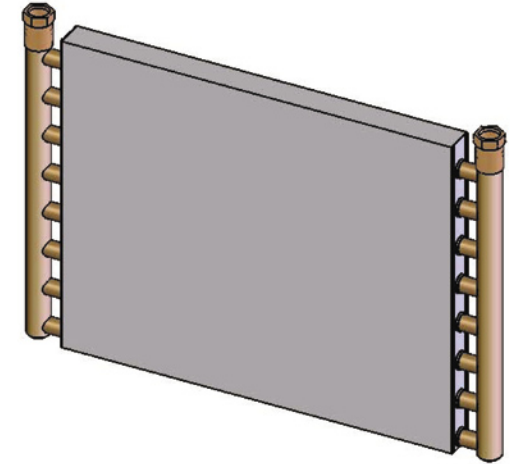

SPECIFICATIONS

Flow Range (GPM):4 - 20
 Heat Rejection Range (BTU/Hr):
 26,100 - 36,600
 Fitting Size:.....3/4" FPT

Material

Copper Tube:.....CDA122
 Inner Tube:Al-3003
 Inner Fin:Al - 1100
 Outer Fin:Al - 1100
 Fitting:.....Copper

Cooler Weight (lbs.)

Total Weight :.....9.75 lbs.

PERFORMANCE

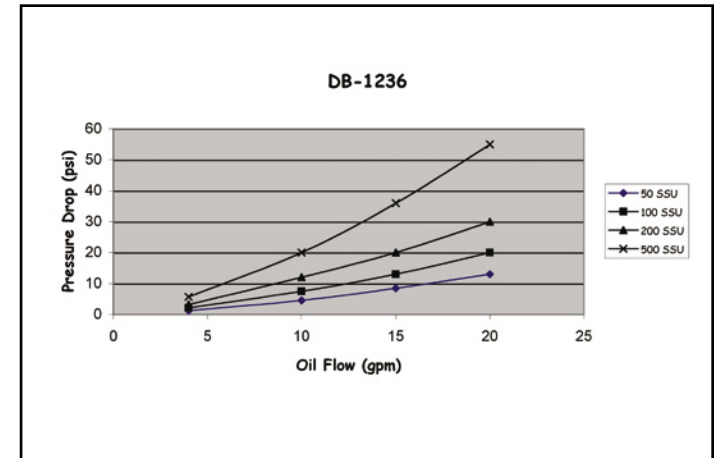
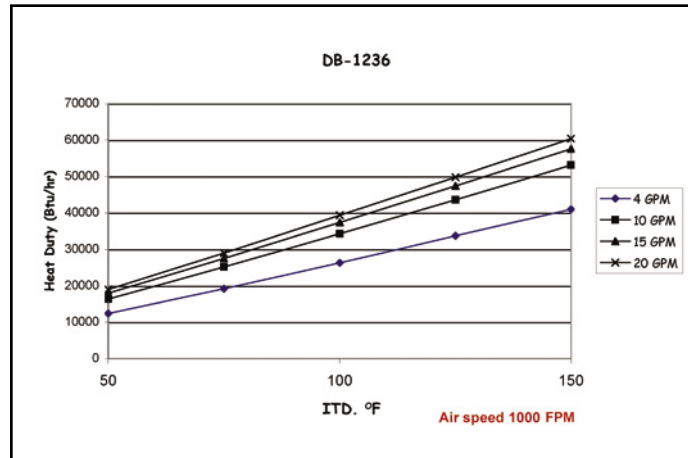

DIMENSIONS

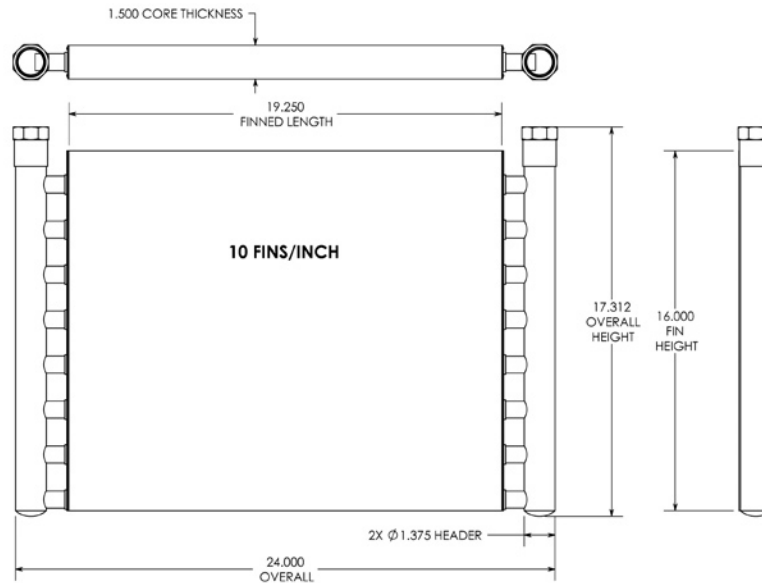

APPEARANCE

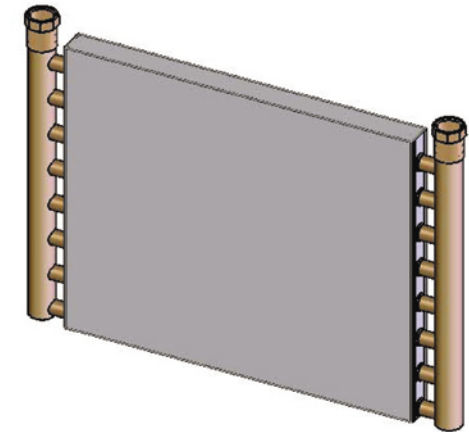

SPECIFICATIONS

Flow Range (GPM):4 - 26
 Heat Rejection Range (BTU/Hr):
 25,500 - 37,700
 Fitting Size:.....1" FPT
Material
 Copper Tube:.....CDA122
 Inner Tube:Al-3003
 Inner Fin:Al - 1100
 Outer Fin:Al - 1100
 Fitting:.....Copper
Cooler Weight (lbs.)
 Total Weight :.....10.5 lbs.

PERFORMANCE

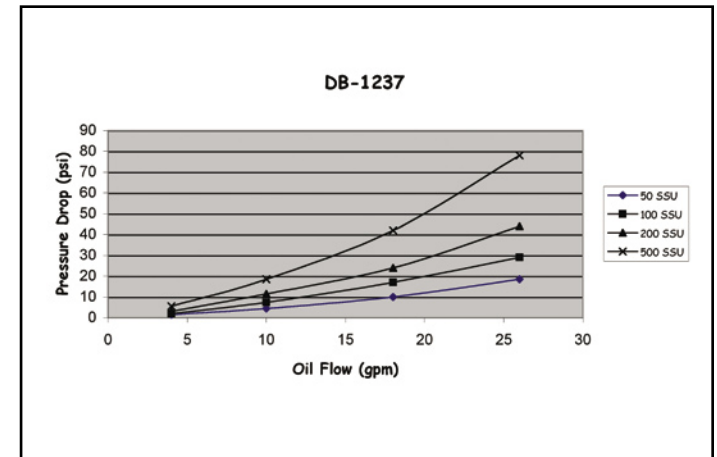
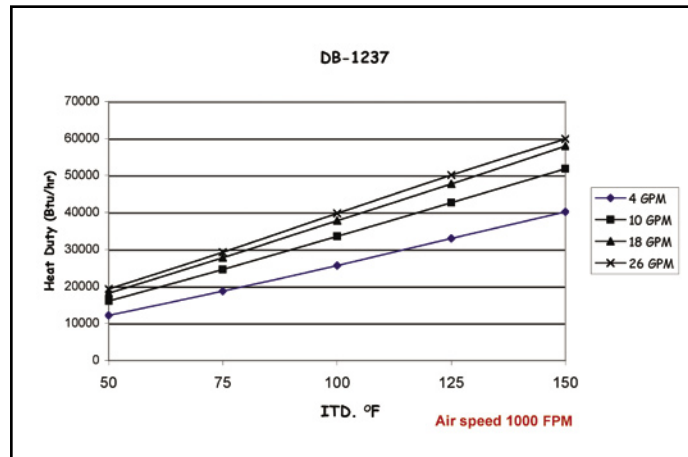

DIMENSIONS

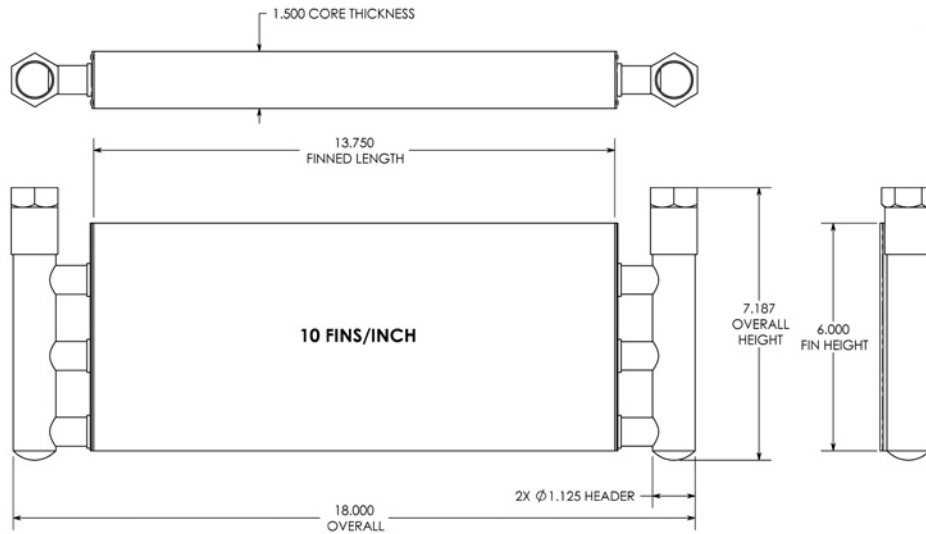

APPEARANCE

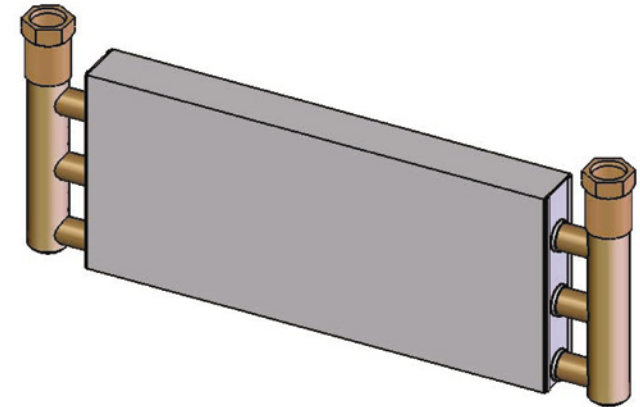

SPECIFICATIONS

Flow Range (GPM):2 - 12
 Heat Rejection Range (BTU/Hr):
 8,400 - 11,200
 Fitting Size:.....3/4" FPT
Material
 Copper Tube:.....CDA122
 Inner Tube:Al-3003
 Inner Fin:Al - 1100
 Outer Fin:Al - 1100
 Fitting:.....Brass Or
 Copper
Cooler Weight (lbs.)
 Total Weight :.....3 lbs.

PERFORMANCE

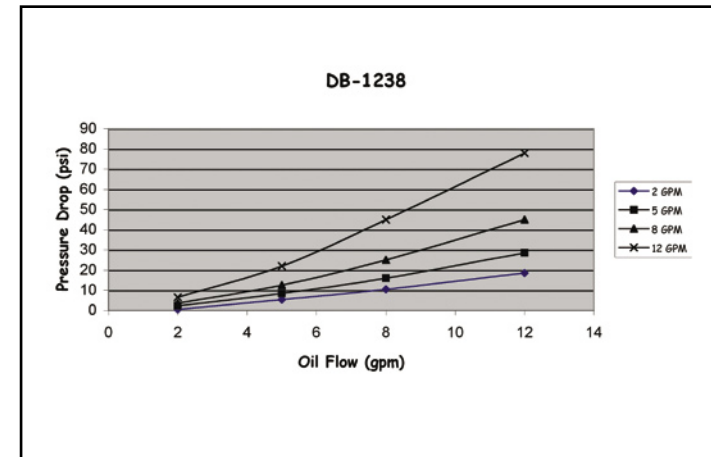
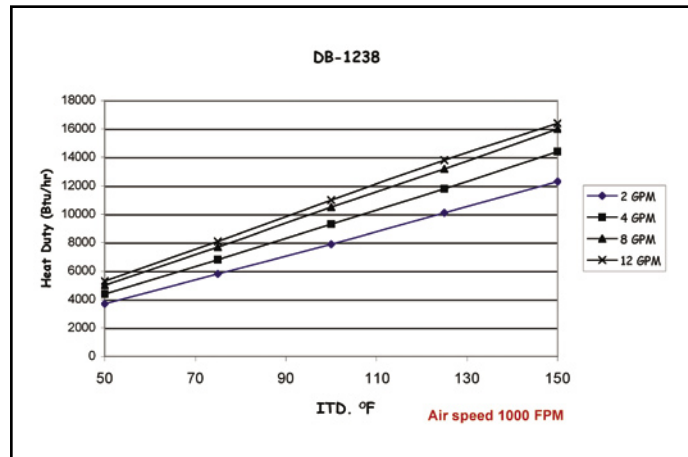

DIMENSIONS

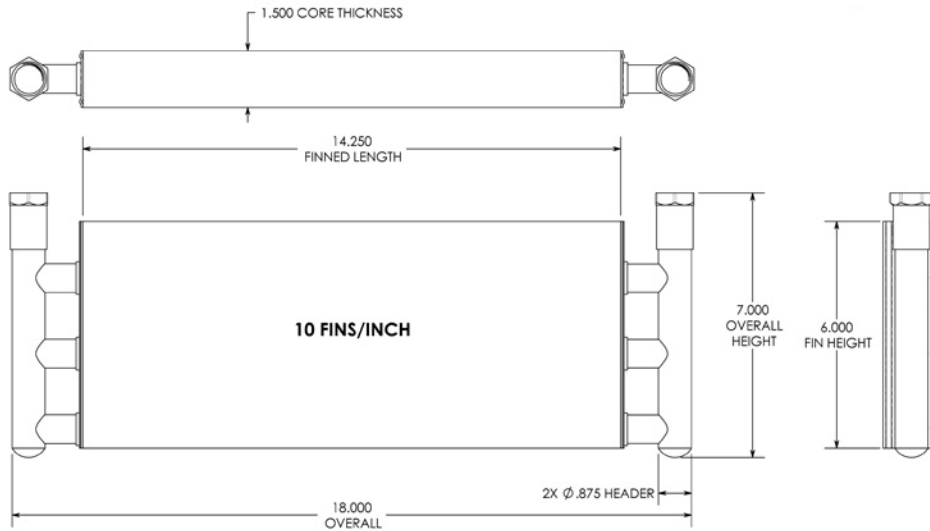

APPEARANCE

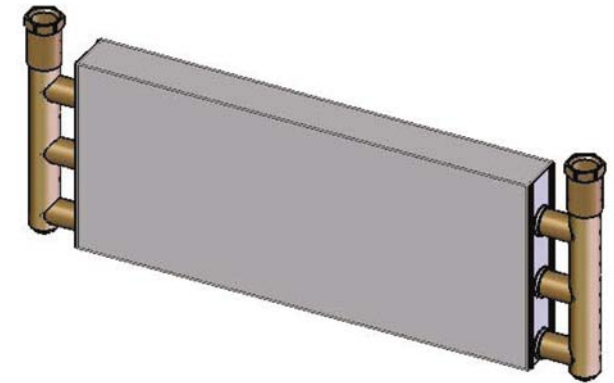

SPECIFICATIONS

Flow Range (GPM):2 - 12
 Heat Rejection Range (BTU/Hr):
 8,600 - 11,600
 Fitting Size:.....1/2" FPT

Material
 Copper Tube:.....CDA122
 Inner Tube:Al-3003
 Inner Fin:Al - 1100
 Outer Fin:Al - 1100
 Fitting:.....Copper

Unit Weight (lbs.)
Cooler Weight (lbs.)
 Total Weight :.....3 lbs.

PERFORMANCE

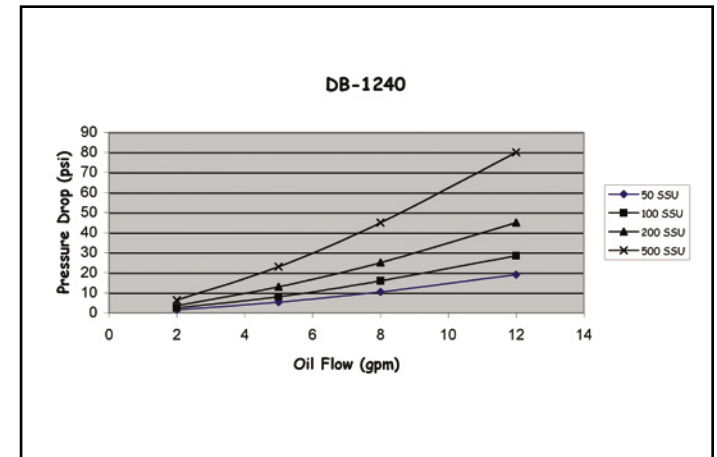
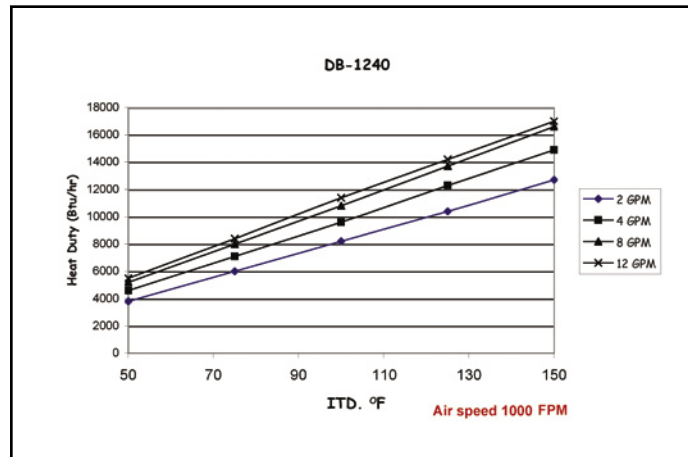

DIMENSIONS

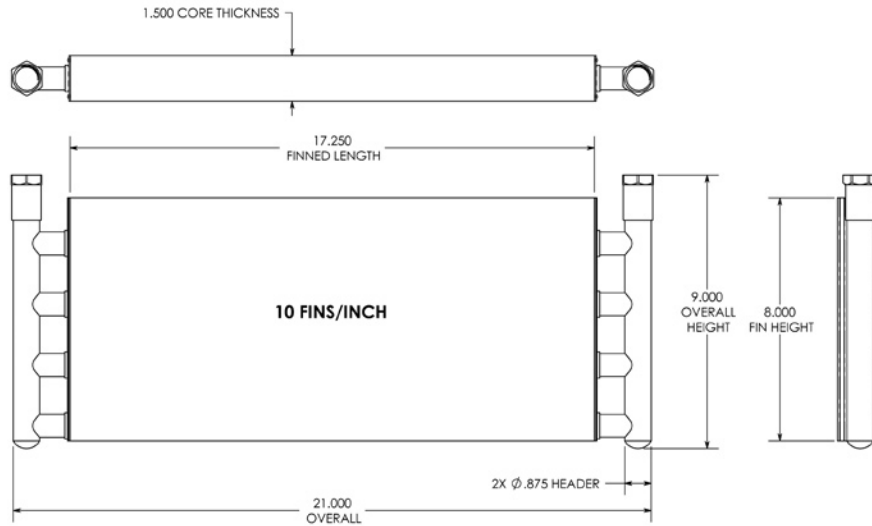

APPEARANCE

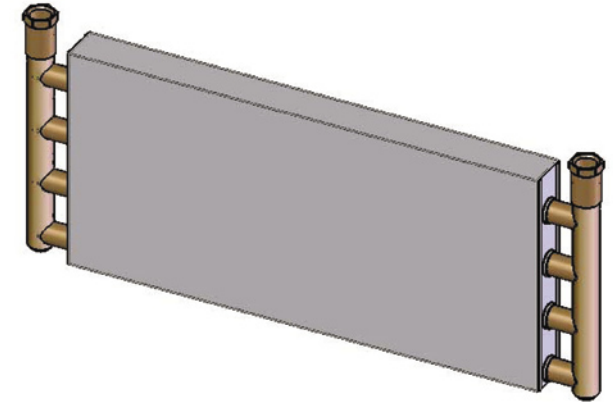

SPECIFICATIONS

Flow Range (GPM):2 - 12
 Heat Rejection Range (BTU/Hr):
 12,400 - 17,600
 Fitting Size:.....1/2" FPT
Material
 Copper Tube:.....CDA122
 Inner Tube:Al-3003
 Inner Fin:Al - 1100
 Outer Fin:Al - 1100
 Fitting:.....Copper
Cooler Weight (lbs.)
 Total Weight :.....4 lbs.

PERFORMANCE

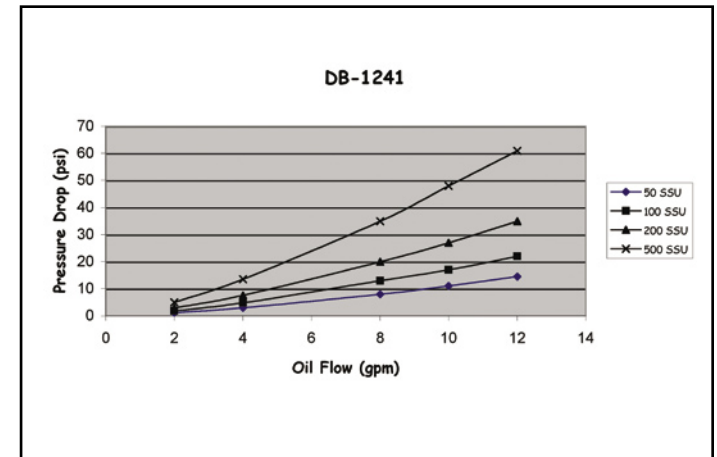
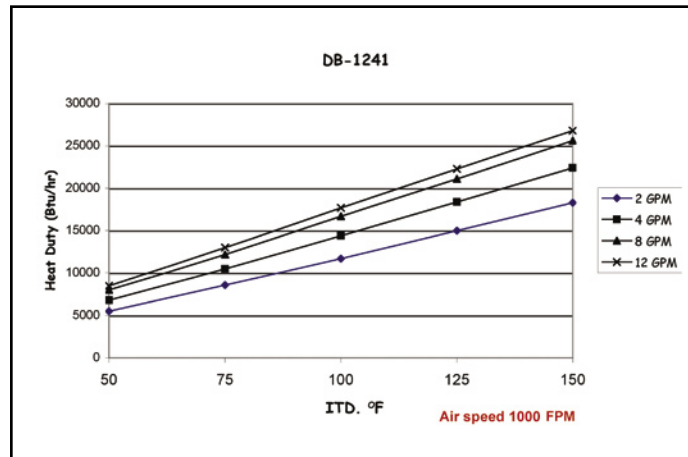

DIMENSIONS

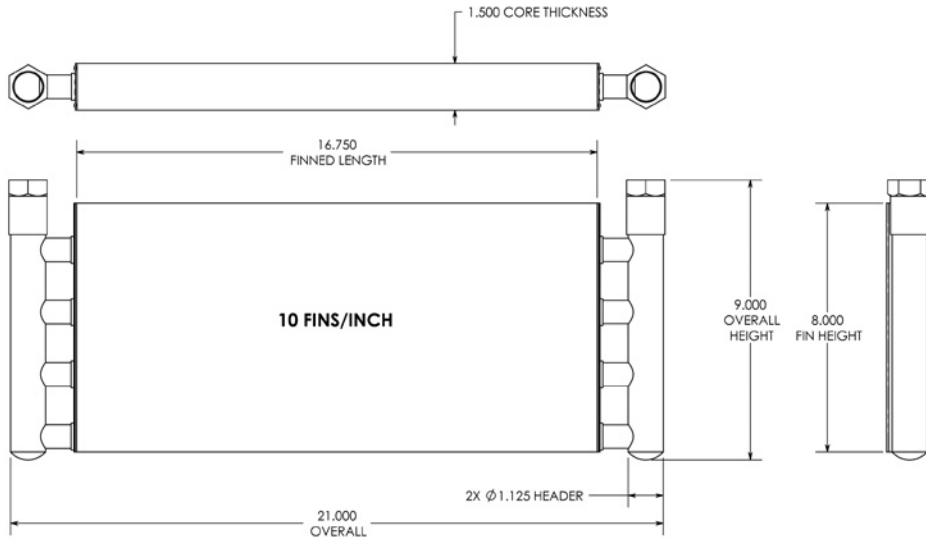

APPEARANCE

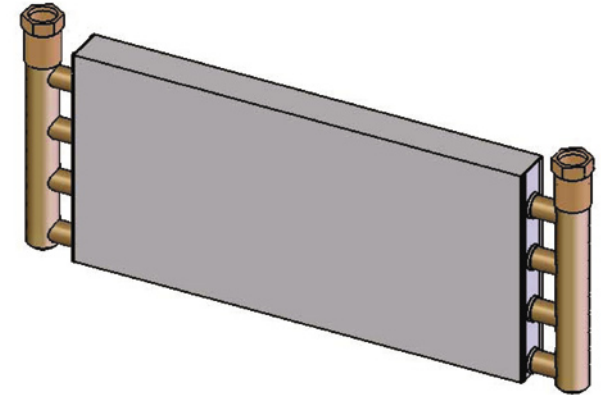

SPECIFICATIONS

Flow Range (GPM):2 - 16
 Heat Rejection Range (BTU/Hr):
 12,100 - 18,000
 Fitting Size:.....3/4" FPT
Material
 Copper Tube:.....CDA122
 Inner Tube:Al-3003
 Inner Fin:Al - 1100
 Outer Fin:Al - 1100
 Fitting:.....Copper
Cooler Weight (lbs.)
 Total Weight :.....4.5 lbs.

PERFORMANCE

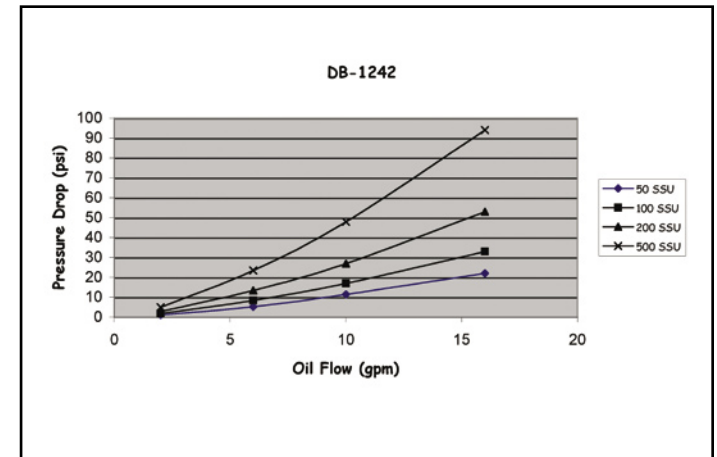
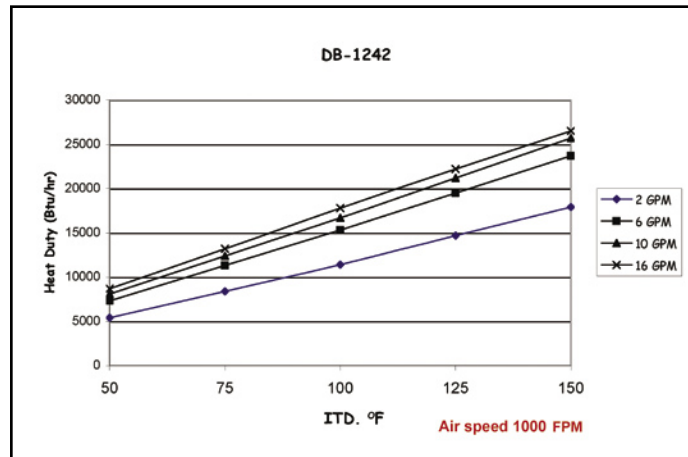

DIMENSIONS

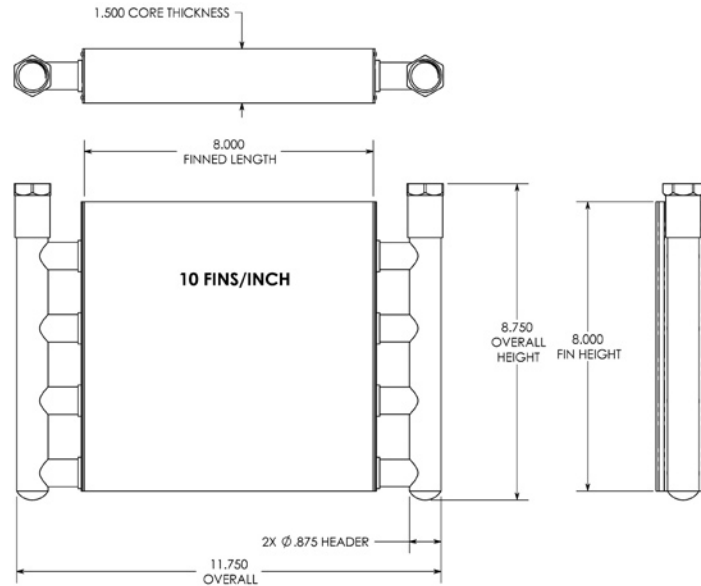

APPEARANCE

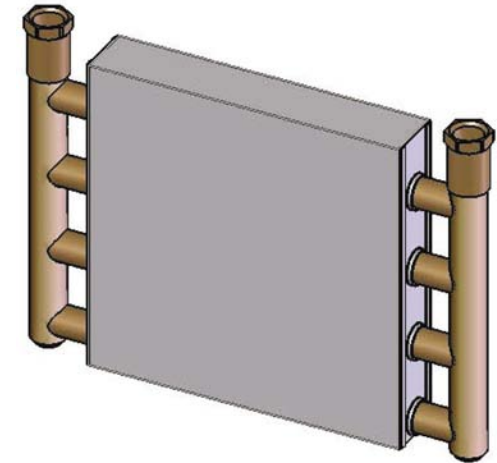

SPECIFICATIONS

Flow Range (GPM):2 - 12
 Heat Rejection Range (BTU/Hr):
 6,800 - 8,110
 Fitting Size:.....1/2" FPT

Material

Copper Tube:.....CDA122
 Inner Tube:Al-3003
 Inner Fin:Al - 1100
 Outer Fin:Al - 1100
 Fitting:.....Copper

Cooler Weight (lbs.)

Total Weight :.....3 lbs.

PERFORMANCE

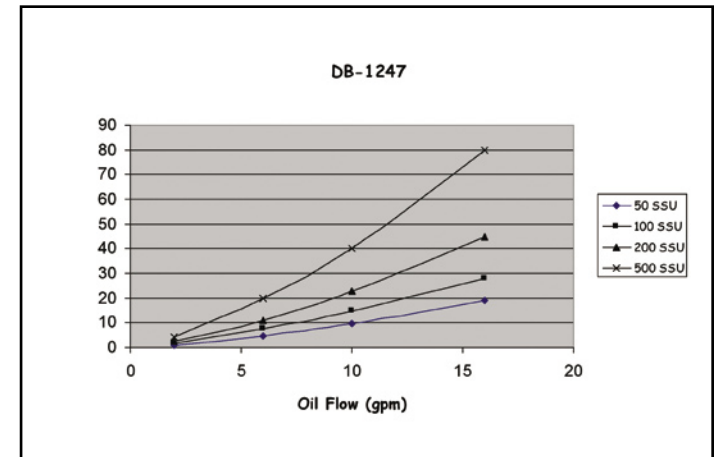
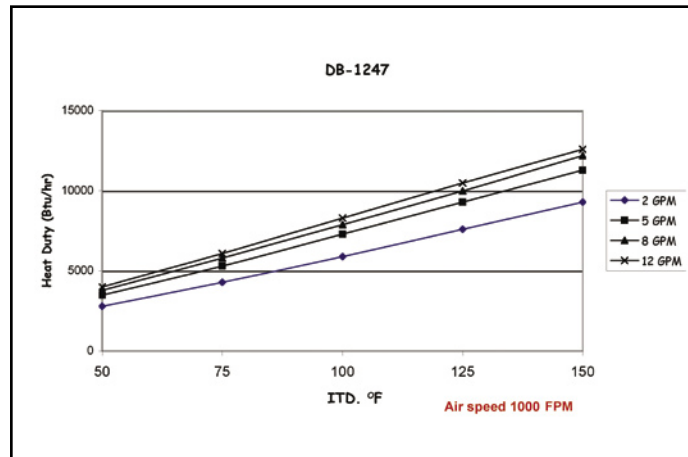

DIMENSIONS

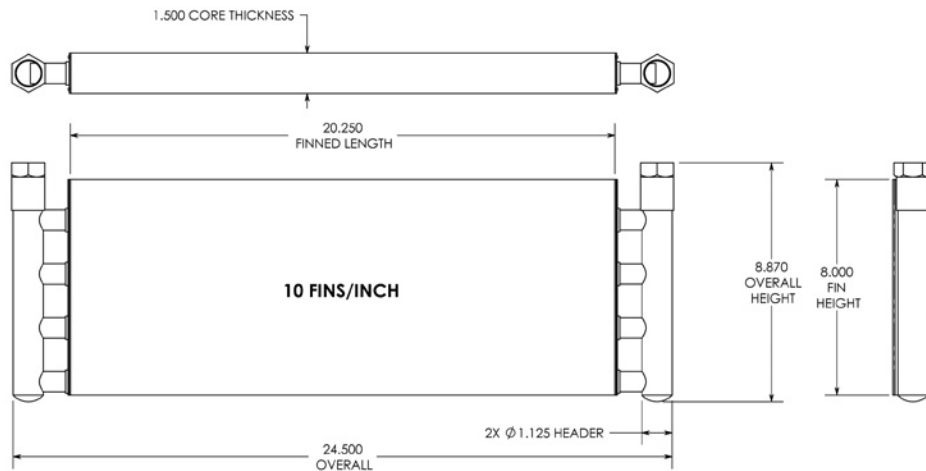

APPEARANCE

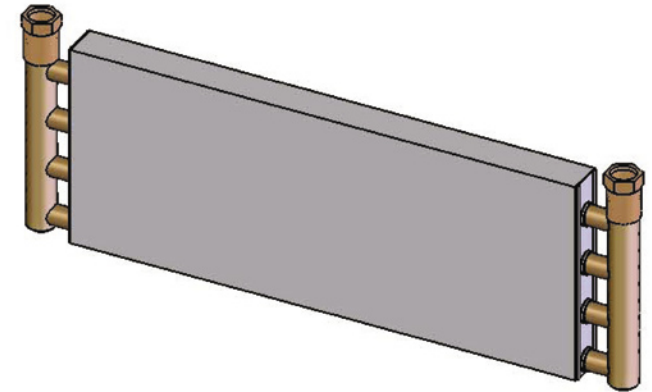

SPECIFICATIONS

Flow Range (GPM):2 - 16
 Heat Rejection Range (BTU/Hr):
 13,270 - 20,730
 Fitting Size:.....3/4" FPT

Material

Copper Tube:.....CDA122
 Inner Tube:Al-3003
 Inner Fin:Al - 1100
 Outer Fin:Al - 1100
 Fitting:.....Copper

Cooler Weight (lbs.)

Total Weight :.....5 lbs.

PERFORMANCE

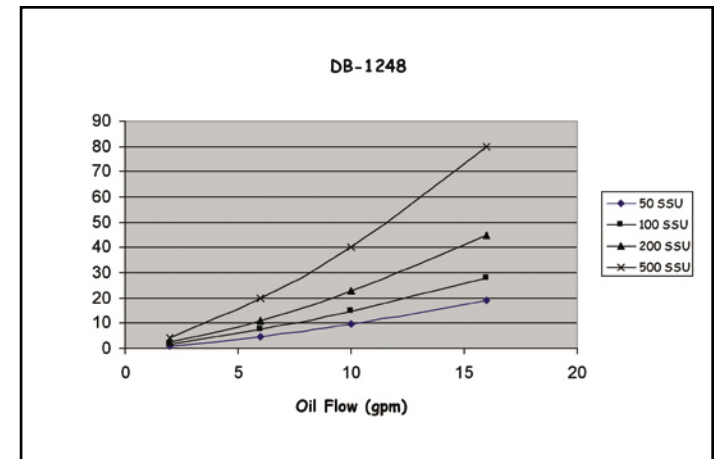
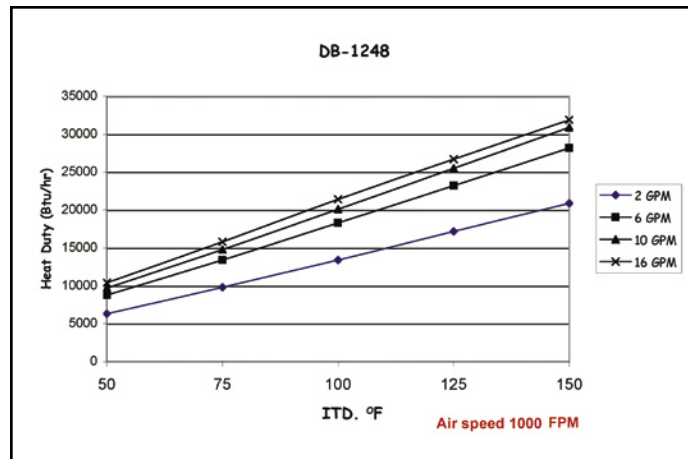

DIMENSIONS

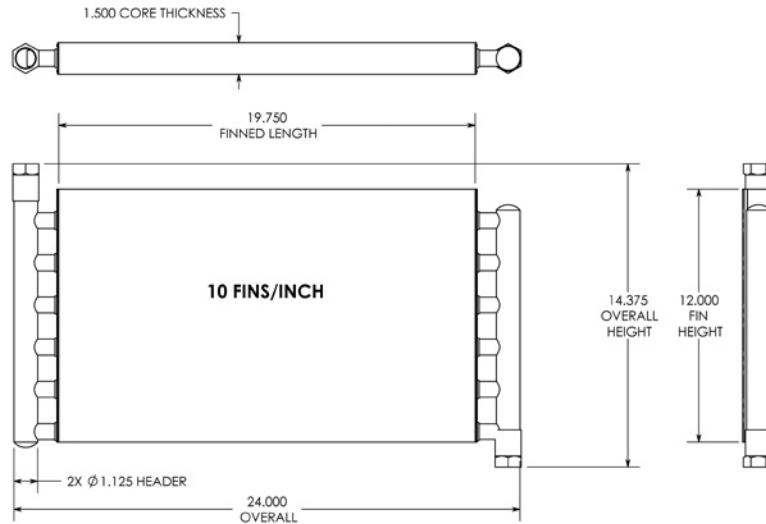

APPEARANCE

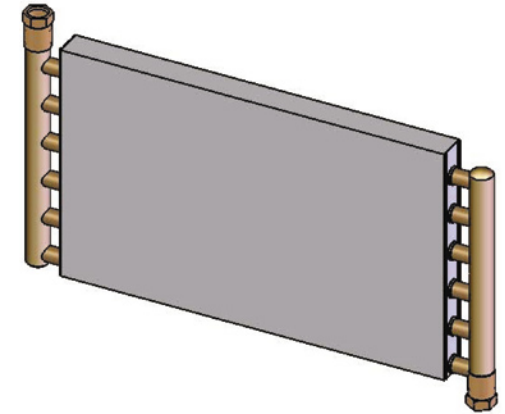

SPECIFICATIONS

Flow Range (GPM):4 - 20
 Heat Rejection Range (BTU/Hr):
 22,000 -31,000
 Fitting Size:.....3/4" FPT

Material

Copper Tube:.....CDA122
 Inner Tube:Al-3003
 Inner Fin:Al - 1100
 Outer Fin:Al - 1100
 Fitting:.....Copper

Cooler Weight (lbs.)

Total Weight :.....7.5 lbs.

PERFORMANCE

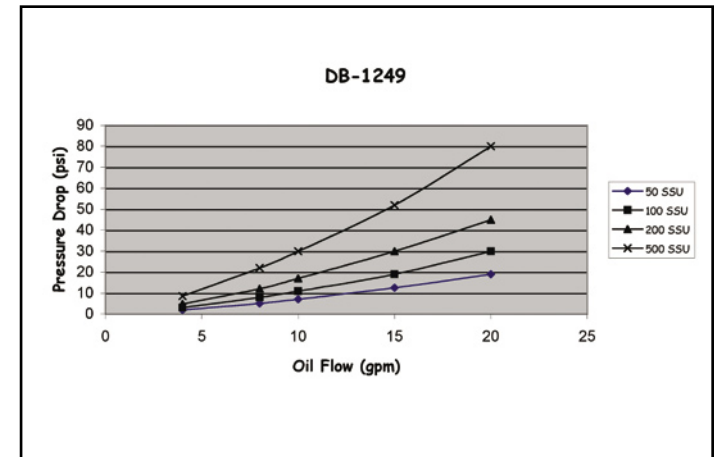
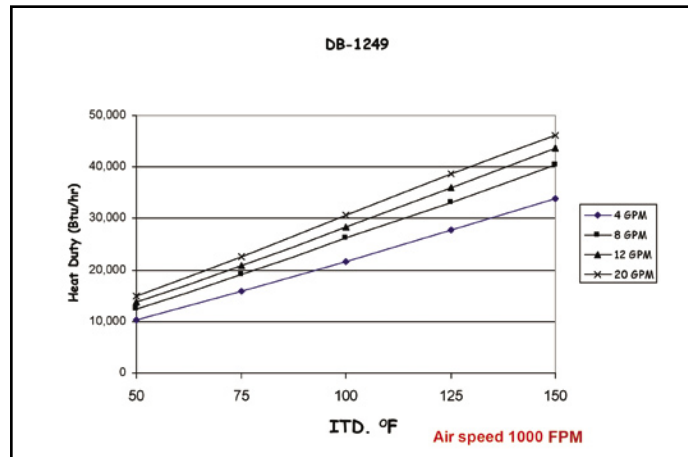

DIMENSIONS

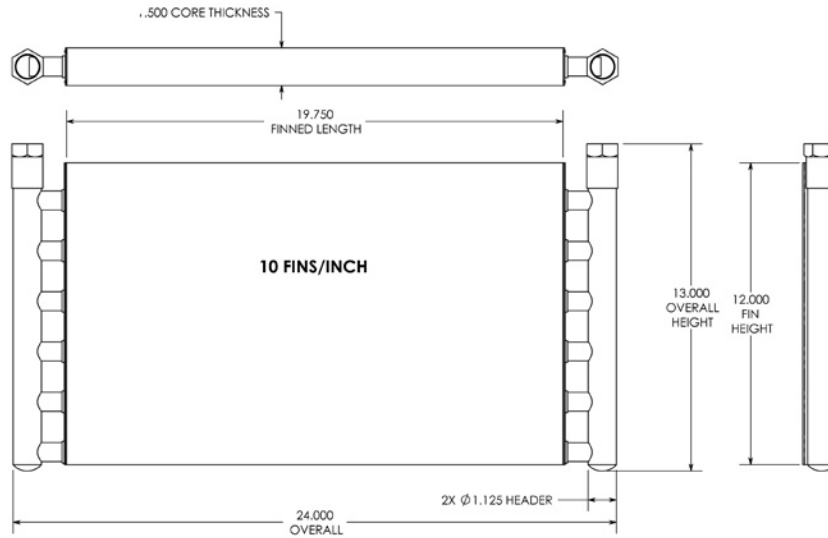

APPEARANCE

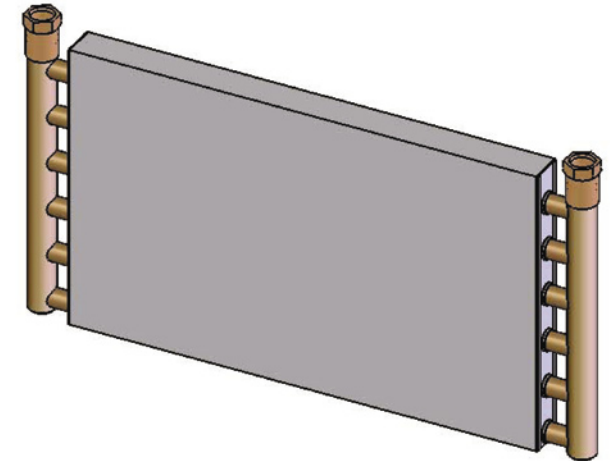

SPECIFICATIONS

Flow Range (GPM):4 - 20
 Heat Rejection Range (BTU/Hr):
 22,000 - 31,000
 Fitting Size:.....3/4" FPT
Material
 Copper Tube:.....CDA122
 Inner Tube:Al-3003
 Inner Fin:Al - 1100
 Outer Fin:Al - 1100
 Fitting:.....Copper
Cooler Weight (lbs.)
 Total Weight :.....7.5 lbs.

PERFORMANCE

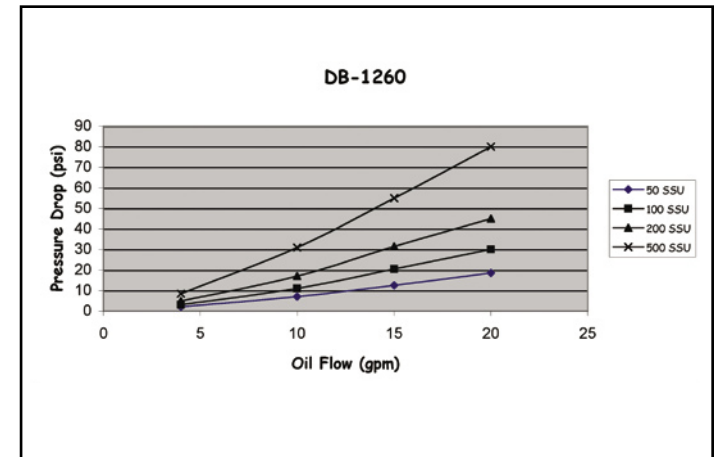
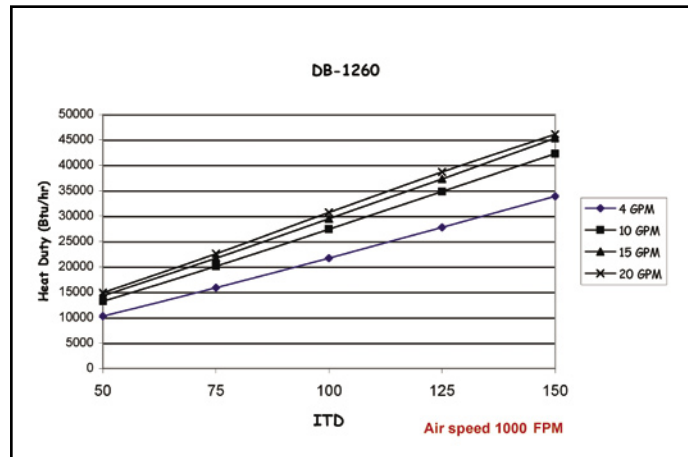

DIMENSIONS

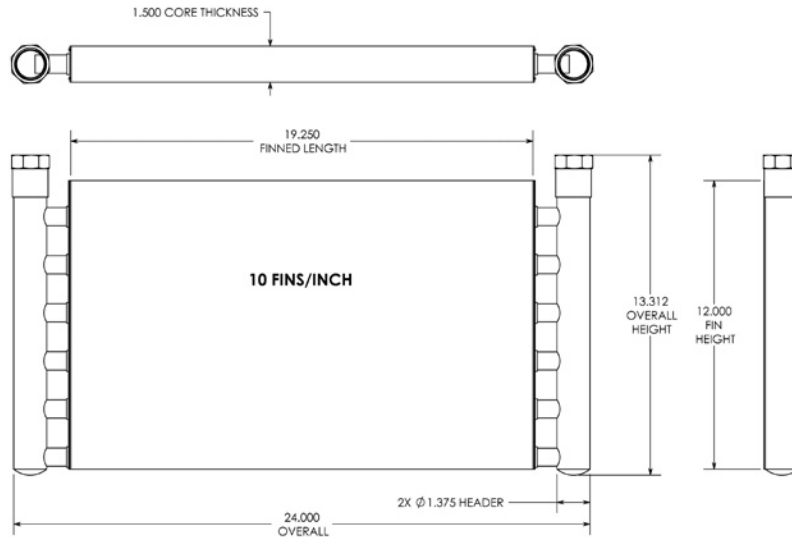

APPEARANCE

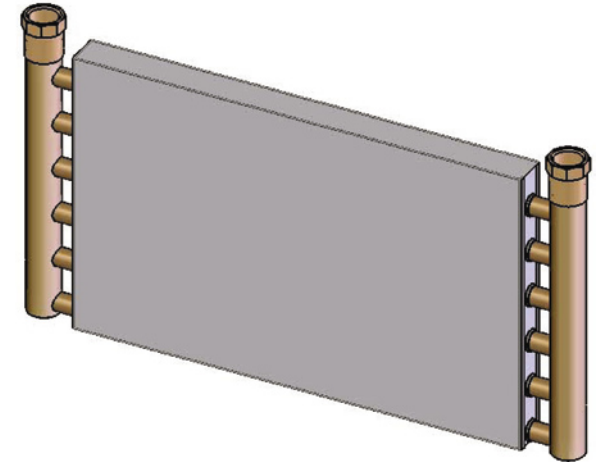

SPECIFICATIONS

Flow Range (GPM):4 - 24
 Heat Rejection Range (BTU/Hr):
 21,500 - 31,000
 Fitting Size:.....1" FPT
Material
 Copper Tube:.....CDA122
 Inner Tube:Al-3003
 Inner Fin:Al - 1100
 Outer Fin:Al - 1100
 Fitting:.....Copper
Cooler Weight (lbs.)
 Total Weight :.....8 lbs.

PERFORMANCE

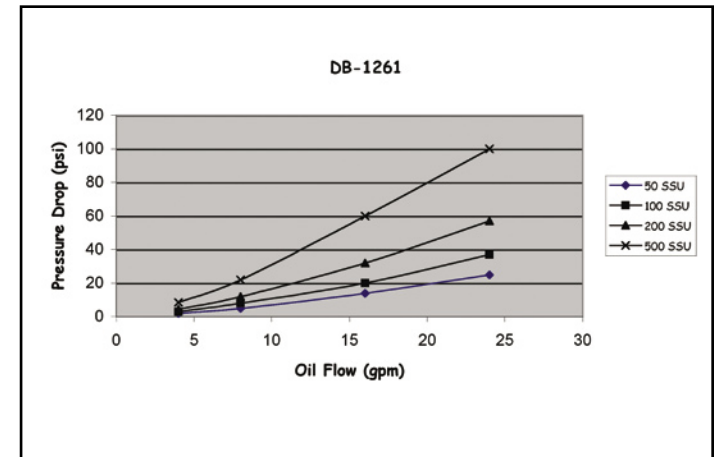
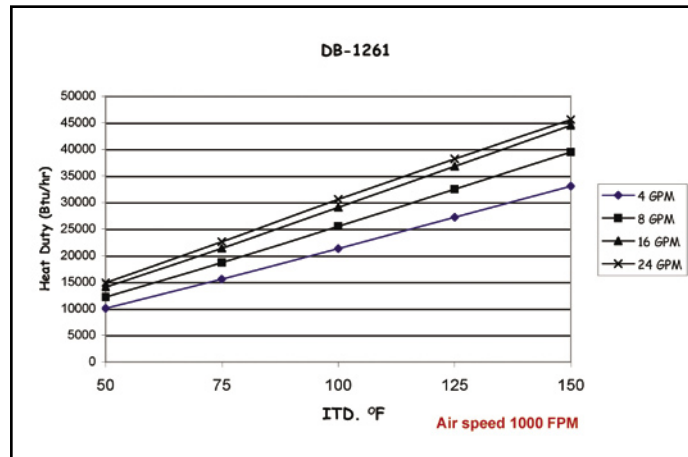

DIMENSIONS

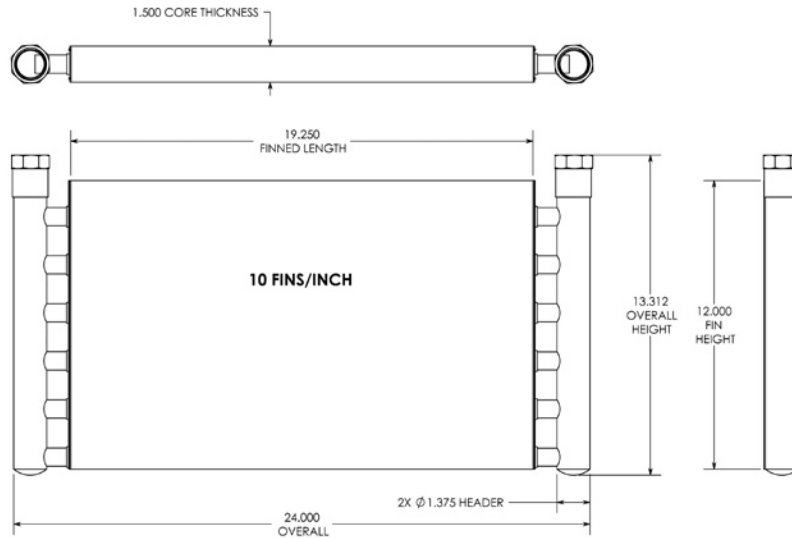

APPEARANCE

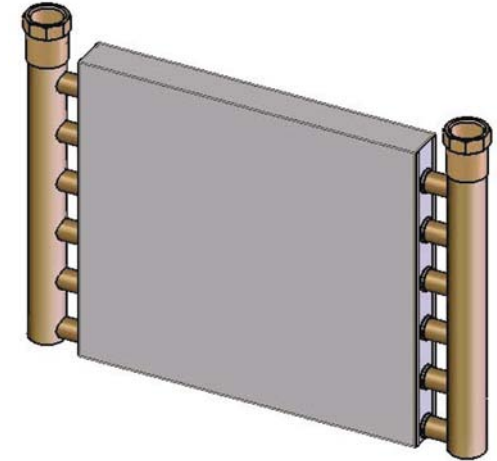

SPECIFICATIONS

Flow Range (GPM):4 - 24
 Heat Rejection Range (BTU/Hr):
 16,000 - 21,500
 Fitting Size:.....1" FPT
Material
 Copper Tube:.....CDA122
 Inner Tube:Al-3003
 Inner Fin:Al - 1100
 Outer Fin:Al - 1100
 Fitting:.....Copper
Cooler Weight (lbs.)
 Total Weight :.....6.5 lbs.

PERFORMANCE

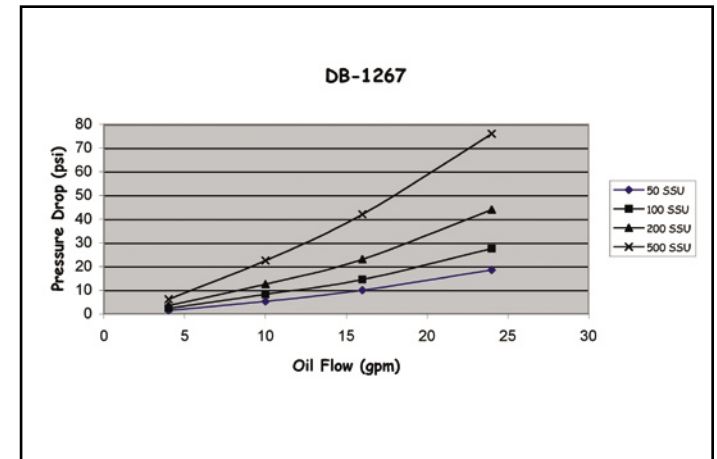
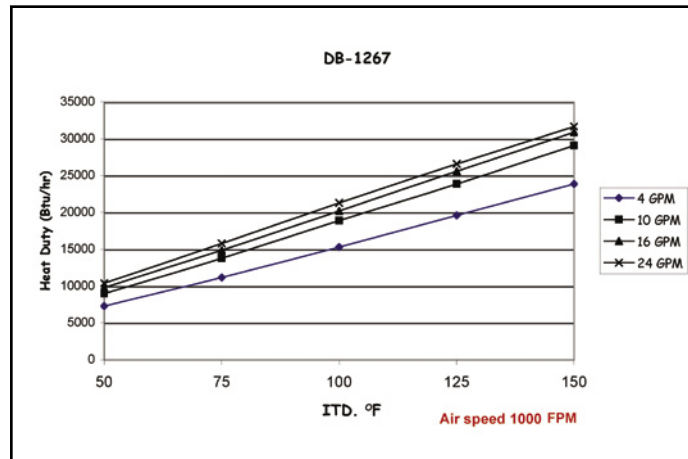

DIMENSIONS

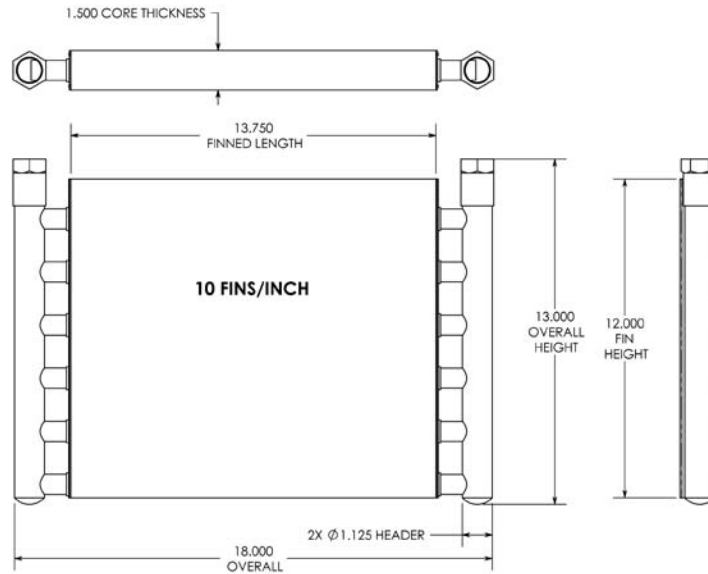

APPEARANCE

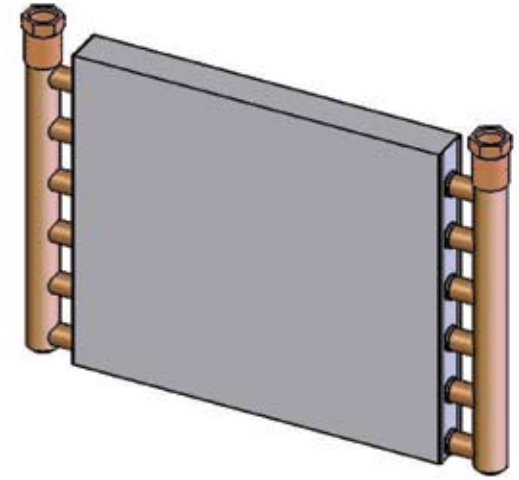

SPECIFICATIONS

Flow Range (GPM):4 - 20
 Heat Rejection Range (BTU/Hr):
 16,500 - 21,500
 Fitting Size:.....3/4" FPT

Material

Copper Tube:.....CDA122
 Inner Tube:Al-3003
 Inner Fin:Al - 1100
 Outer Fin:.....Al - 1100
 Fitting:.....Copper / Brass

Cooler Weight (lbs.)

Total Weight :5.75 lbs.

PERFORMANCE

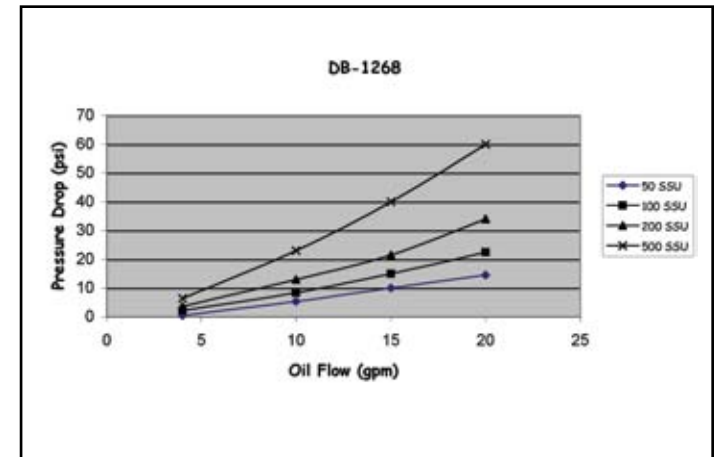
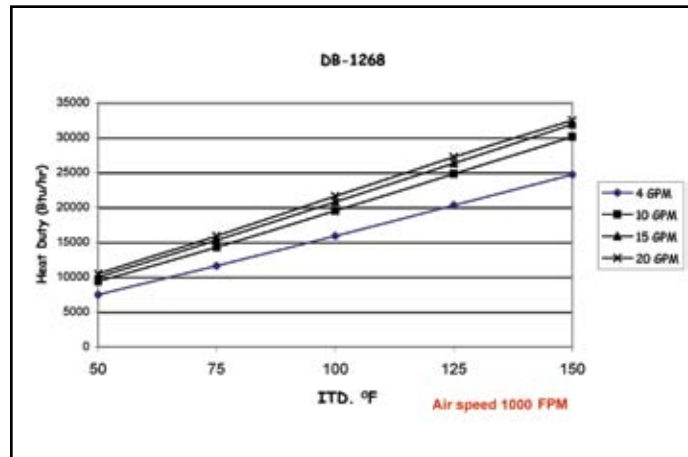

DIMENSIONS

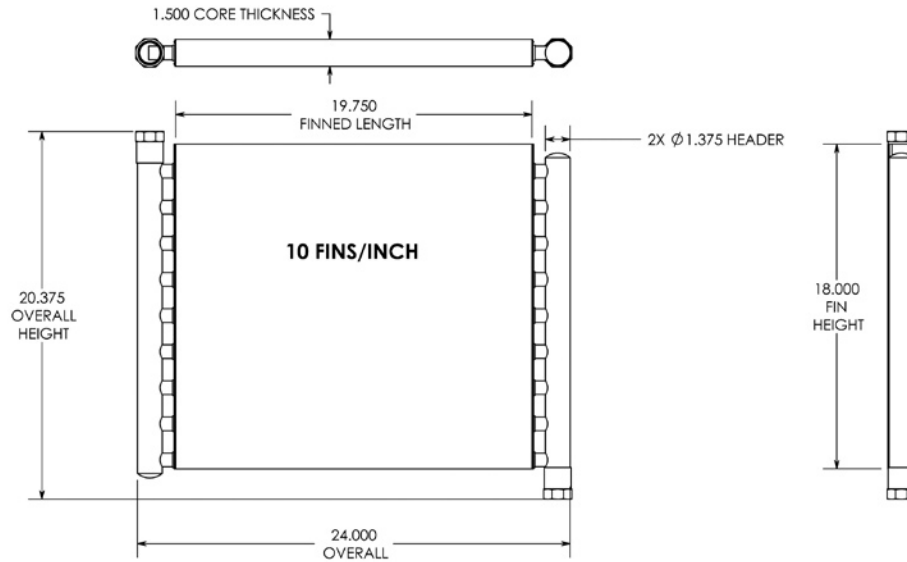

APPEARANCE

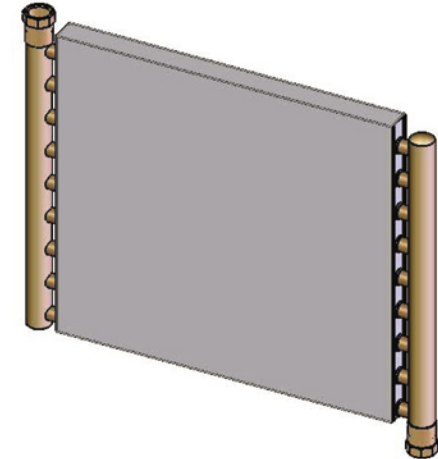

SPECIFICATIONS

Flow Range (GPM):5 - 20
 Heat Rejection Range (BTU/Hr):
 31,500 - 42,500
 Fitting Size:.....3/4" FPT

Material

Copper Tube:.....CDA122
 Inner Tube:Al-3003
 Inner Fin:Al - 1100
 Outer Fin:Al - 1100
 Fitting:.....Copper

Cooler Weight (lbs.)

Total Weight :.....11.5 lbs.

PERFORMANCE

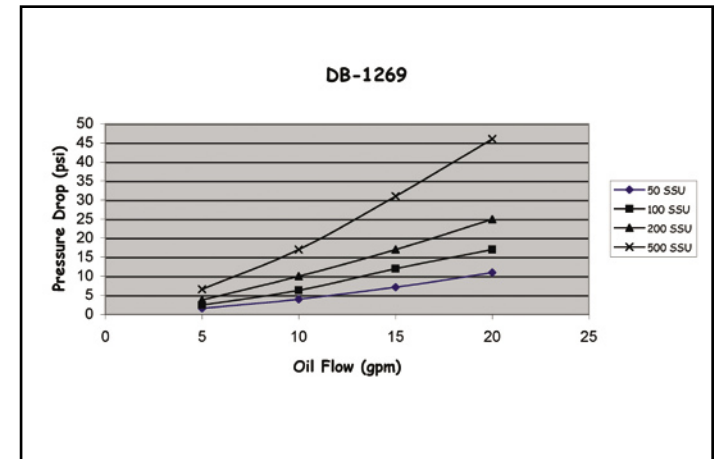
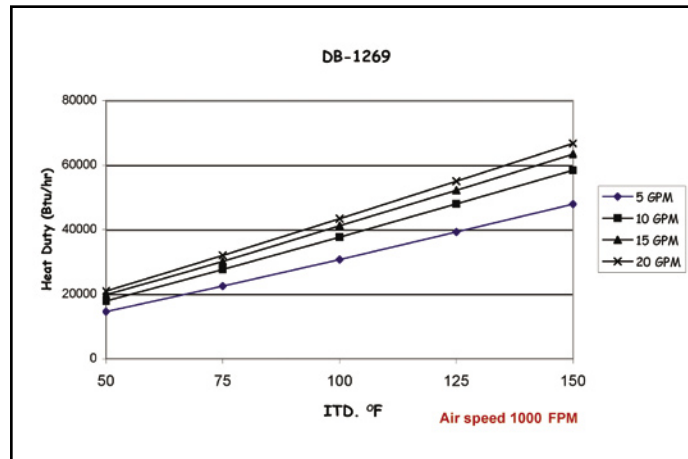

DIMENSIONS

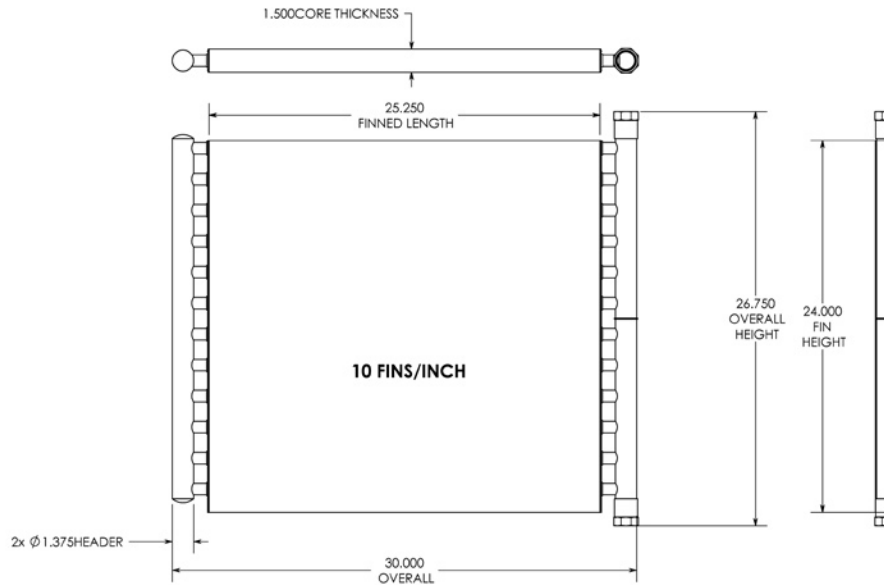

APPEARANCE

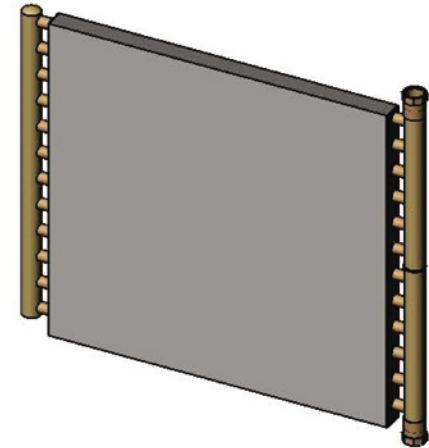

SPECIFICATIONS

Flow Range (GPM):4 - 14
 Heat Rejection Range (BTU/Hr):
 44,500 - 67,500
 Fitting Size:.....1" FPT
Material
 Copper Tube:.....CDA122
 Inner Tube:Al-3003
 Inner Fin:Al - 1100
 Outer Fin:Al - 1100
 Fitting:.....Copper
Cooler Weight (lbs.)
 Total Weight :.....19.5 lbs.

PERFORMANCE

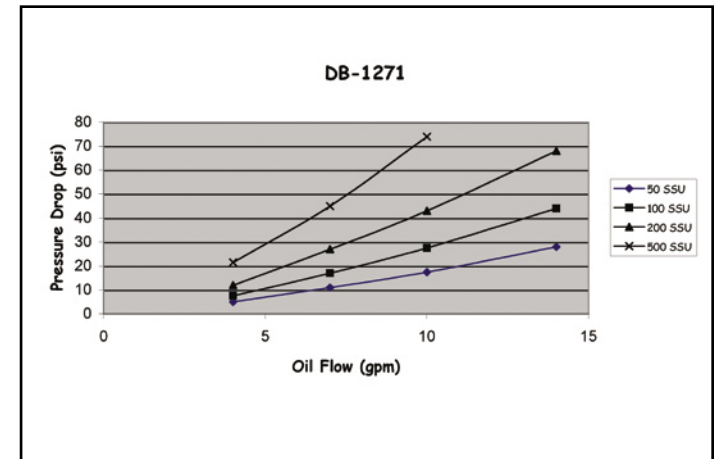
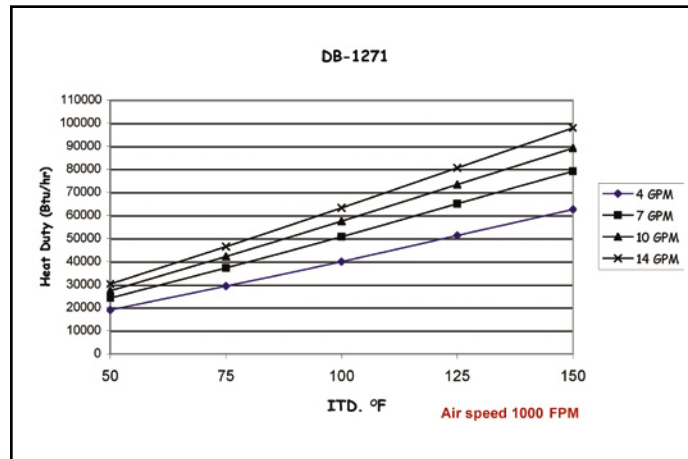

DIMENSIONS

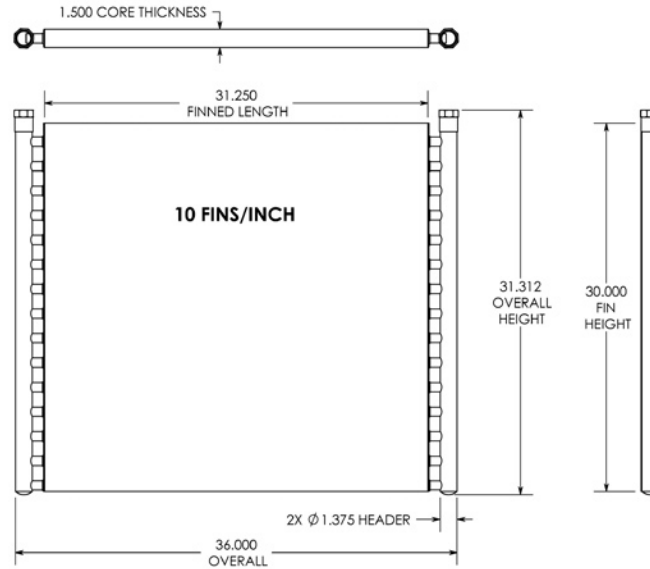

APPEARANCE

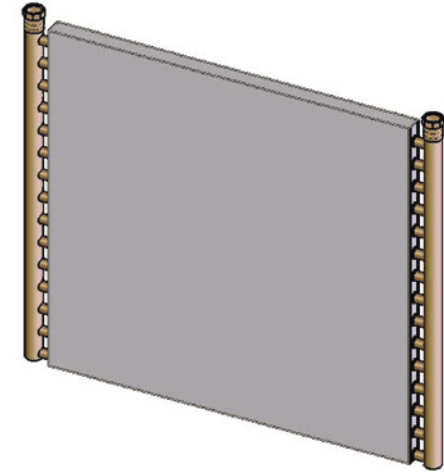

SPECIFICATIONS

Flow Range (GPM):8 - 30
 Heat Rejection Range (BTU/Hr):
 69,000 - 99,000
 Fitting Size:.....1" FPT
Material
 Copper Tube:.....CDA122
 Inner Tube:Al-3003
 Inner Fin:Al - 1100
 Outer Fin:Al - 1100
 Fitting:.....Copper
Cooler Weight (lbs.)
 Total Weight :.....28 lbs.

PERFORMANCE

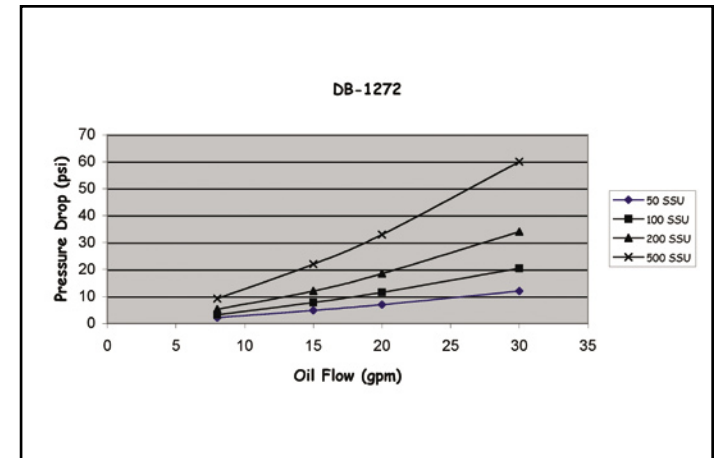
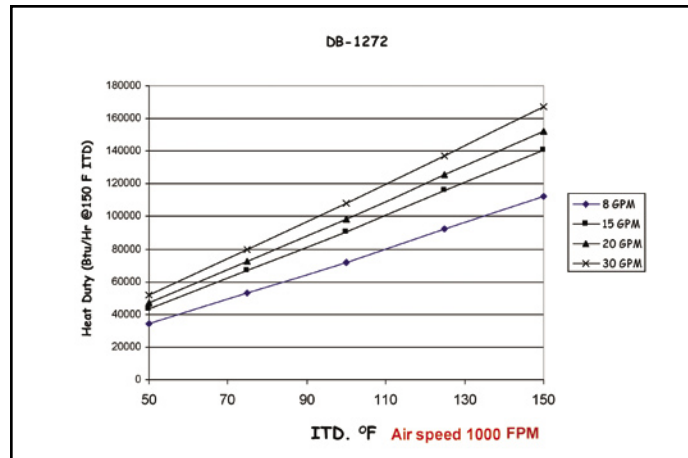

DIMENSIONS

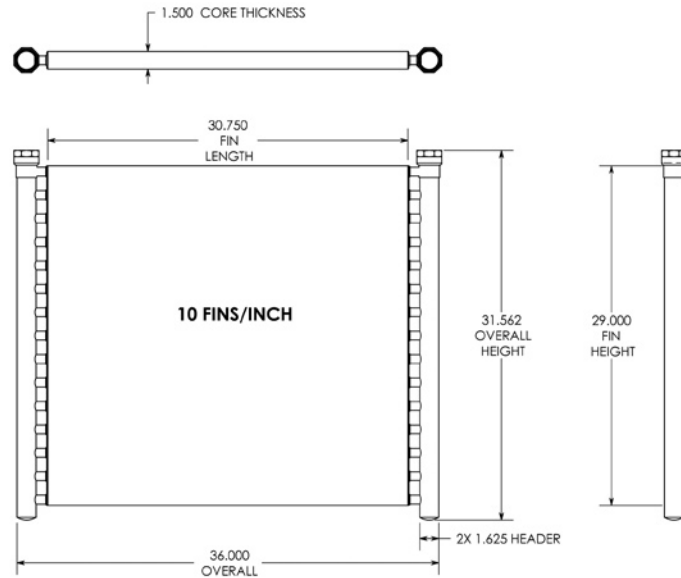

APPEARANCE

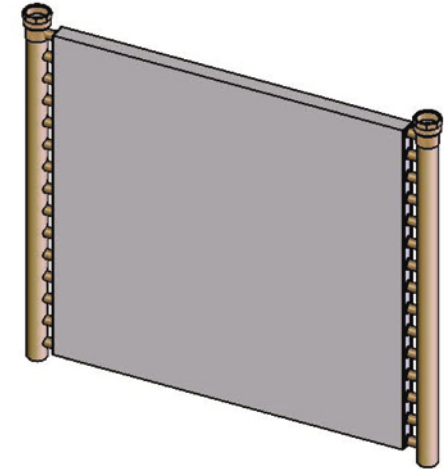

SPECIFICATIONS

Flow Range (GPM):8 - 50
 Heat Rejection Range (BTU/Hr):
 69,000 - 114,000
 Fitting Size:.....1-1/4" FPT

Material

Copper Tube:.....CDA122
 Inner Tube:Al-3003
 Inner Fin:Al - 1100
 Outer Fin:Al - 1100
 Fitting:.....Copper

Cooler Weight (lbs.)

Total Weight :.....29 lbs.

PERFORMANCE

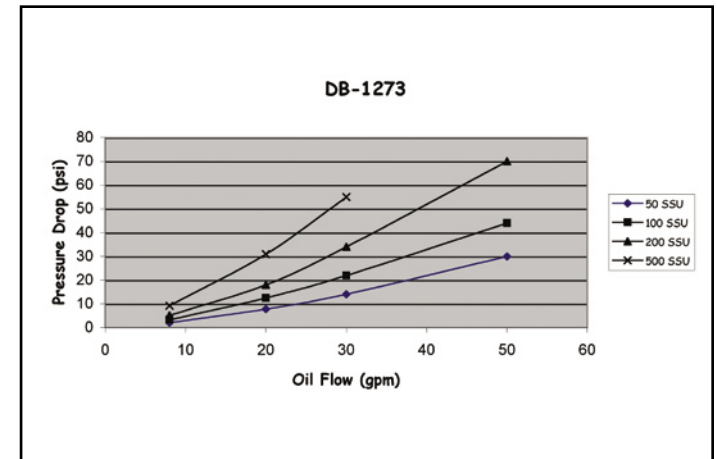
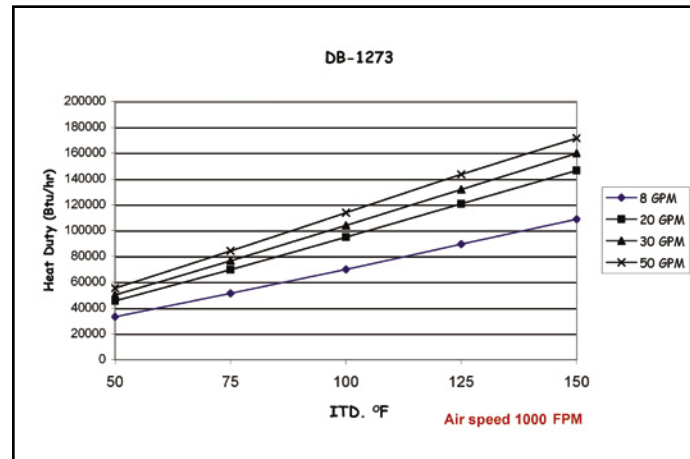

DIMENSIONS

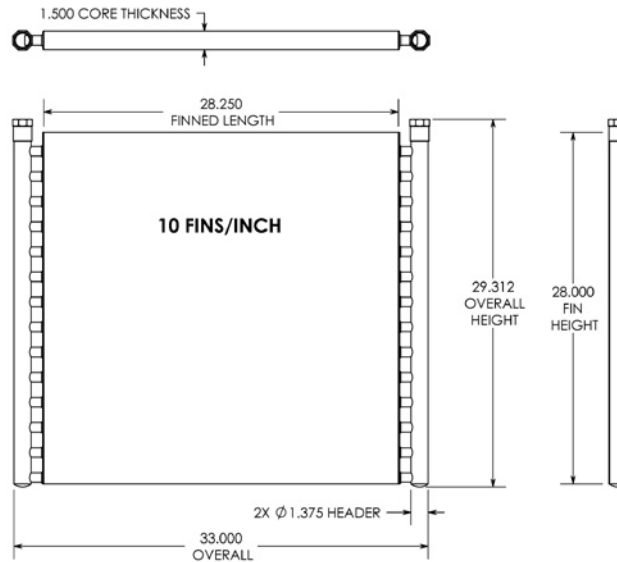

APPEARANCE

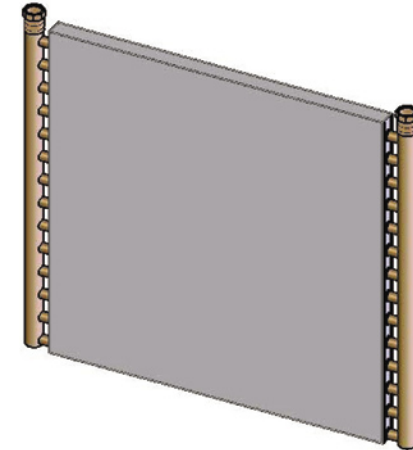

SPECIFICATIONS

Flow Range (GPM):5 - 30

Heat Rejection Range (BTU/Hr):
57,000 - 91,000

Fitting Size:.....1" FPT

Material

Copper Tube:.....CDA122

Inner Tube:Al-3003

Inner Fin:Al - 1100

Outer Fin:Al - 1100

Fitting:.....Copper

Cooler Weight (lbs.)

Total Weight :.....24 lbs.

PERFORMANCE

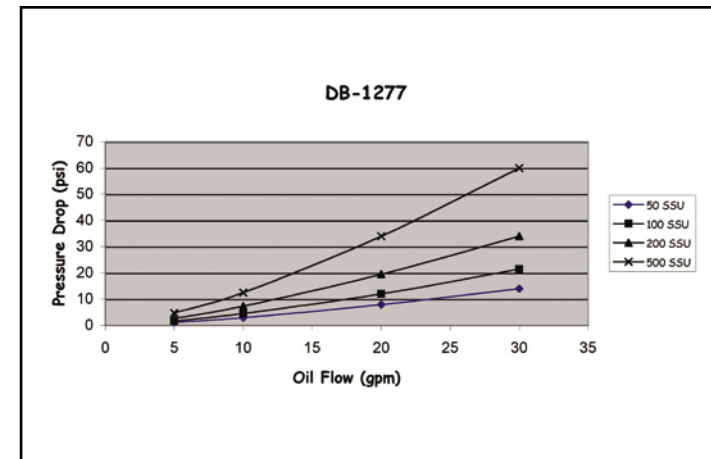
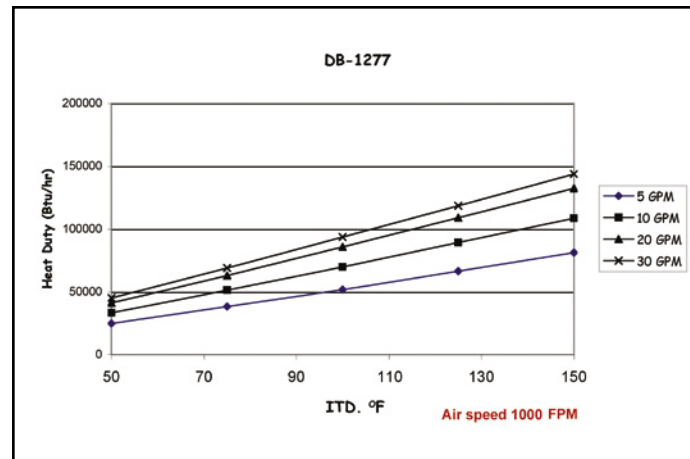

DIMENSIONS

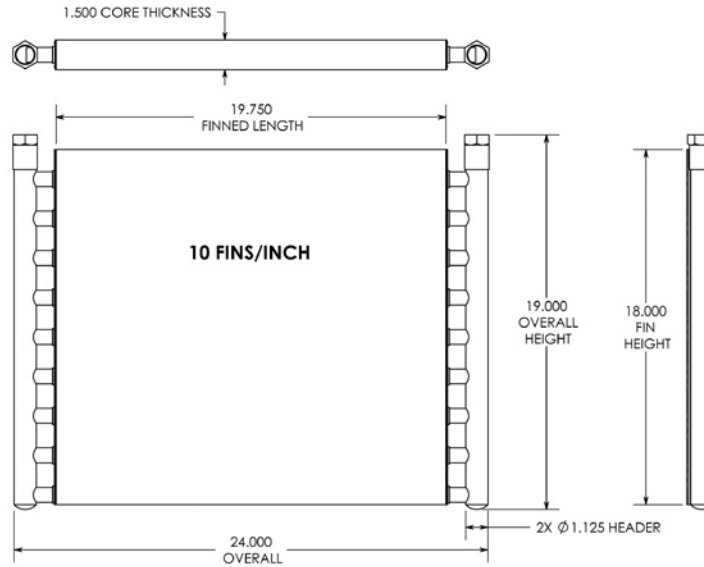

APPEARANCE

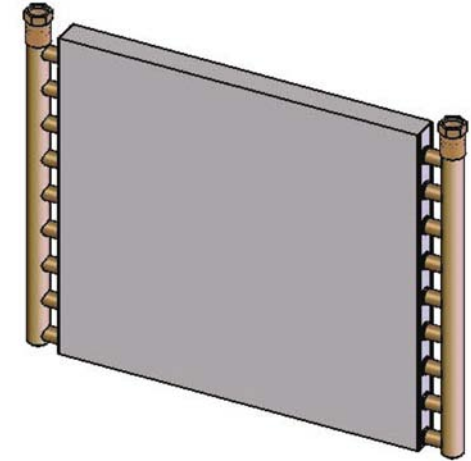

SPECIFICATIONS

Flow Range (GPM):5 - 20
 Heat Rejection Range (BTU/Hr):
 31,500 - 42,500
 Fitting Size:.....3/4" FPT

Material

Copper Tube:.....CDA122
 Inner Tube:Al-3003
 Inner Fin:Al - 1100
 Outer Fin:Al - 1100
 Fitting:.....Copper

Cooler Weight (lbs.)

Total Weight :.....11.5 lbs.

PERFORMANCE

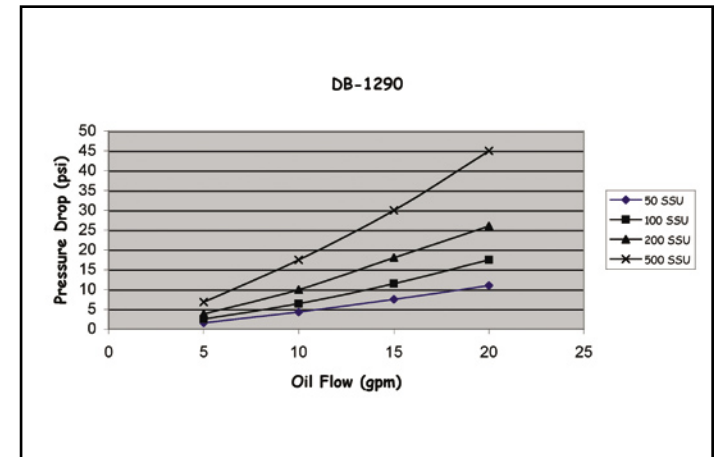
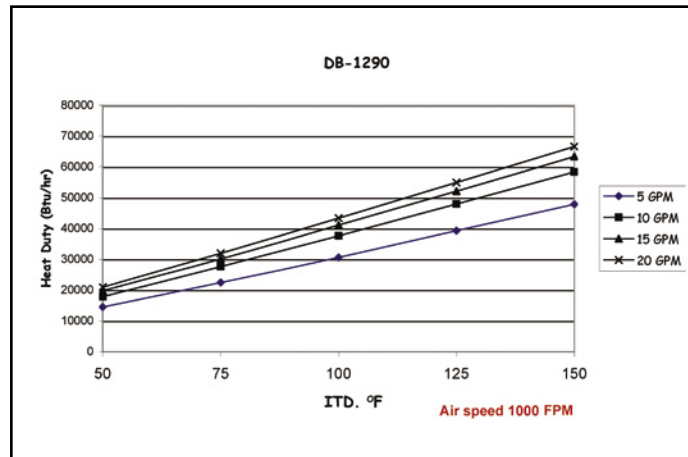

DIMENSIONS

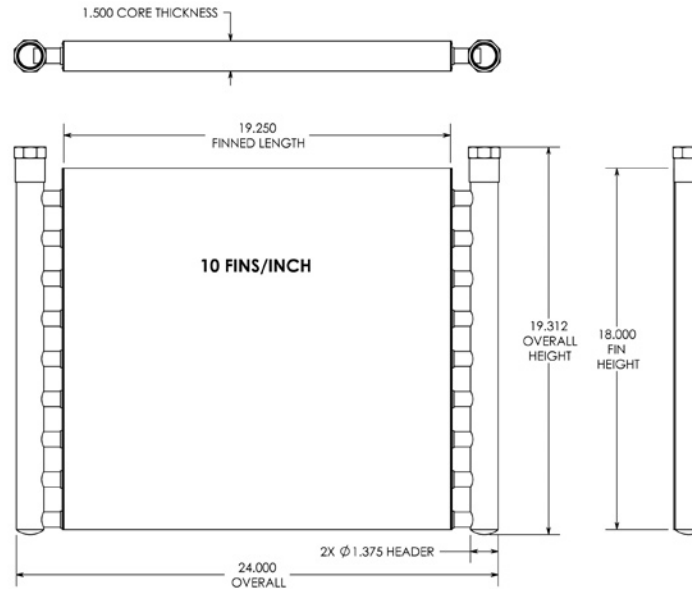

APPEARANCE

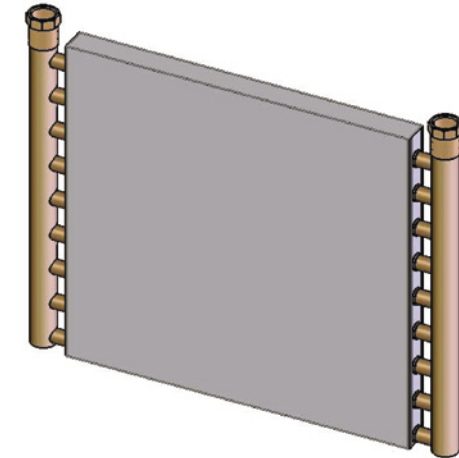

SPECIFICATIONS

Flow Range (GPM):5 - 30
 Heat Rejection Range (BTU/Hr):
 31,000 - 45,000

Fitting Size:.....1" FPT

Material

Copper Tube:.....CDA122

Inner Tube:Al-3003

Inner Fin:Al - 1100

Outer Fin:Al - 1100

Fitting:.....Copper

Cooler Weight (lbs.)

Total Weight :.....12 lbs.

PERFORMANCE

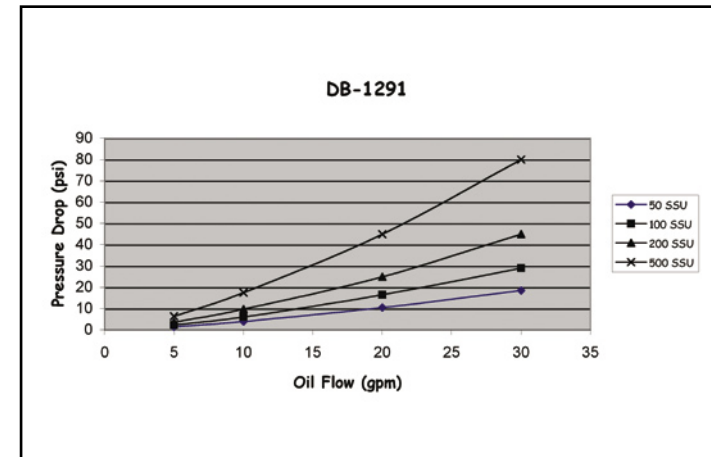
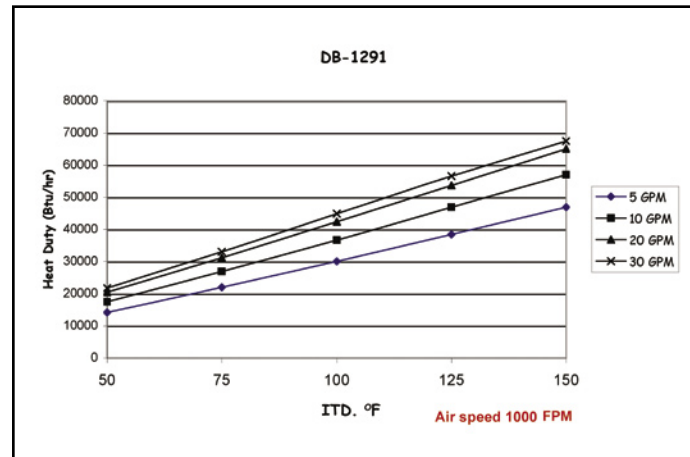

DIMENSIONS

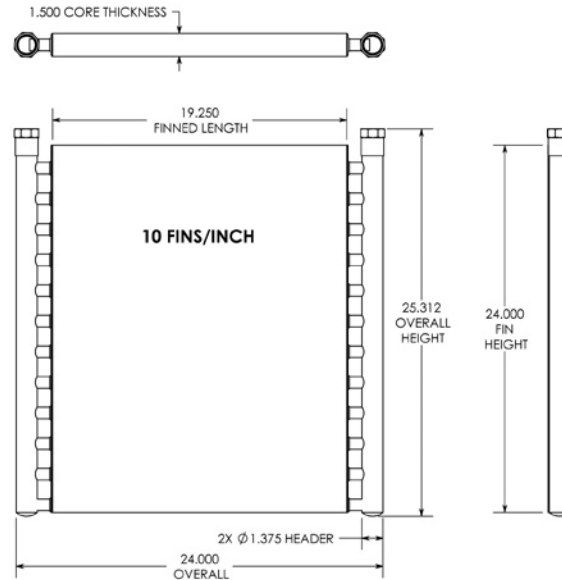

APPEARANCE

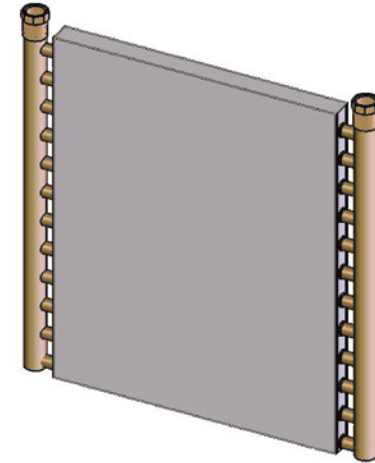

SPECIFICATIONS

Flow Range (GPM):5 - 30
 Heat Rejection Range (BTU/Hr):
 39,000 - 56,500
 Fitting Size:.....1" FPT
Material
 Copper Tube:.....CDA122
 Inner Tube:Al-3003
 Inner Fin:Al - 1100
 Outer Fin:Al - 1100
 Fitting:.....Copper
Cooler Weight (lbs.)
 Total Weight :.....15.5 lbs.

PERFORMANCE

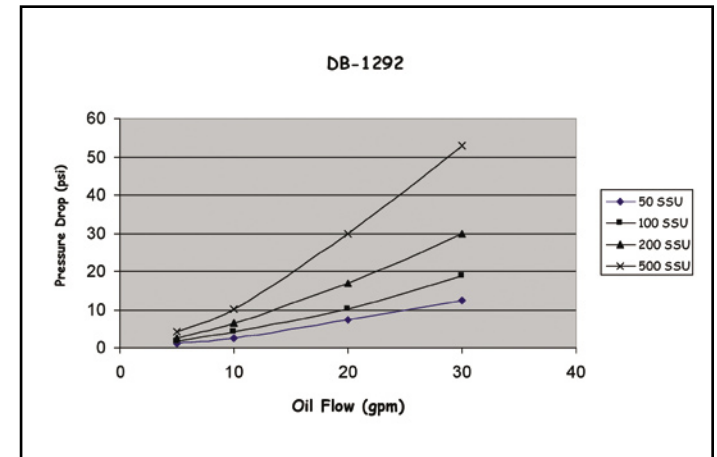
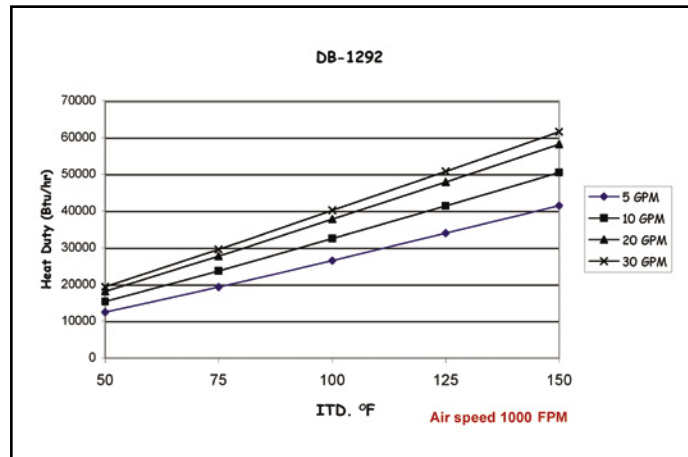

DIMENSIONS

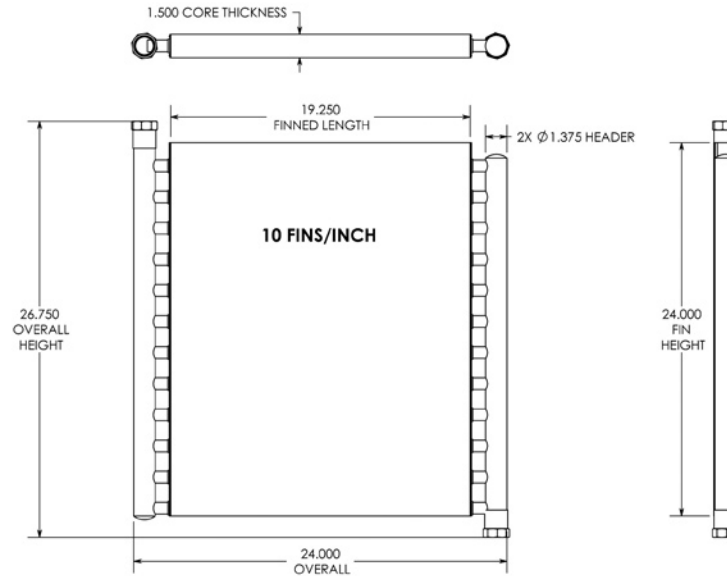

APPEARANCE

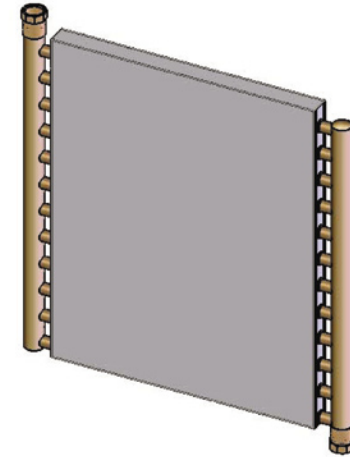

SPECIFICATIONS

Flow Range (GPM):5 - 30
 Heat Rejection Range (BTU/Hr):
 39,000 - 56,500
 Fitting Size:.....1" FPT
Material
 Copper Tube:.....CDA122
 Inner Tube:Al-3003
 Inner Fin:Al - 1100
 Outer Fin:Al - 1100
 Fitting:.....Copper
Cooler Weight (lbs.)
 Total Weight :.....15.5 lbs.

PERFORMANCE

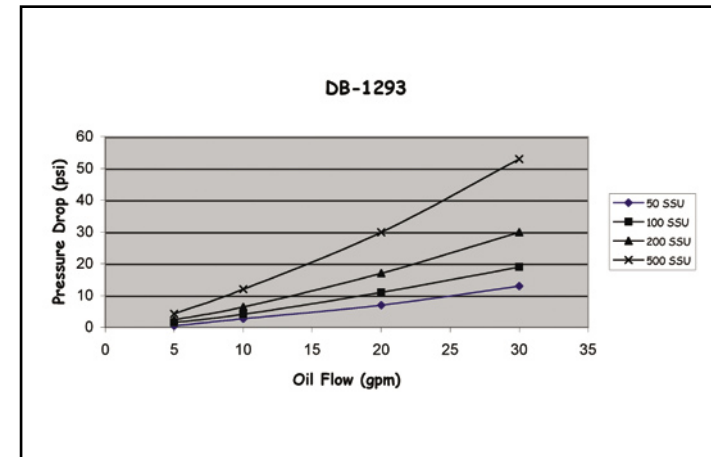
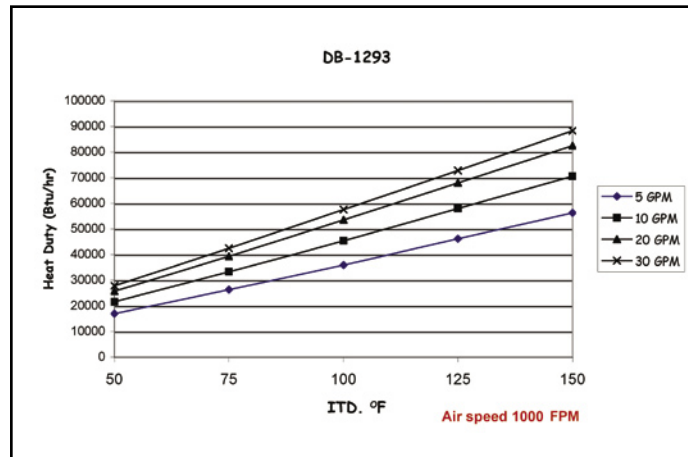

DIMENSIONS

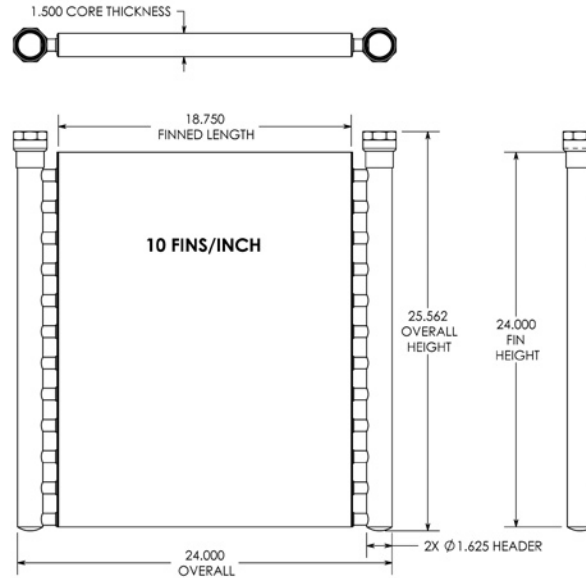

APPEARANCE

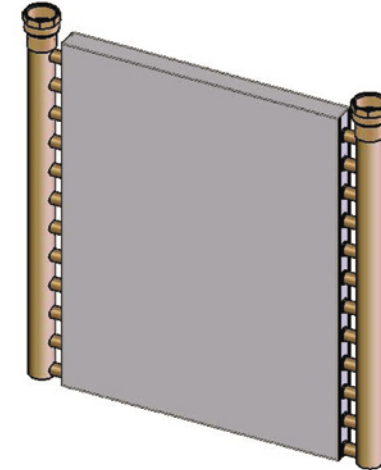

SPECIFICATIONS

Flow Range (GPM):8 - 50
 Heat Rejection Range (BTU/Hr):
 42,000 - 61,000
 Fitting Size:.....1-1/4" FPT

Material

Copper Tube:.....CDA122
 Inner Tube:Al-3003
 Inner Fin:Al - 1100
 Outer Fin:Al - 1100
 Fitting:.....Copper

Cooler Weight (lbs.)

Total Weight :.....16 lbs.

PERFORMANCE

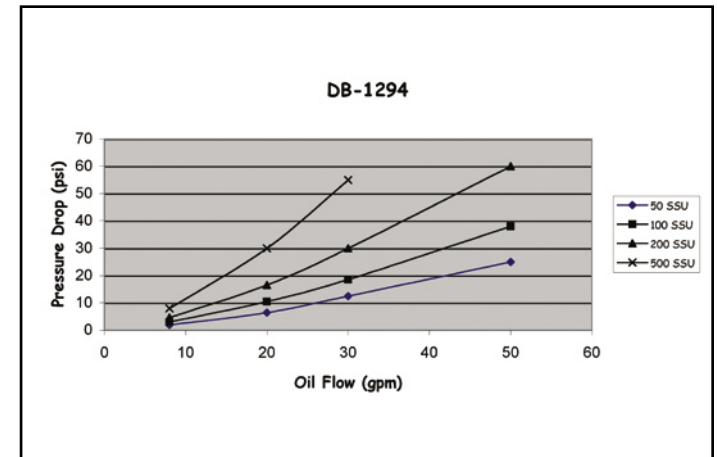
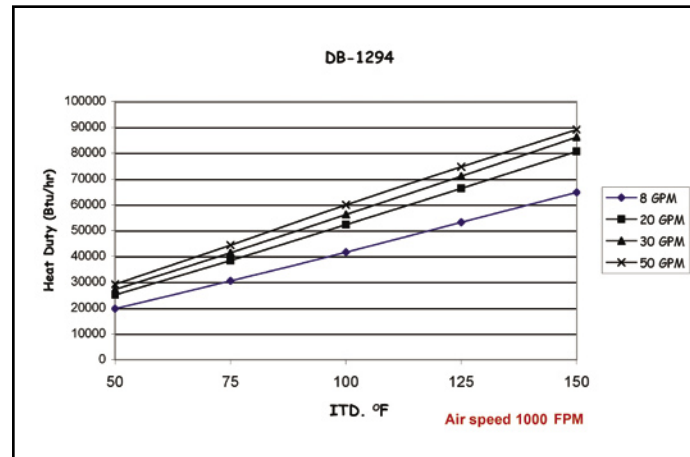

DIMENSIONS

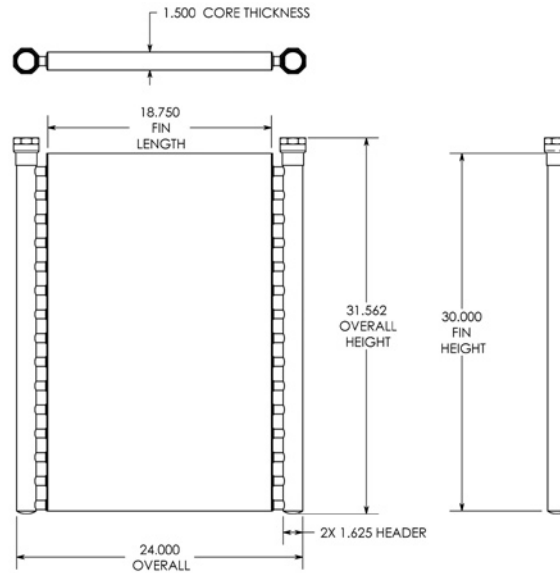

APPEARANCE

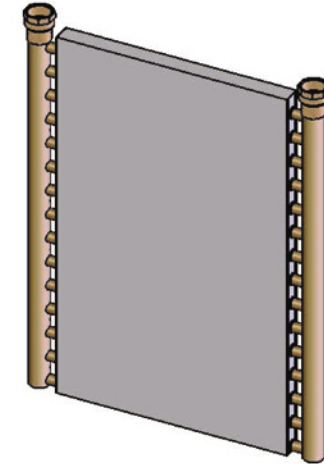

SPECIFICATIONS

Flow Range (GPM):8 - 50
 Heat Rejection Range (BTU/Hr):
 50,000 - 73,000
 Fitting Size:.....1-1/4" FPT

Material

Copper Tube:.....CDA122
 Inner Tube:Al-3003
 Inner Fin:Al - 1100
 Outer Fin:Al - 1100
 Fitting:.....Copper

Cooler Weight (lbs.)

Total Weight :.....21 lbs.

PERFORMANCE

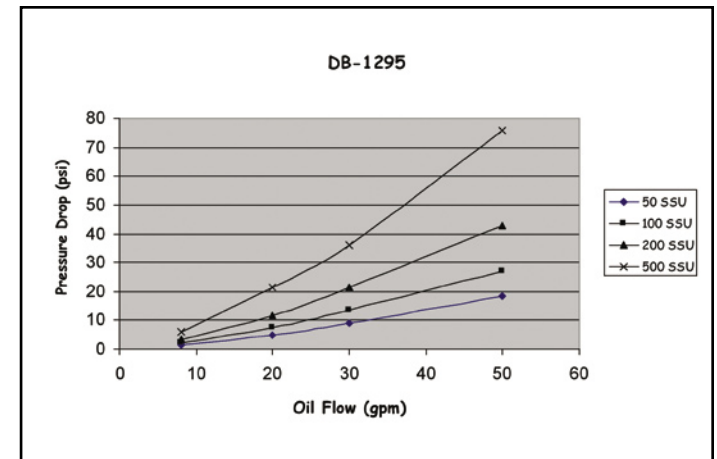
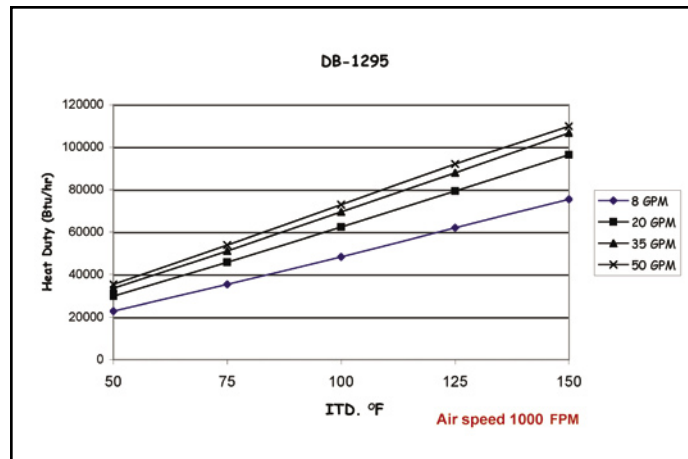

DIMENSIONS

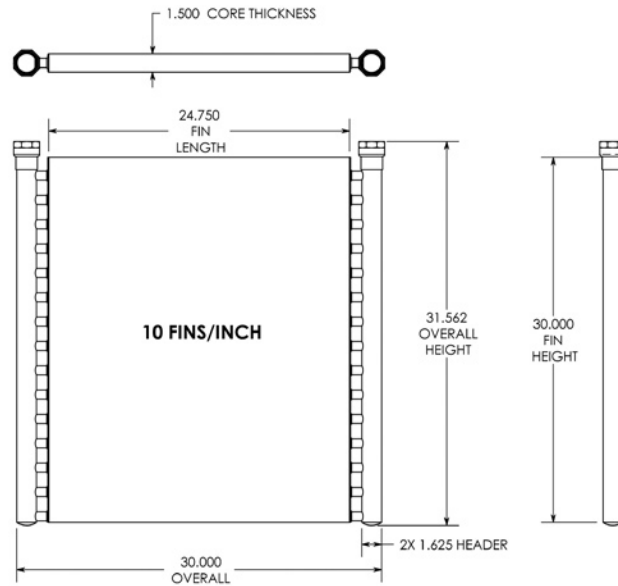

APPEARANCE

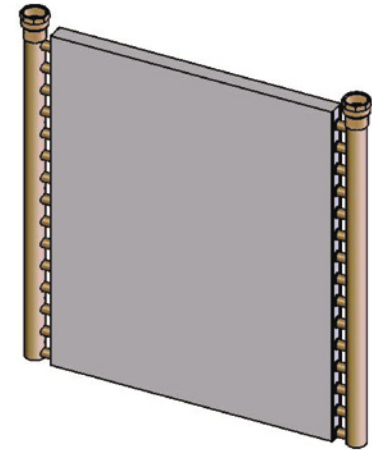

SPECIFICATIONS

Flow Range (GPM):8 - 50
 Heat Rejection Range (BTU/Hr):
 61,000 - 94,000
 Fitting Size:.....1-1/4" FPT

Material

Copper Tube:.....CDA122
 Inner Tube:Al-3003
 Inner Fin:Al - 1100
 Outer Fin:Al - 1100
 Fitting:.....Copper

Cooler Weight (lbs.)

Total Weight :.....25 lbs.

PERFORMANCE

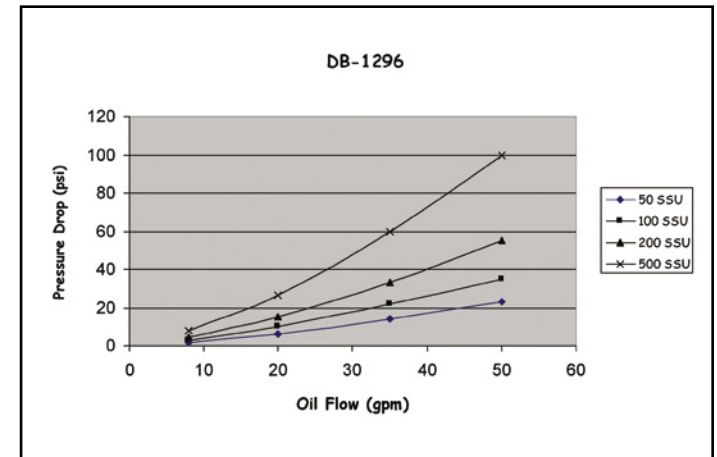
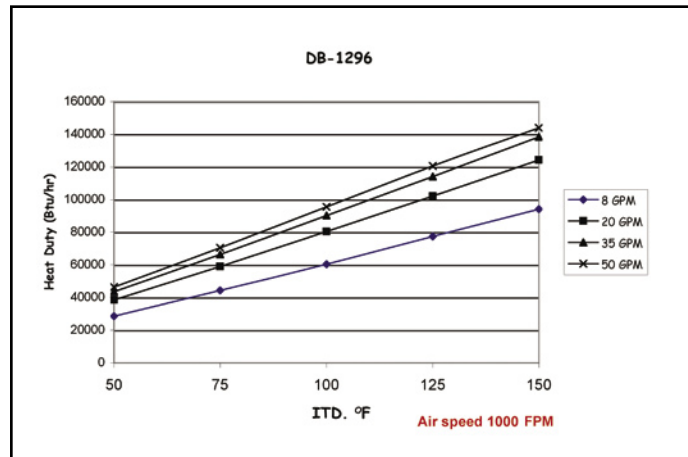

DIMENSIONS

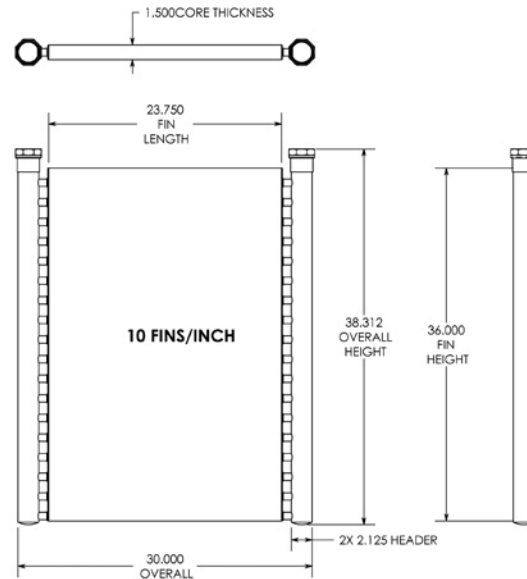

APPEARANCE

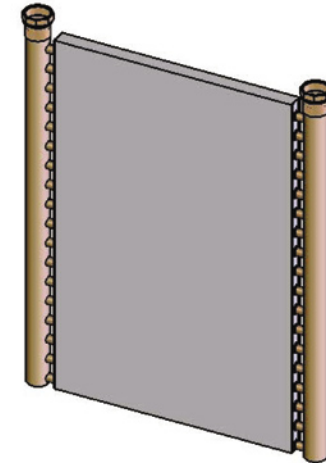

SPECIFICATIONS

Flow Range (GPM):9 - 72

Heat Rejection Range (BTU/Hr):
70,000 - 115,000

Fitting Size:.....2" FPT

Material

Copper Tube:.....CDA122

Inner Tube:Al-3003

Inner Fin:Al - 1100

Outer Fin:Al - 1100

Fitting:.....Copper

Cooler Weight (lbs.)

Total Weight :.....32 lbs.

PERFORMANCE

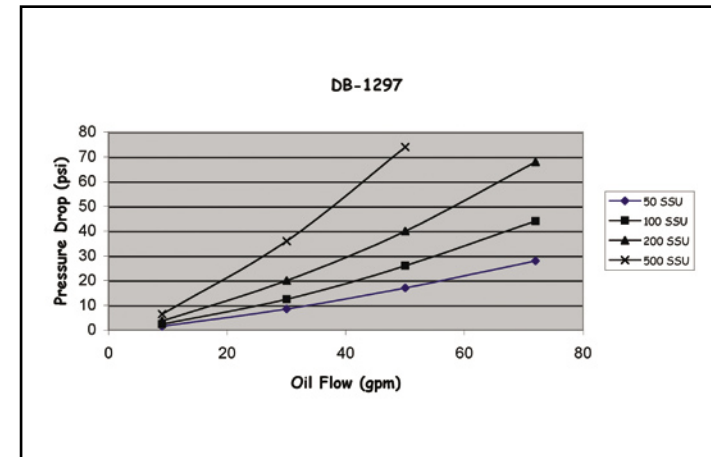
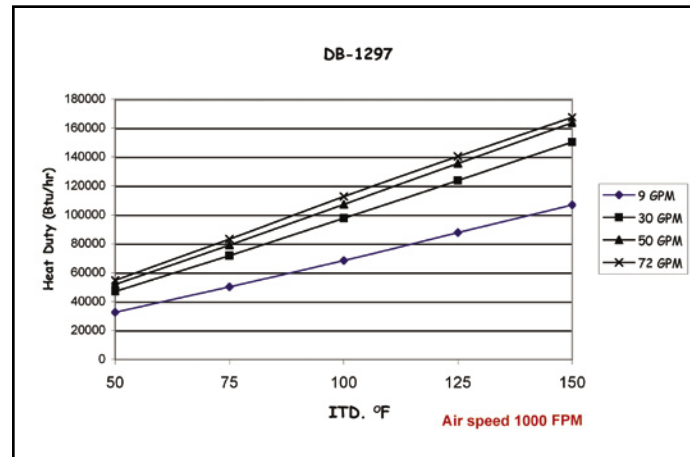

DIMENSIONS

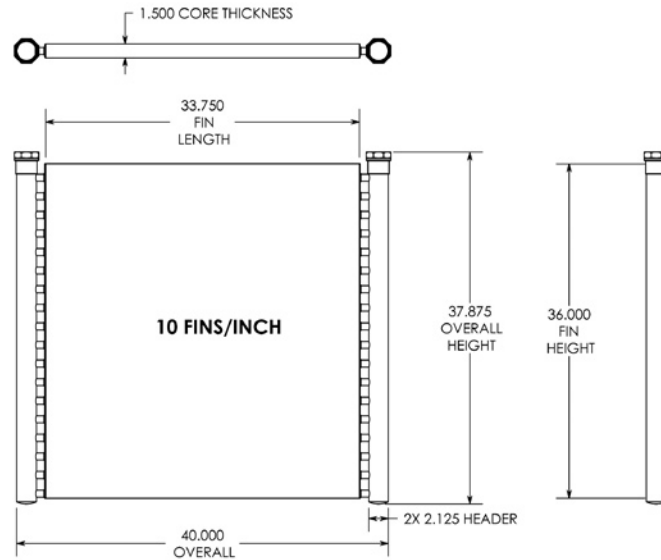

APPEARANCE

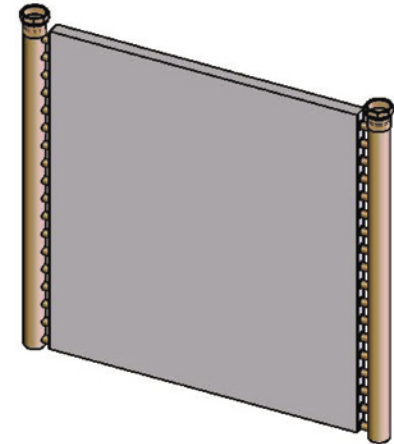

SPECIFICATIONS

Flow Range (GPM):9 - 72

Heat Rejection Range (BTU/Hr):

92,000 -160,000

Fitting Size:.....2" FPT

Material

Copper Tube:.....CDA122

Inner Tube:Al-3003

Inner Fin:Al - 1100

Outer Fin:Al - 1100

Fitting:.....Copper

Cooler Weight (lbs.)

Total Weight :.....38 lbs.

PERFORMANCE

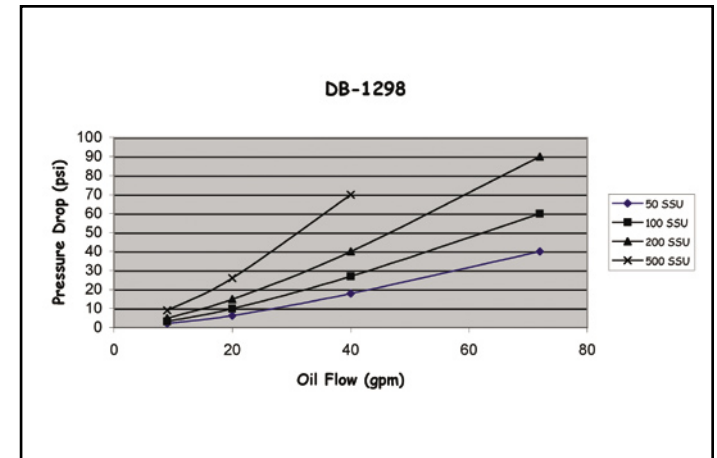
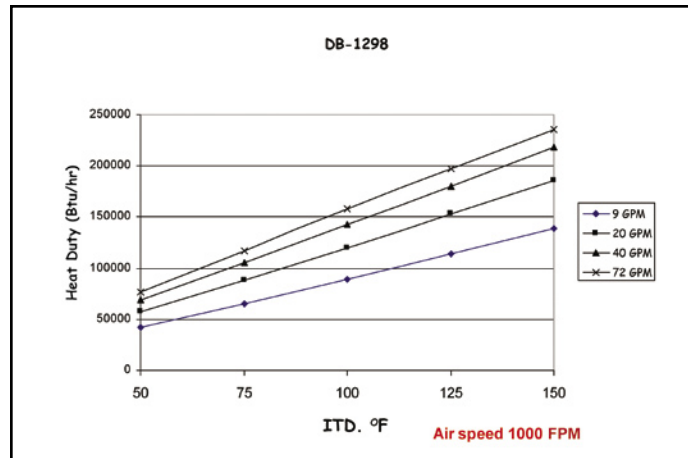

DIMENSIONS

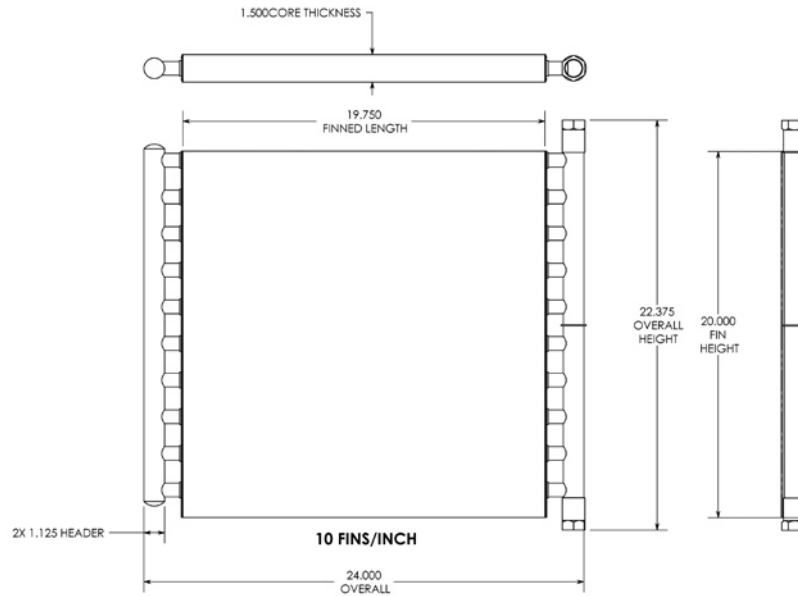

APPEARANCE

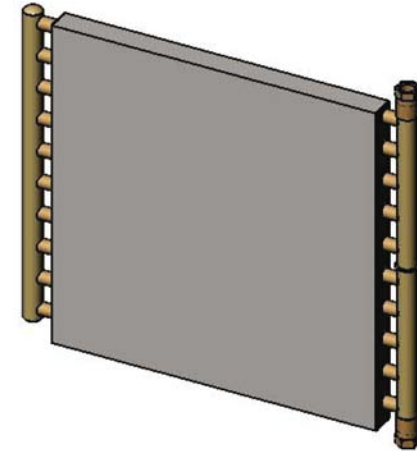

SPECIFICATIONS

Flow Range (GPM):2 - 12
 Heat Rejection Range (BTU/Hr):
 26,500 - 45,000
 Fitting Size:.....3/4" FPT

Material
 Copper Tube:.....CDA122
 Inner Tube:Al-3003
 Inner Fin:Al - 1100
 Outer Fin:Al - 1100
 Fitting:.....Copper

Cooler Weight (lbs.)
 Total Weight :.....12.5 lbs.

PERFORMANCE

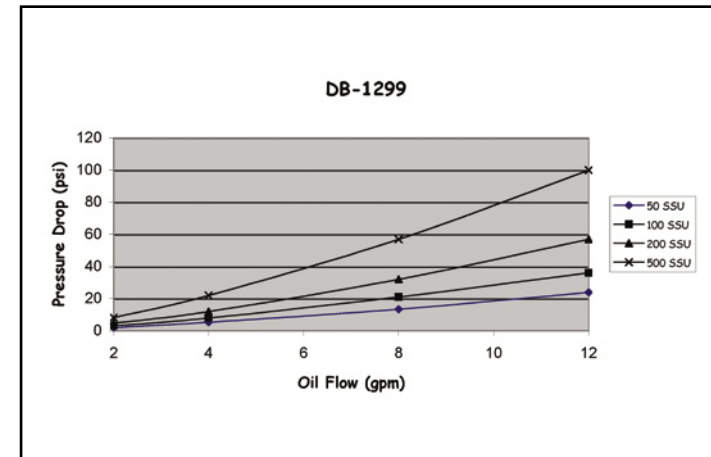
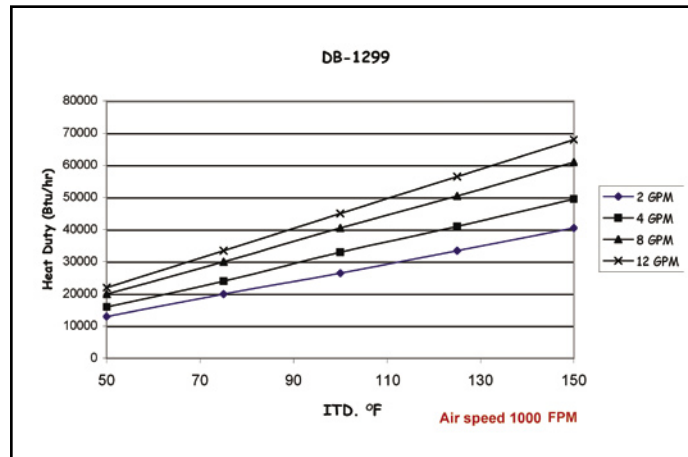

DIMENSIONS

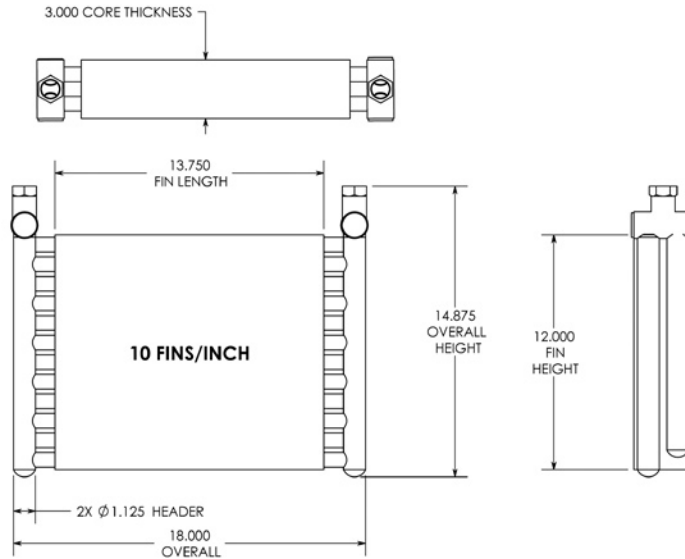

APPEARANCE

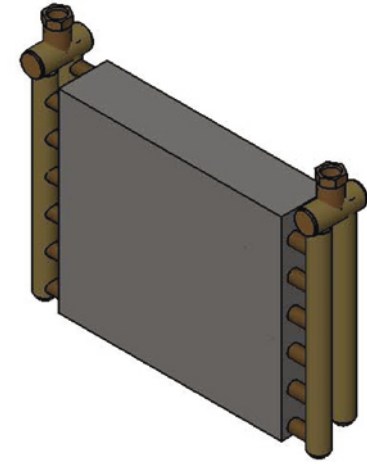

SPECIFICATIONS

Flow Range (GPM):6 - 20
 Heat Rejection Range (BTU/Hr):
 28,000 - 34,500
 Fitting Size:.....3/4" FPT

Material

Copper Tube:.....CDA122
 Inner Tube:Al-3003
 Inner Fin:Al - 1100
 Outer Fin:Al - 1100
 Fitting:.....Copper

Cooler Weight (lbs.)

Total Weight :.....12 lbs.

PERFORMANCE

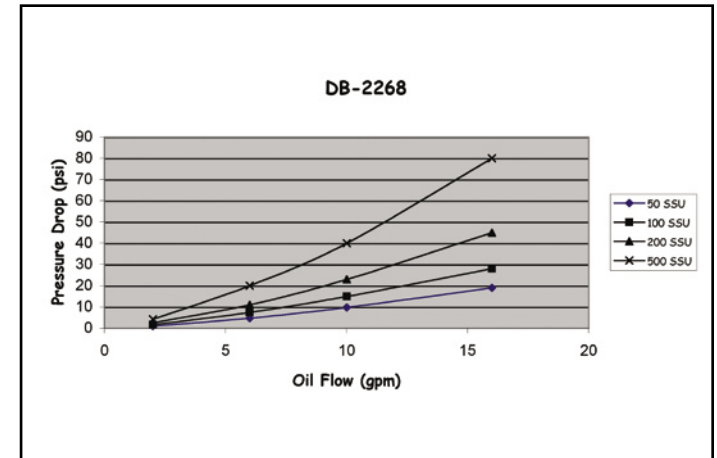
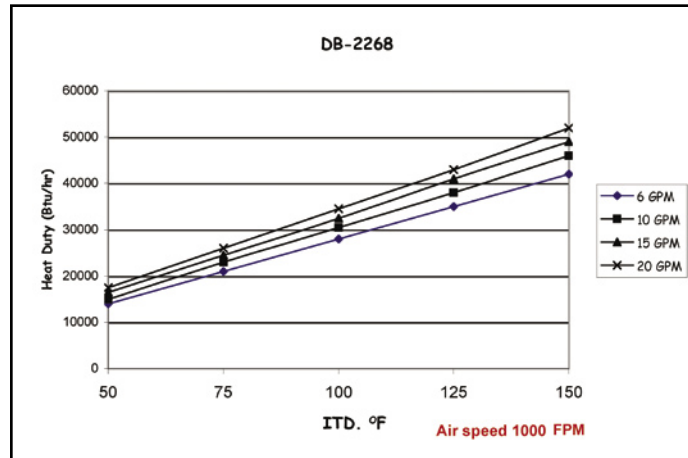

DIMENSIONS

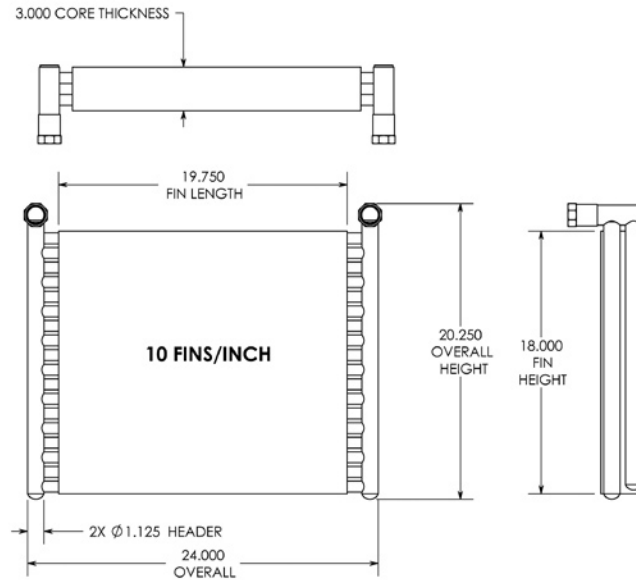

APPEARANCE

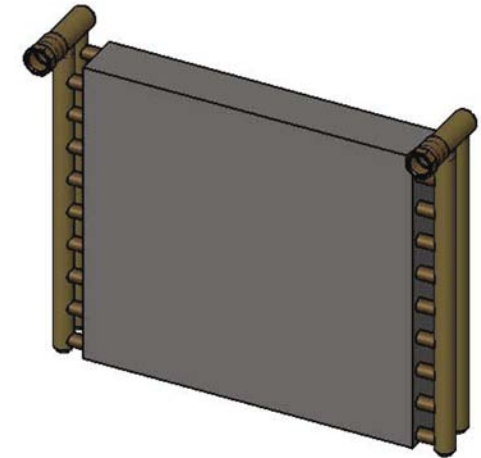

SPECIFICATIONS

Flow Range (GPM):9 - 30
 Heat Rejection Range (BTU/Hr):
 54,700 - 70,600
 Fitting Size:.....1" FPT
Material
 Copper Tube:.....CDA122
 Inner Tube:Al-3003
 Inner Fin:Al - 1100
 Outer Fin:Al - 1100
 Fitting:.....Copper
Cooler Weight (lbs.)
 Total Weight :.....23 lbs.

PERFORMANCE

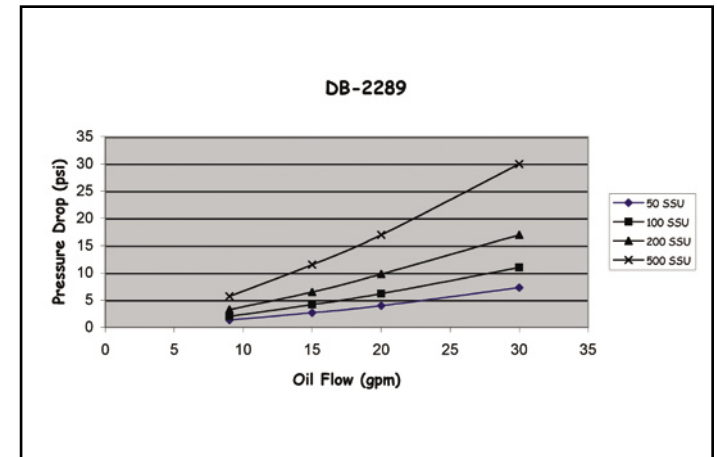
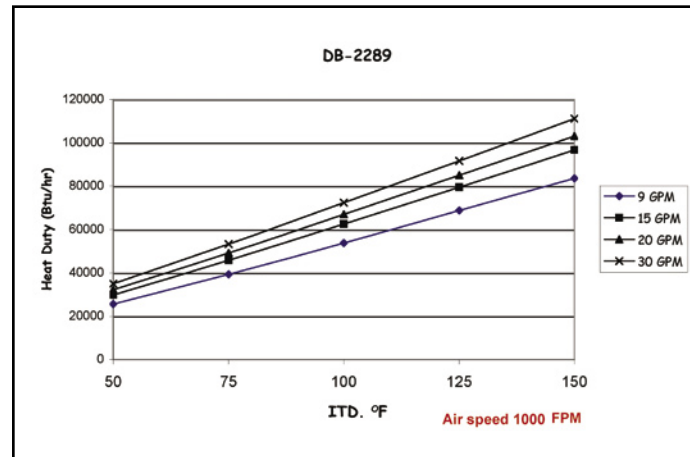

DIMENSIONS

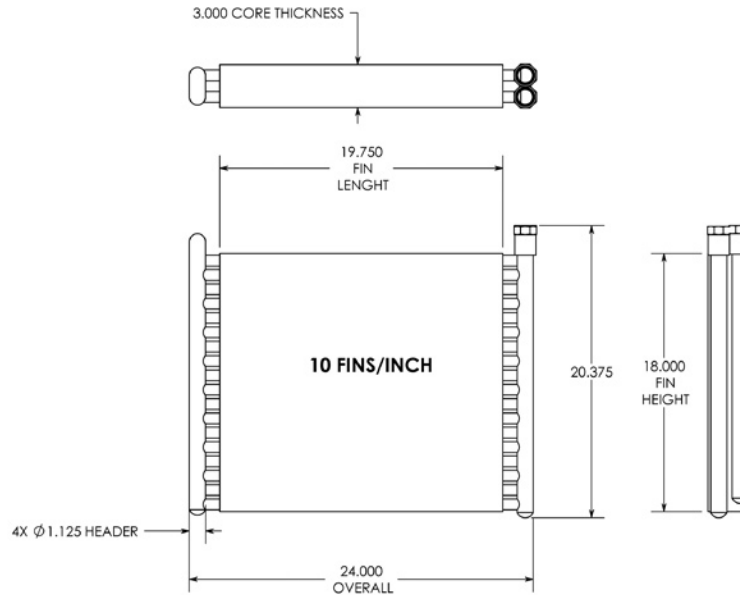

APPEARANCE

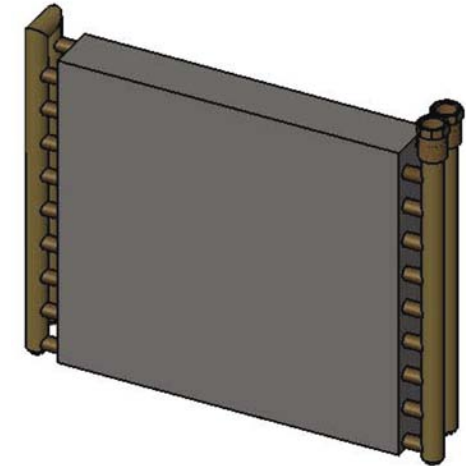

SPECIFICATIONS

Flow Range (GPM):5 - 15
 Heat Rejection Range (BTU/Hr):
 49,500 - 68,000
 Fitting Size:.....3/4" FPT

Material

Copper Tube:.....CDA122
 Inner Tube:Al-3003
 Inner Fin:Al - 1100
 Outer Fin:Al - 1100
 Fitting:.....Copper

Cooler Weight (lbs.)

Total Weight :.....21 lbs.

PERFORMANCE

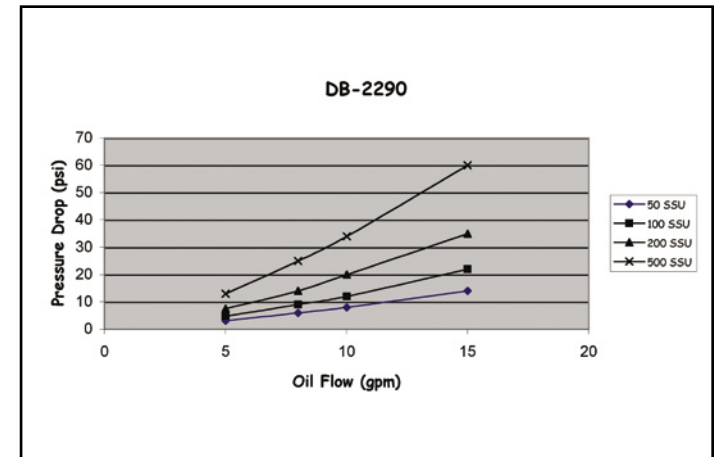
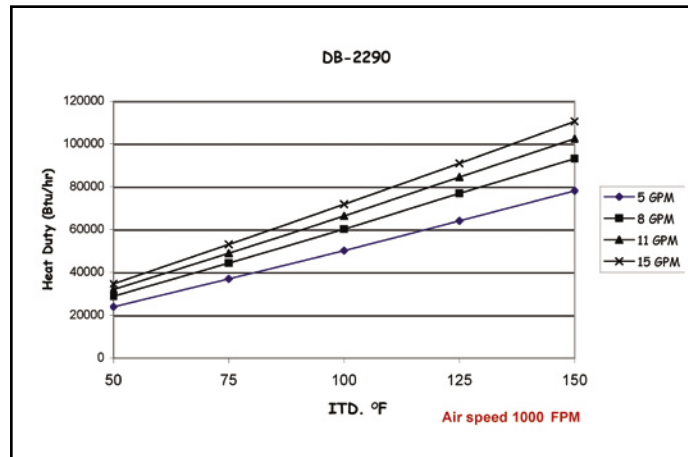

DIMENSIONS

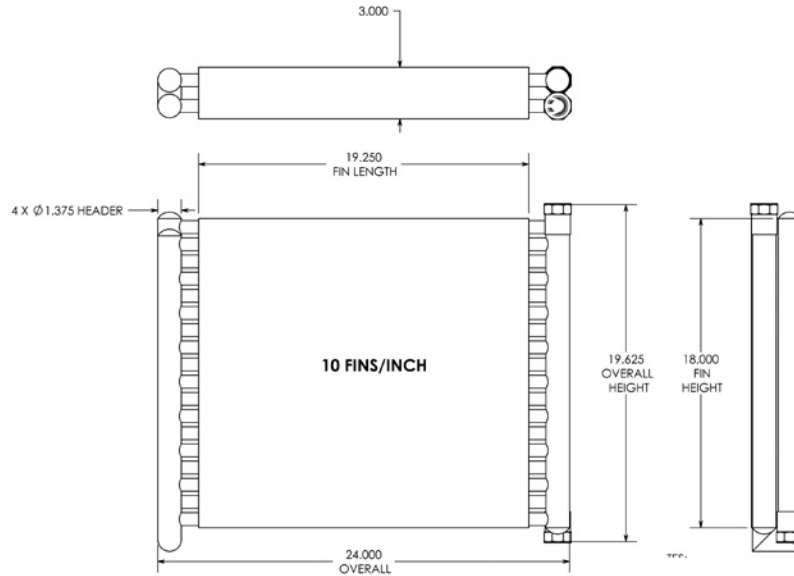

APPEARANCE

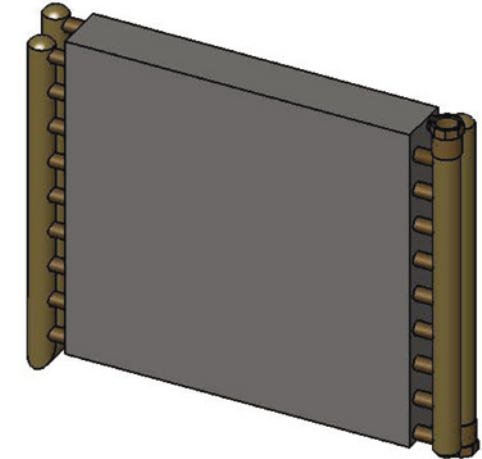

SPECIFICATIONS

Flow Range (GPM):5 - 30
 Heat Rejection Range (BTU/Hr):
 48,000 - 81,000
 Fitting Size:.....1" FPT
Material
 Copper Tube:.....CDA122
 Inner Tube:Al-3003
 Inner Fin:Al - 1100
 Outer Fin:Al - 1100
 Fitting:.....Copper
Cooler Weight (lbs.)
 Total Weight :.....23 lbs.

PERFORMANCE

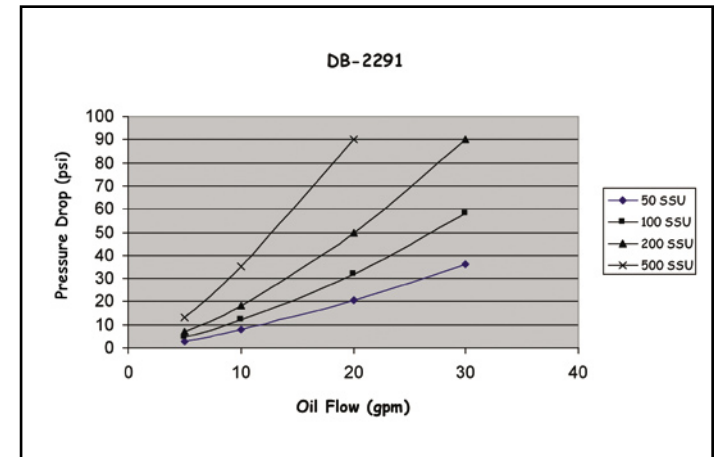
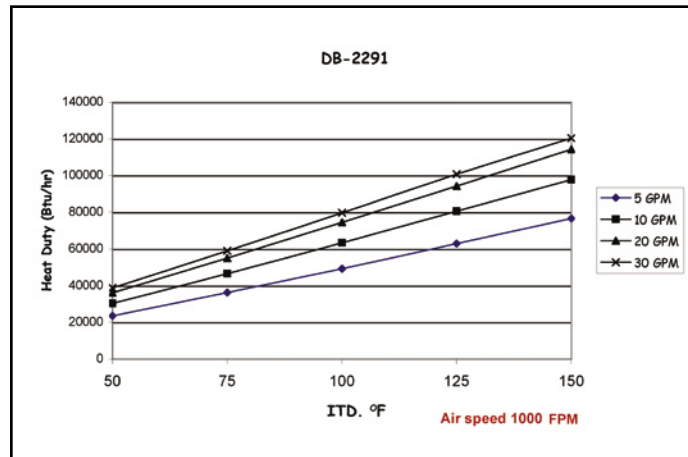

DIMENSIONS

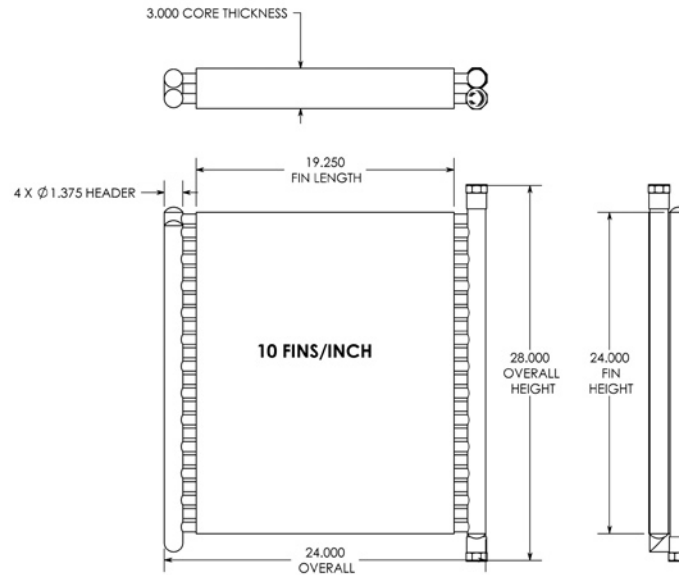

APPEARANCE

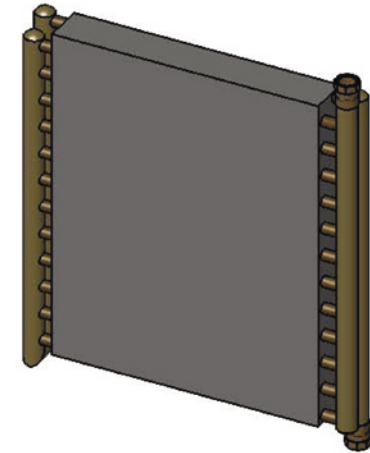

SPECIFICATIONS

Flow Range (GPM):6 - 30
 Heat Rejection Range (BTU/Hr):
 62,000 - 99,000
 Fitting Size:.....1" FPT
Material
 Copper Tube:.....CDA122
 Inner Tube:Al-3003
 Inner Fin:Al - 1100
 Outer Fin:Al - 1100
 Fitting:.....Copper
Cooler Weight (lbs.)
 Total Weight :.....27 lbs.

PERFORMANCE

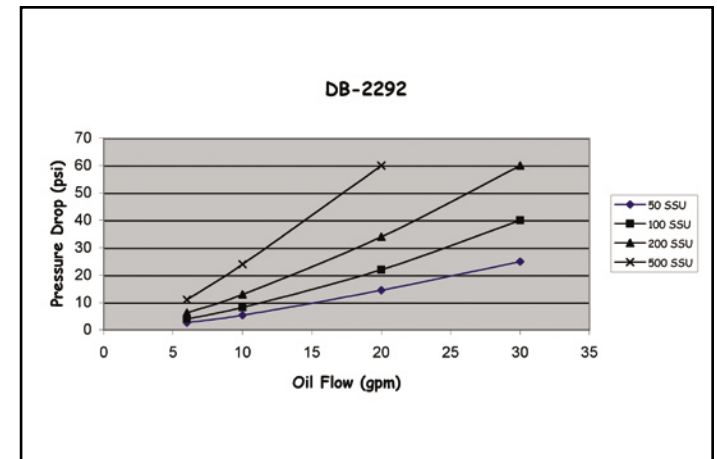
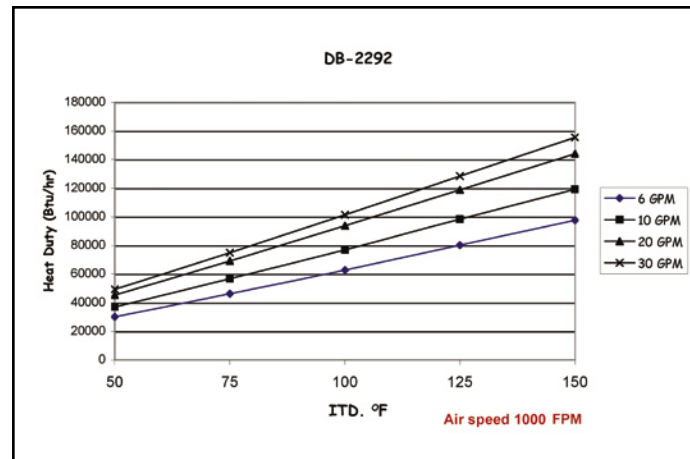

DIMENSIONS

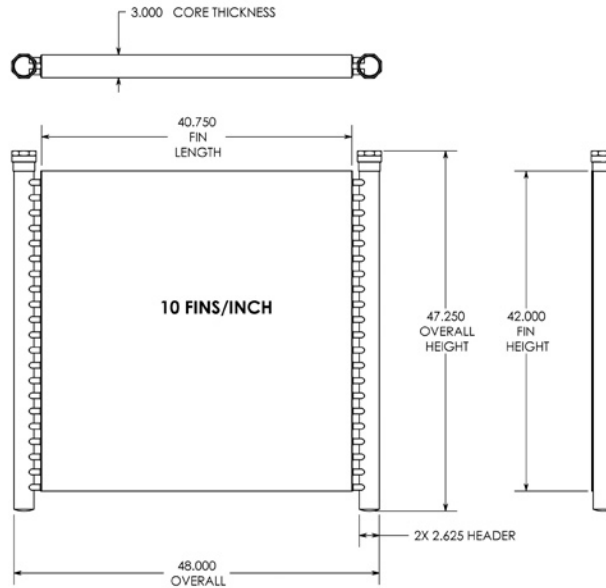

APPEARANCE

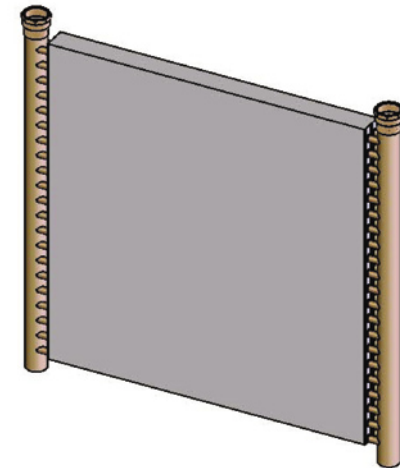

SPECIFICATIONS

Flow Range (GPM):20 - 125
Heat Rejection Range (BTU/Hr):

Fitting Size:.....2" FPT

Material

Copper Tube:.....CDA122

Inner Tube:Al-3003

Inner Fin:Al - 1100

Outer Fin:Al - 1100

Fitting:.....Copper

Cooler Weight (lbs.)

Total Weight :.....102 lbs.

PERFORMANCE

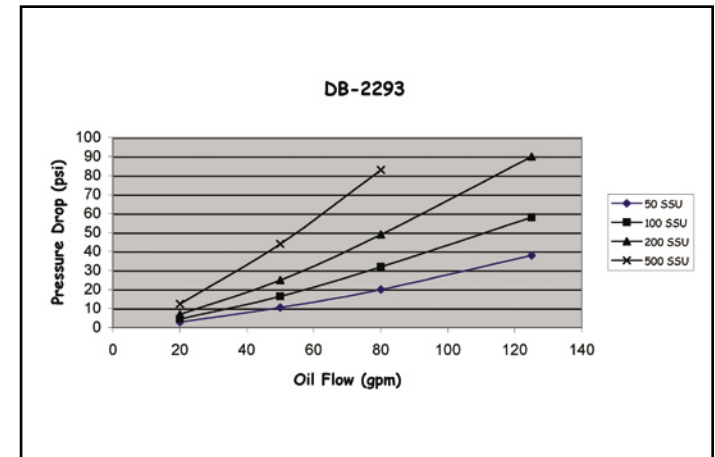
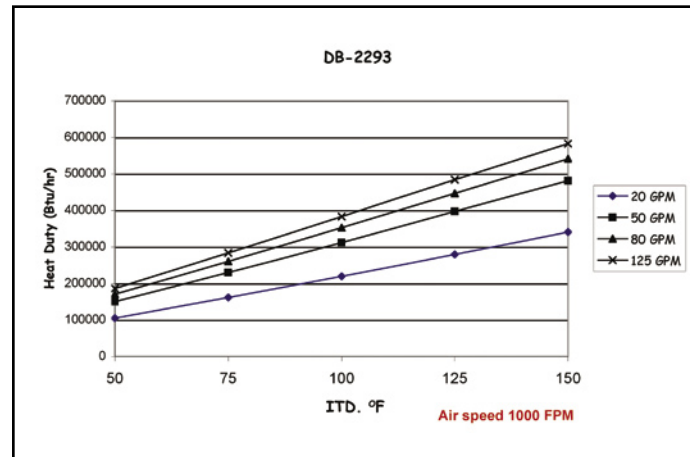

DIMENSIONS

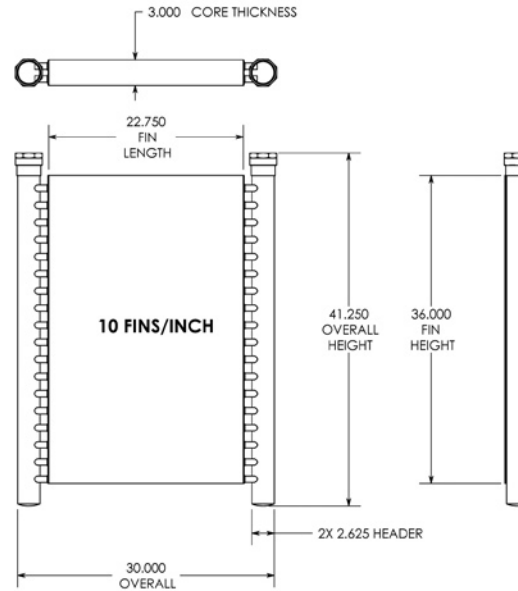

APPEARANCE

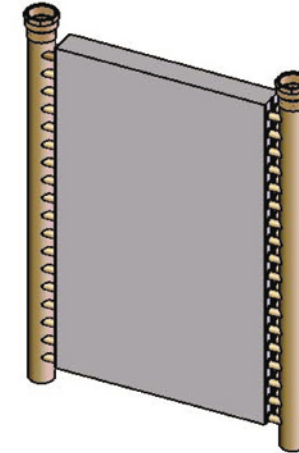

SPECIFICATIONS

Flow Range (GPM):20 - 125
 Heat Rejection Range (BTU/Hr):
 130,000-200,000
 Fitting Size:.....

Material

Copper Tube:.....CDA122
 Inner Tube:Al-3003
 Inner Fin:Al - 1100
 Outer Fin:Al - 1100
 Fitting:.....Copper

Cooler Weight (lbs.)

Total Weight :.....51 lbs.

PERFORMANCE

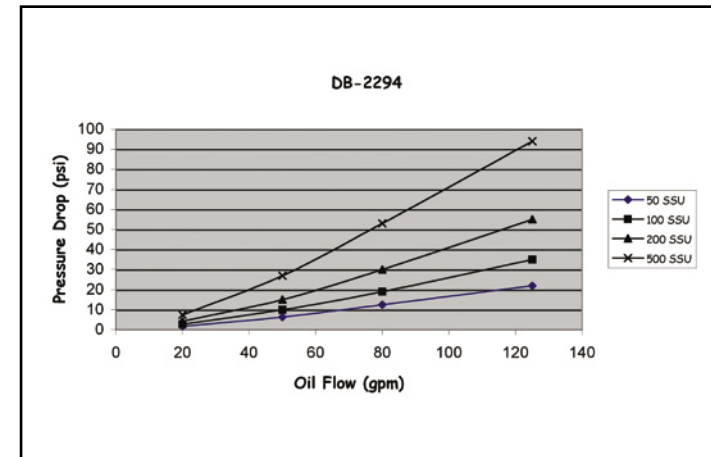
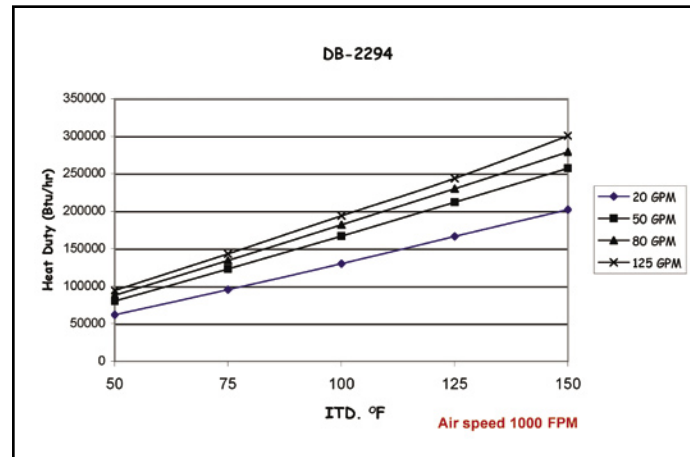

DIMENSIONS

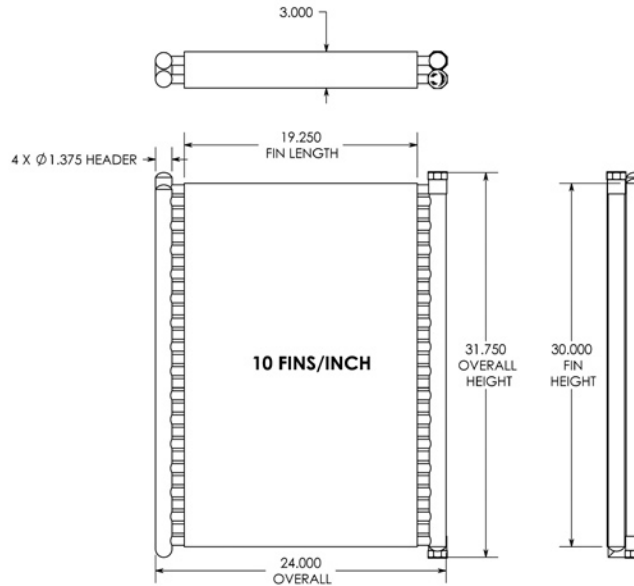

APPEARANCE

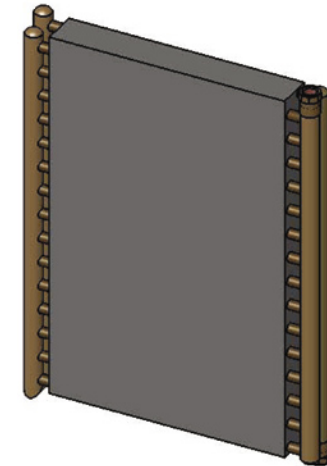

SPECIFICATIONS

Flow Range (GPM):6 - 30
 Heat Rejection Range (BTU/Hr):
 73,000 - 116,000
 Fitting Size:.....1" FPT
Material
 Copper Tube:.....CDA122
 Inner Tube:Al-3003
 Inner Fin:Al - 1100
 Outer Fin:Al - 1100
 Fitting:.....Copper
Cooler Weight (lbs.)
 Total Weight :.....38 lbs.

PERFORMANCE

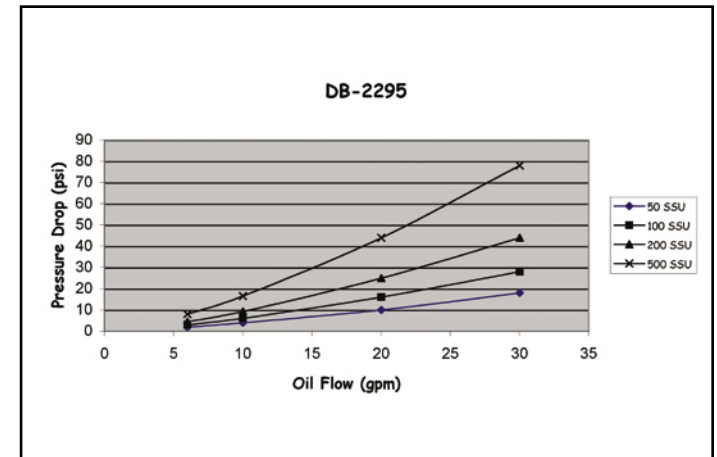
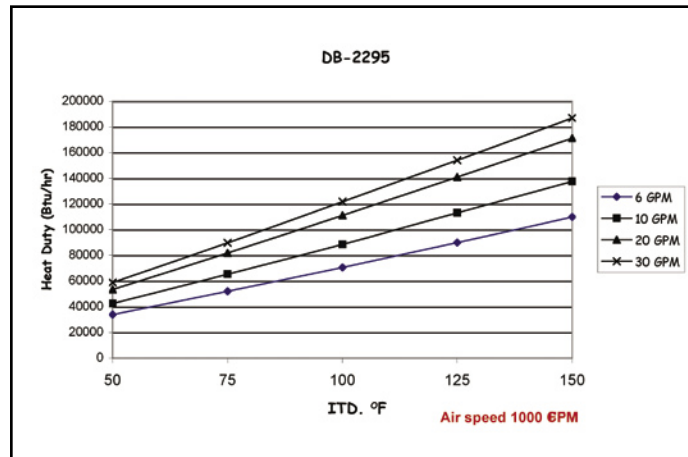

DIMENSIONS

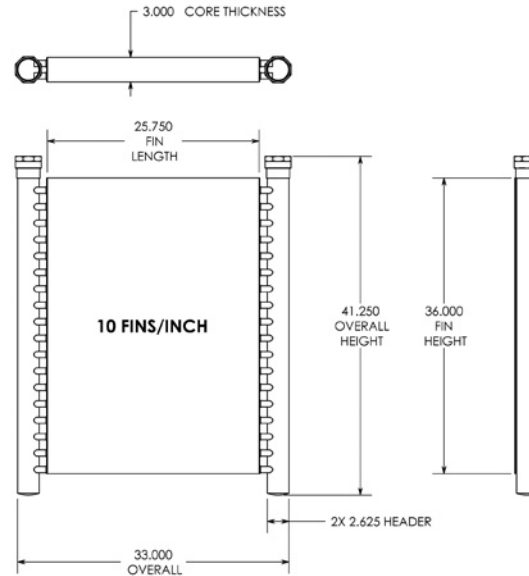

APPEARANCE

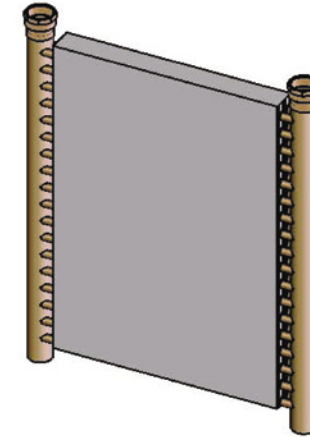

SPECIFICATIONS

Flow Range (GPM):20 - 125
 Heat Rejection Range (BTU/Hr):
 134,000 - 222,000

Fitting Size:.....2" FPT

Material

Copper Tube:.....CDA122

Inner Tube:Al-3003

Inner Fin:Al - 1100

Outer Fin:Al - 1100

Fitting:.....Copper

Cooler Weight (lbs.)

Total Weight :.....56 lbs.

PERFORMANCE

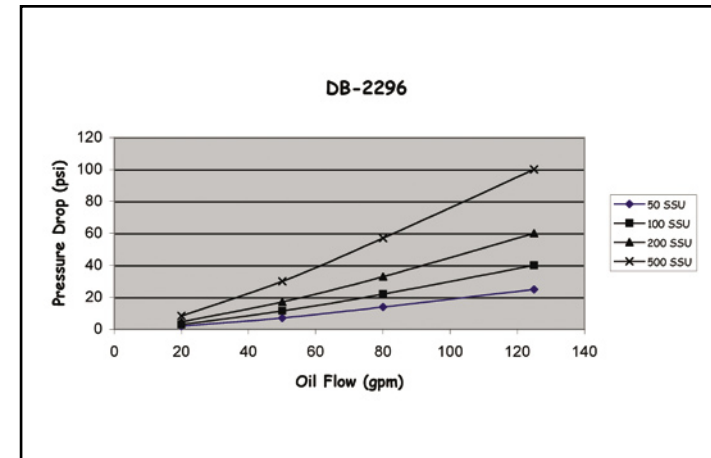
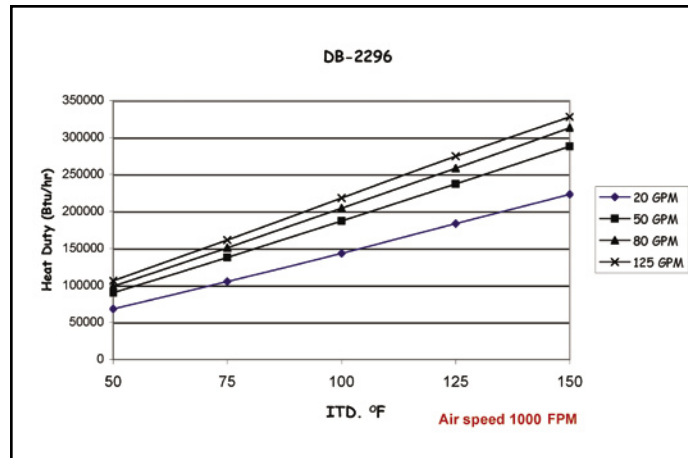

DIMENSIONS

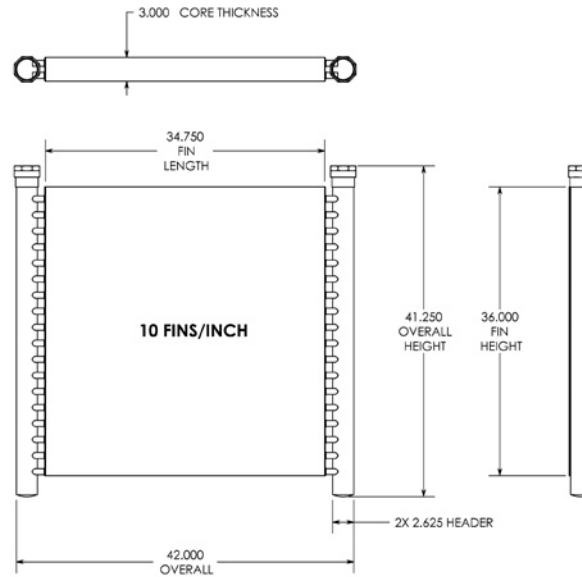

APPEARANCE

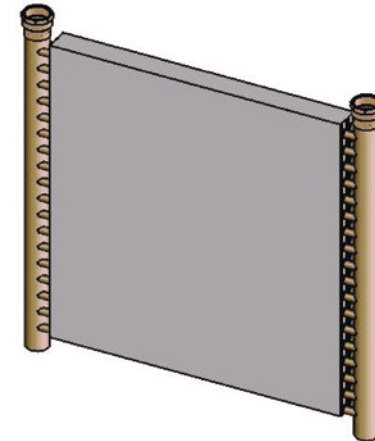

SPECIFICATIONS

Flow Range (GPM):20 - 125
 Heat Rejection Range (BTU/Hr):
 176,000 - 300,000

Fitting Size:.....2" FPT

Material

Copper Tube:.....CDA122

Inner Tube:Al-3003

Inner Fin:Al - 1100

Outer Fin:Al - 1100

Fitting:.....Copper /

Brass

Cooler Weight (lbs.)

Total Weight :75 lbs.

PERFORMANCE

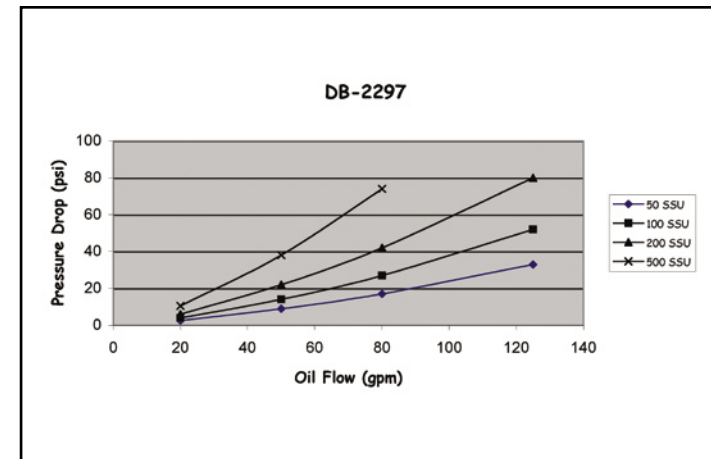
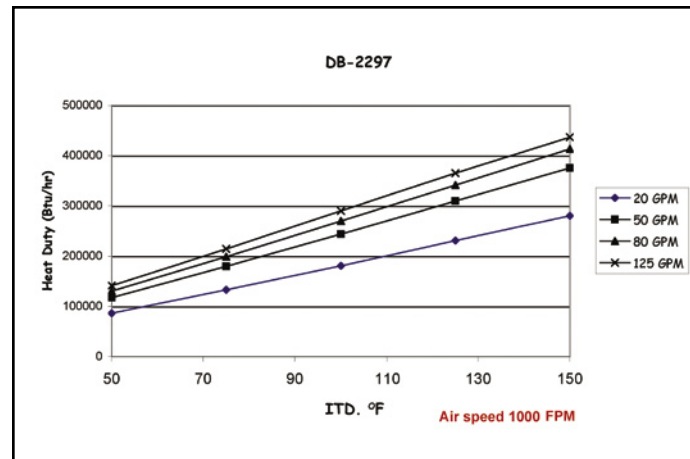

DIMENSIONS

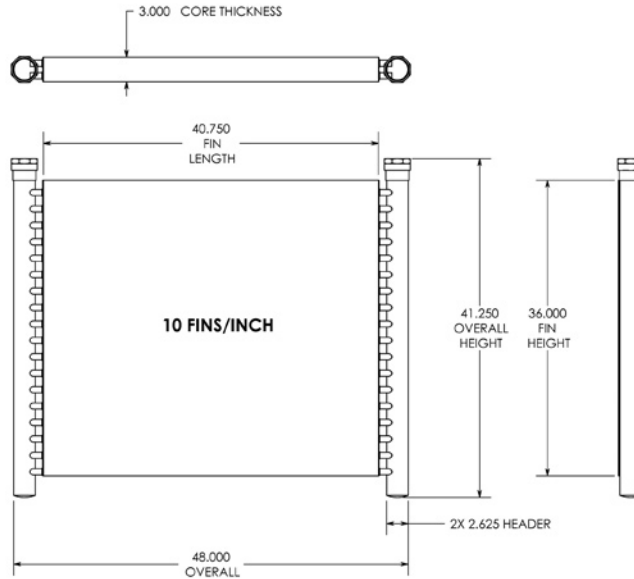

APPEARANCE

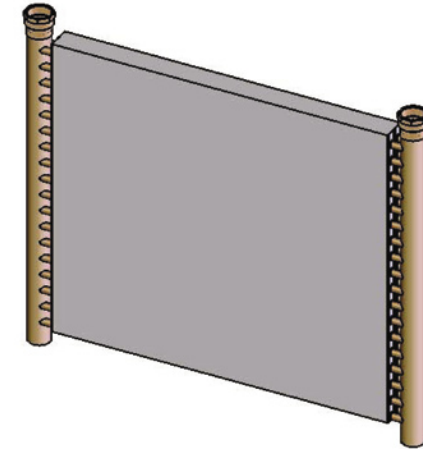

SPECIFICATIONS

Flow Range (GPM):20 - 125
 Heat Rejection Range (BTU/Hr):
 214,000 - 360,000
 Fitting Size:.....2" FPT

Material

Copper Tube:.....CDA122
 Inner Tube:Al-3003
 Inner Fin:Al - 1100
 Outer Fin:Al - 1100
 Fitting:.....Copper

Cooler Weight (lbs.)

Total Weight :.....88 lbs.

PERFORMANCE

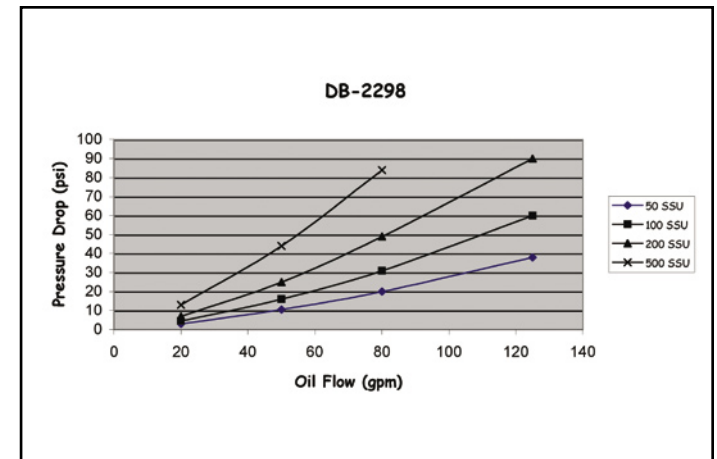
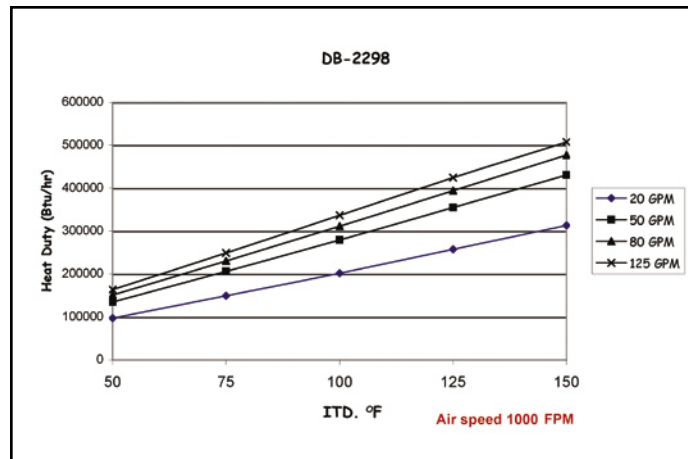

DIMENSIONS

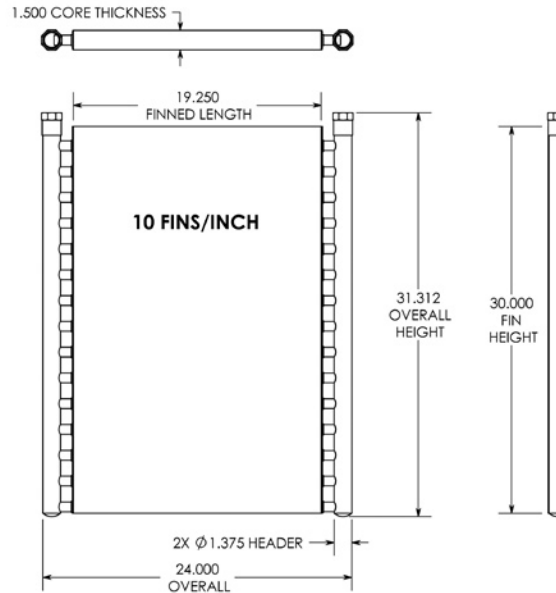

APPEARANCE

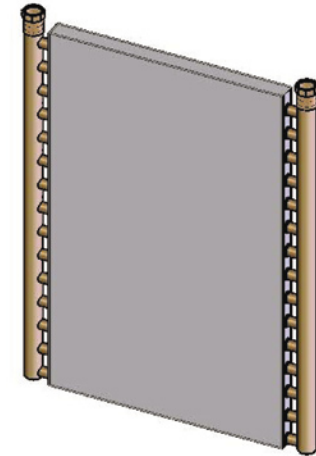

SPECIFICATIONS

Flow Range (GPM):5 - 30
 Heat Rejection Range (BTU/Hr):
 47,000 - 68,000
 Fitting Size:.....1" FPT
Material
 Copper Tube:.....CDA122
 Inner Tube:Al-3003
 Inner Fin:Al - 1100
 Outer Fin:Al - 1100
 Fitting:.....Copper
Cooler Weight (lbs.)
 Total Weight :.....19 lbs.

PERFORMANCE

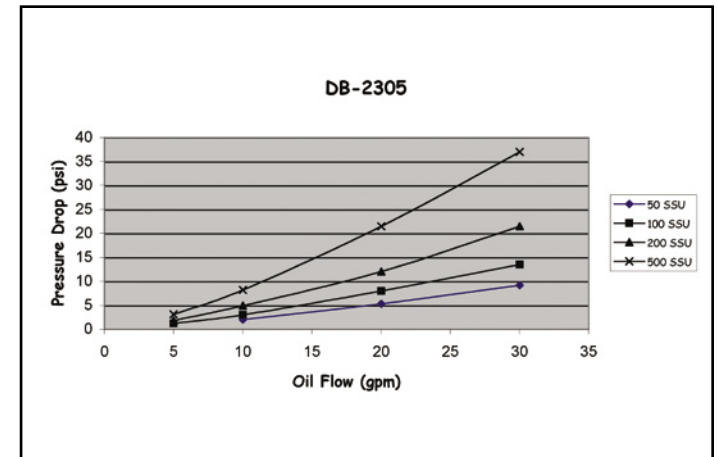
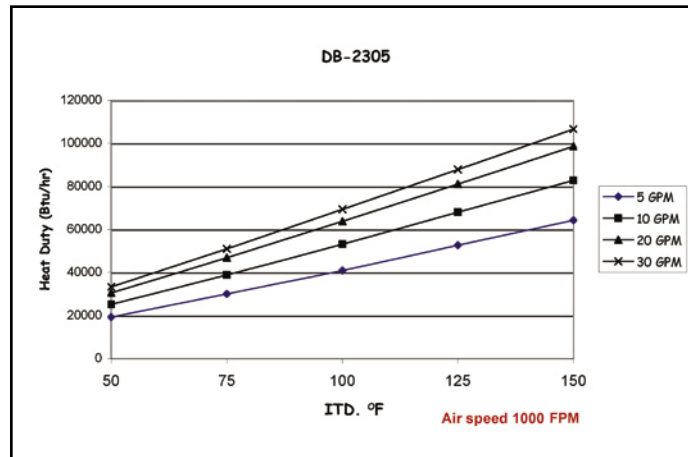

DIMENSIONS

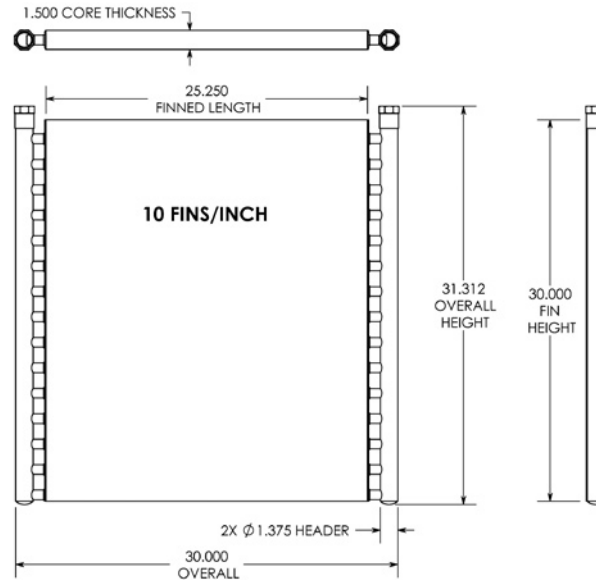

APPEARANCE

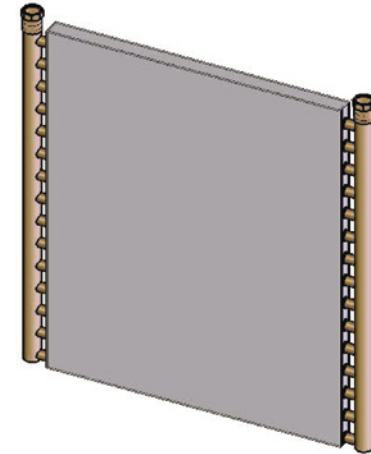

SPECIFICATIONS

Flow Range (GPM):5 - 30
 Heat Rejection Range (BTU/Hr):
 56,000 - 86,000
 Fitting Size:.....1" FPT

Material
 Copper Tube:.....CDA122
 Inner Tube:Al-3003
 Inner Fin:Al - 1100
 Outer Fin:Al - 1100
 Fitting:.....Copper

Cooler Weight (lbs.)
 Total Weight :.....24 lbs.

PERFORMANCE

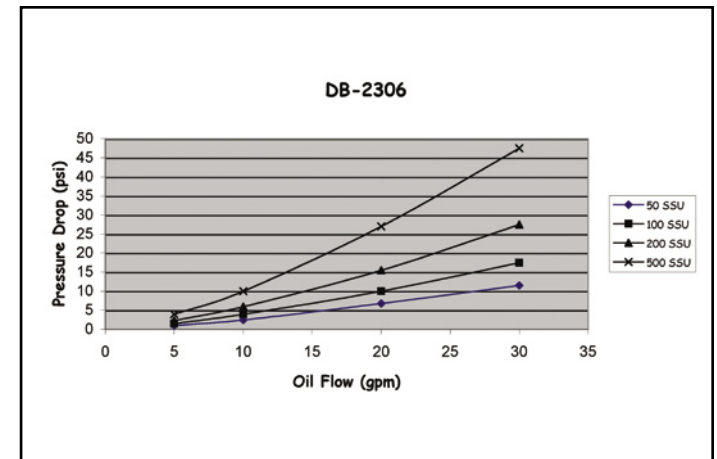
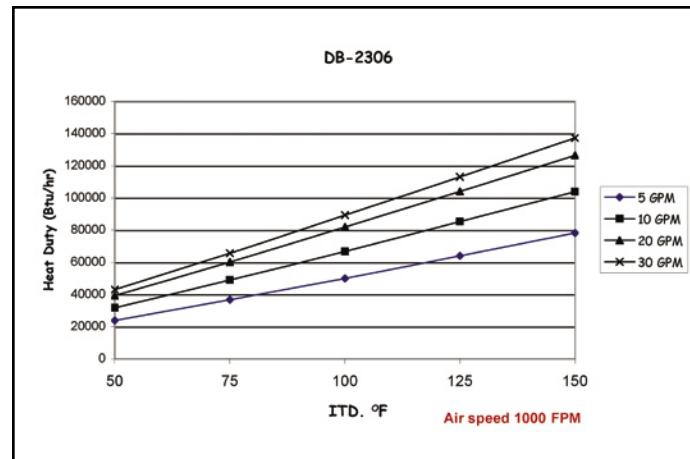

DIMENSIONS

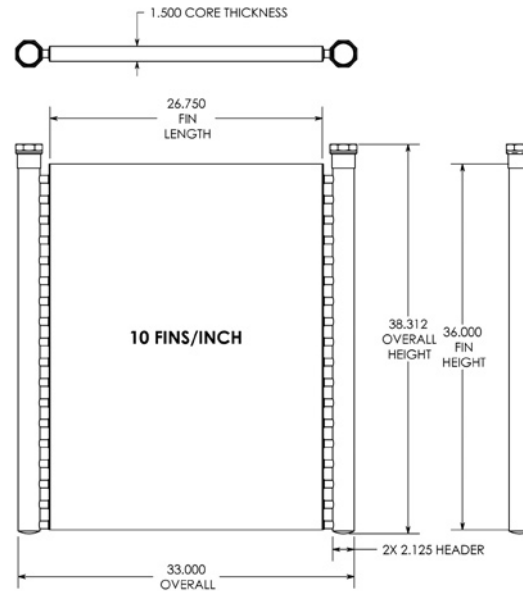

APPEARANCE

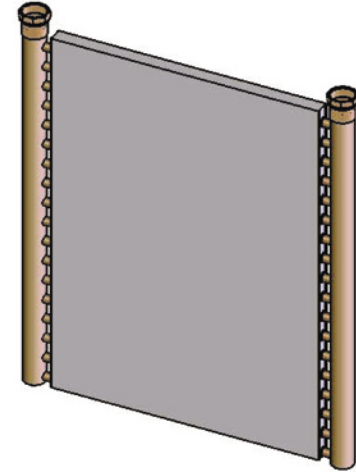

SPECIFICATIONS

Flow Range (GPM):9 - 72
 Heat Rejection Range (BTU/Hr):
 76,000 -129,000
 Fitting Size:.....2" FPT
Material
 Copper Tube:.....CDA122
 Inner Tube:Al-3003
 Inner Fin:Al - 1100
 Outer Fin:Al - 1100
 Fitting:.....Copper
Cooler Weight (lbs.)
 Total Weight :.....33 lbs.

PERFORMANCE

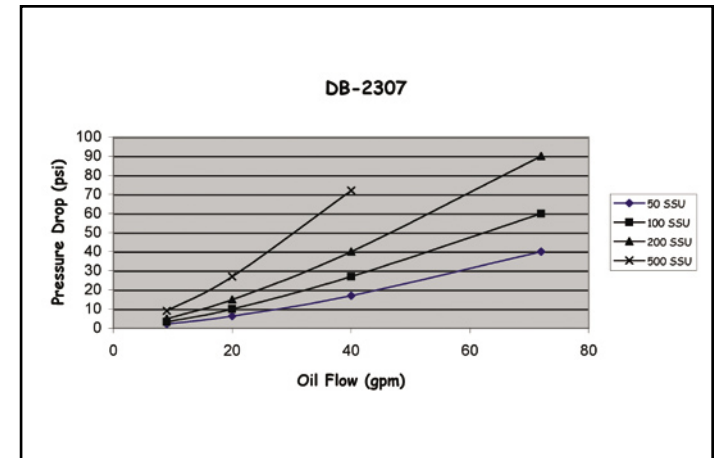
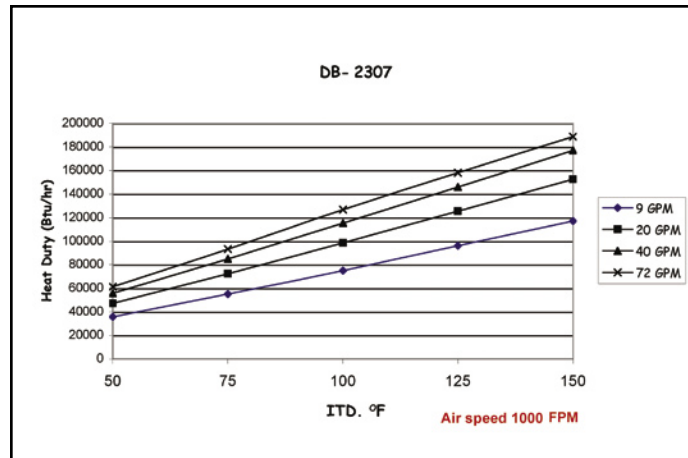

DIMENSIONS

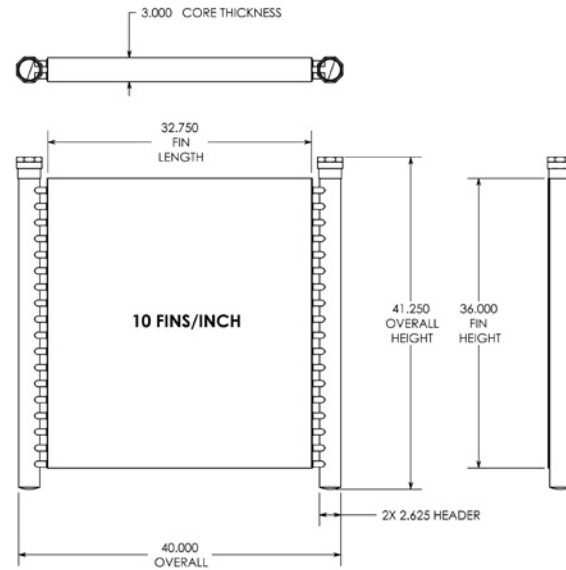

APPEARANCE

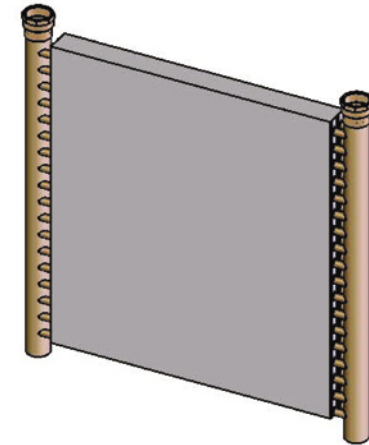

SPECIFICATIONS

Flow Range (GPM):20 - 125
 Heat Rejection Range (BTU/Hr):
 170,000 - 282,000

Fitting Size:.....2" FPT

Material

Copper Tube:.....CDA122

Inner Tube:Al-3003

Inner Fin:Al - 1100

Outer Fin:Al - 1100

Fitting:.....Copper

Cooler Weight (lbs.)

Total Weight :.....72 lbs.

PERFORMANCE

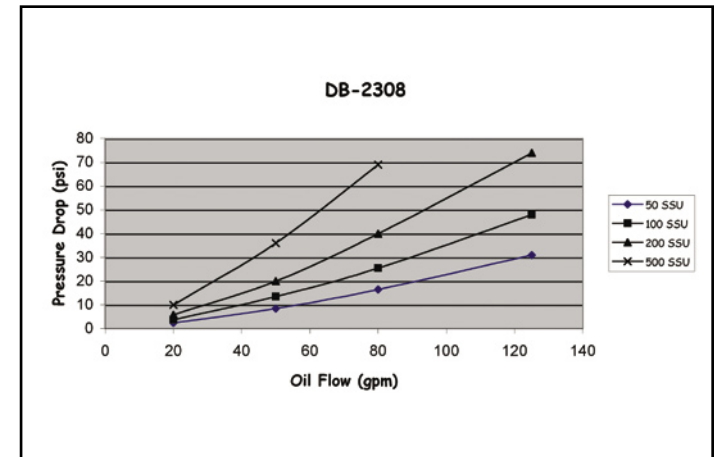
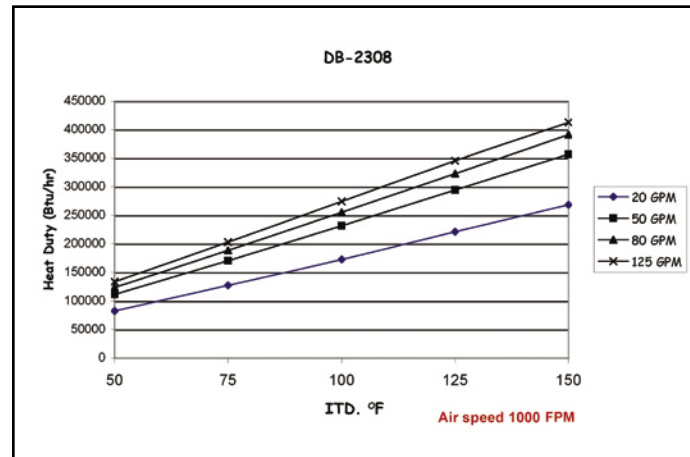

DIMENSIONS

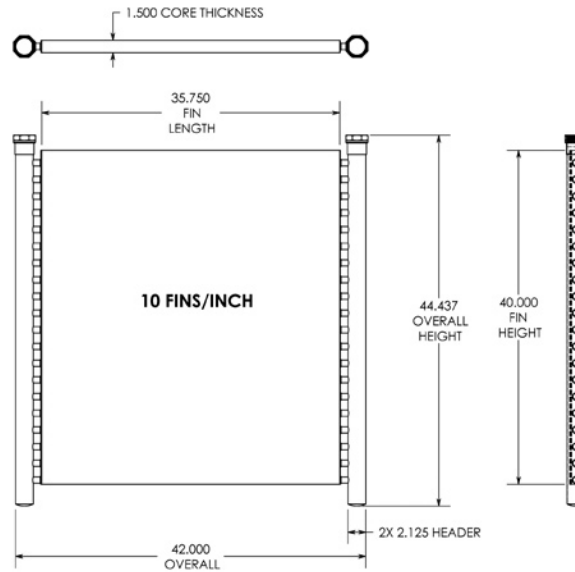

APPEARANCE

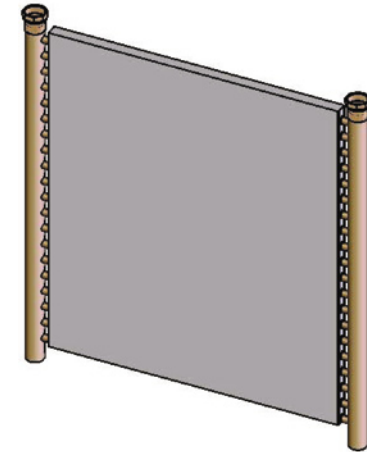

SPECIFICATIONS

Flow Range (GPM):10 - 80
 Heat Rejection Range (BTU/Hr):
 106,000 - 192,000

Fitting Size:.....2" FPT

Material

Copper Tube:.....CDA122

Inner Tube:Al-3003

Inner Fin:Al - 1100

Outer Fin:Al - 1100

Fitting:.....Copper

Cooler Weight (lbs.)

Total Weight :.....44 lbs.

PERFORMANCE

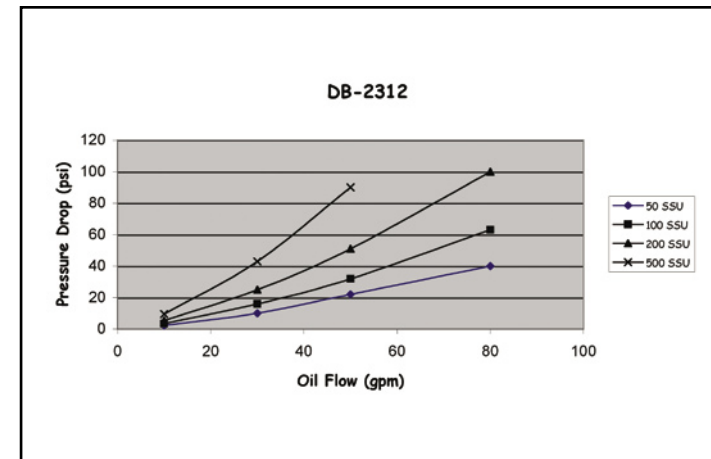
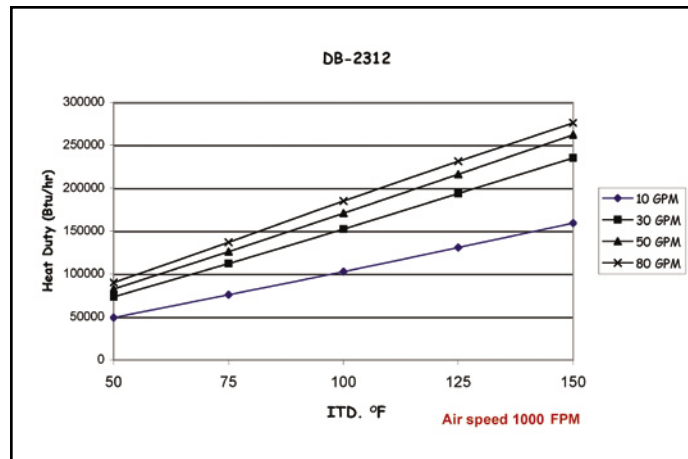

DB-183

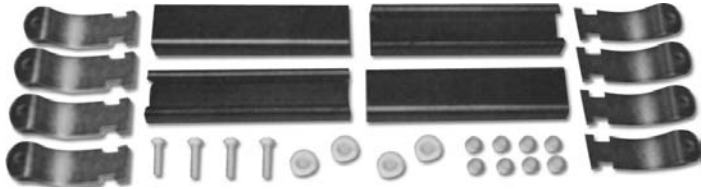

DB-515A



DB-114

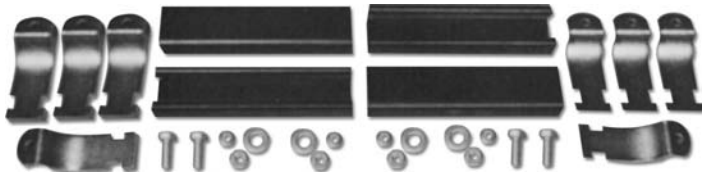

DB-515B

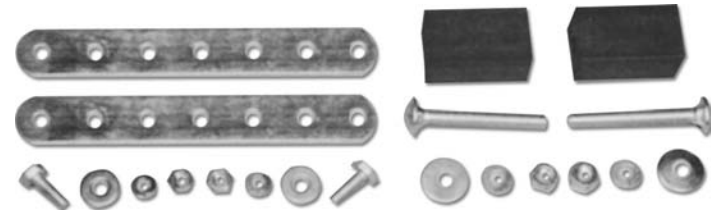

INNER-LOK™

Thermal Dynamics developed the Inner-Lok to help isolate our heat exchangers from vibration. The resilient elastomer block expands under compression, securing it to the heat exchanger's header tubes, as shown. Inner-Lok, supplied in our DB-515-A and 515-B mounting kits, also reduces torsional loads which might be applied to the heat exchanger due to its resiliency.

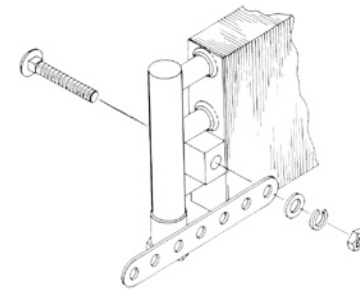
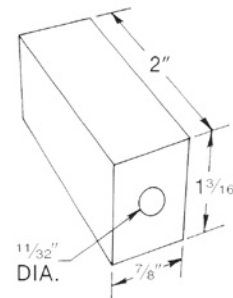

PRESSURE CHECK VALVES

Thermal Dynamics offers this simple, low-cost pressure check valve to control high backpressure resulting from cold fluid temperatures and other operating conditions. Easily installed in the heat exchanger circuit, the valve prevents high backpressure, protecting the fluid cooler and hydraulic system. It's low cost and simple, effective design make the Thermal Dynamics Pressure Check Valve an ideal in-line check valve for a variety of applications.

- Controls high backpressure created by cold fluid
- Easily installed across heat exchangers
- Low cost valves designed specially for low pressure rating applications.

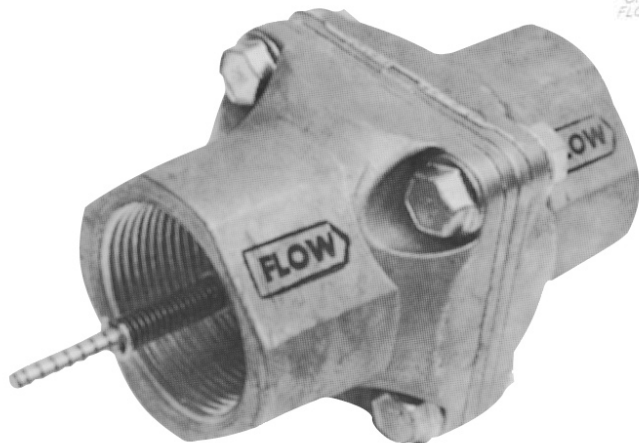
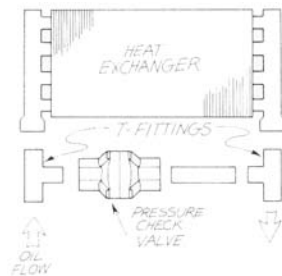

THERMAL BY-PASS VALVES

Thermal Dynamics By-Pass Valves are temperature responsive to modulate return line oil between the reservoir and the heat exchanger. In addition, an integral relief valve protects against excessive inlet pressures to the heat exchanger. Relief pressure settings available are 25 and 50 psi. Shift temperatures available are 100°F and 160°F.

- Diverts flow from heat exchanger to reservoir based on temperature
- Provides automatic pressure relief
- Ideal for hydrostatic drive circuits due to fast warm-up, controlled fluid temps and low return-line backpressure

